

/ Descriptions

SOT-23 PNP

/ Features

2SC5344S

/ Applications

/ Equivalent Circuit

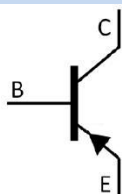

/ Pinning



/ h_{FE} Classifications & Marking

	~	~

/ Absolute Maximum Ratings(Ta=25)

/ Electrical Characteristics(Ta=25)

		μ				
		μ				
						μ
						μ

/ Electrical Characteristic Curve

Pc-Ta

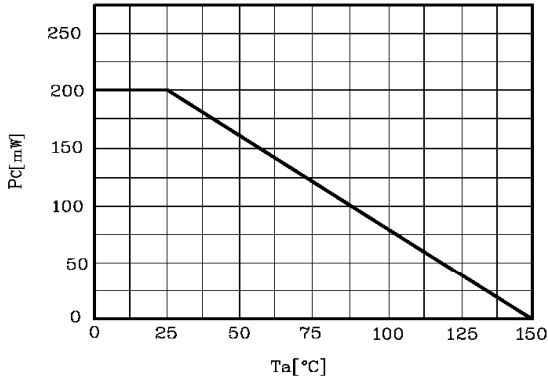

IC - V_{BE}

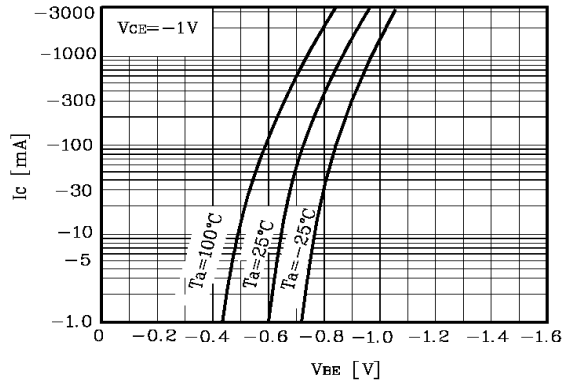

I_C - V_{CE}

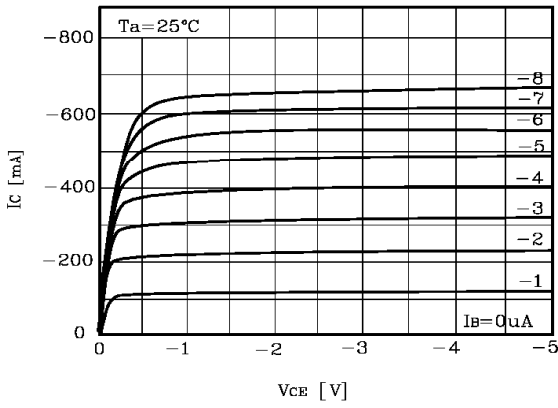

h_{FE} - I_C

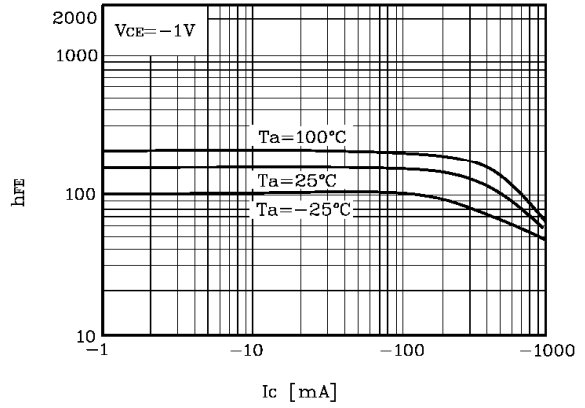

V_{CE(SAT)} - I_C

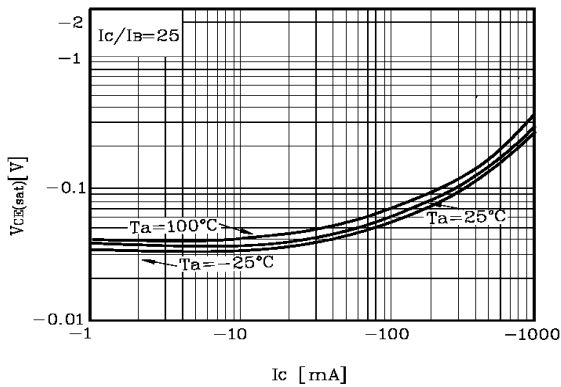

/ Package Dimensions

SOT-23

单位: mm

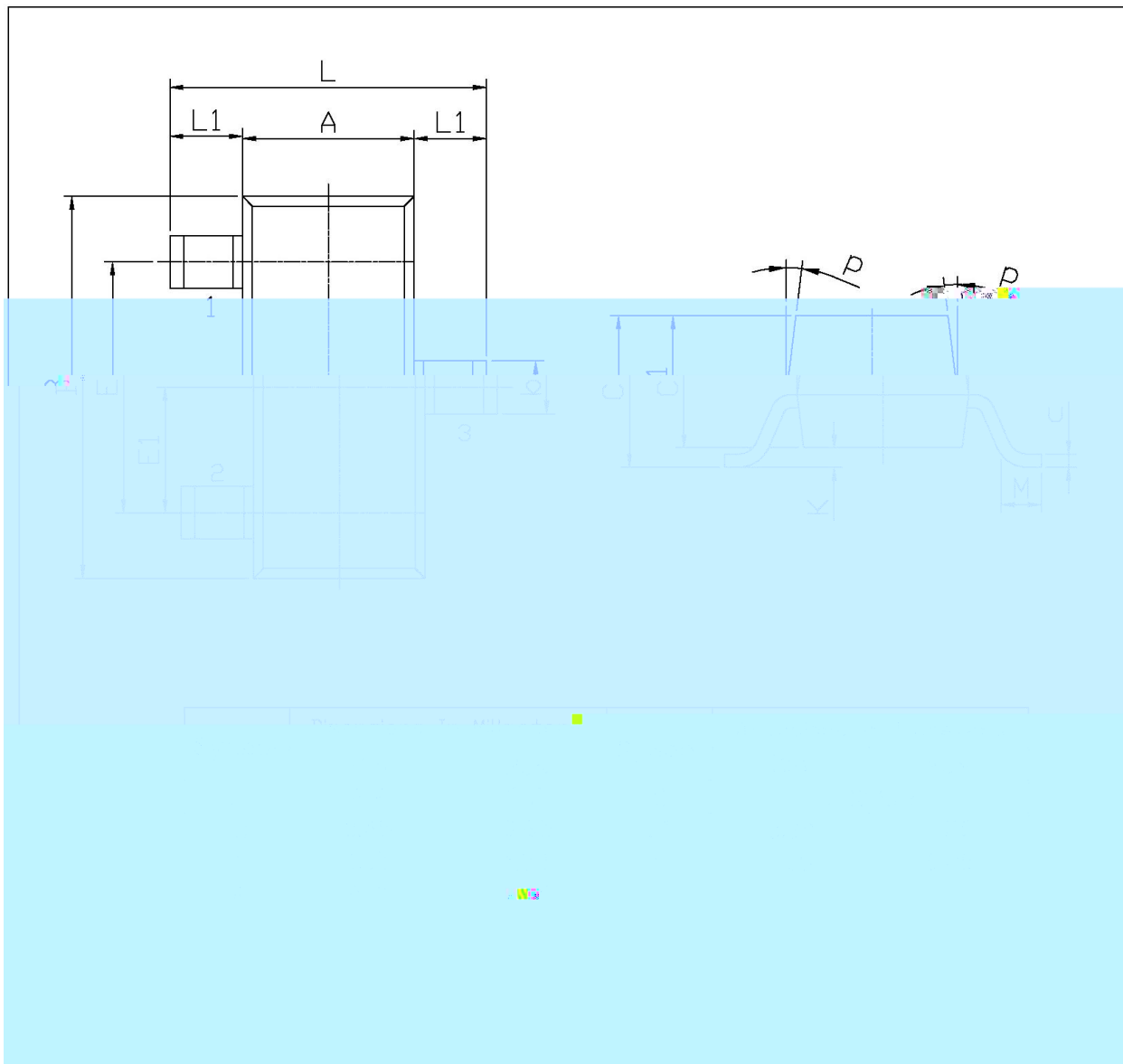

/ Marking Instructions

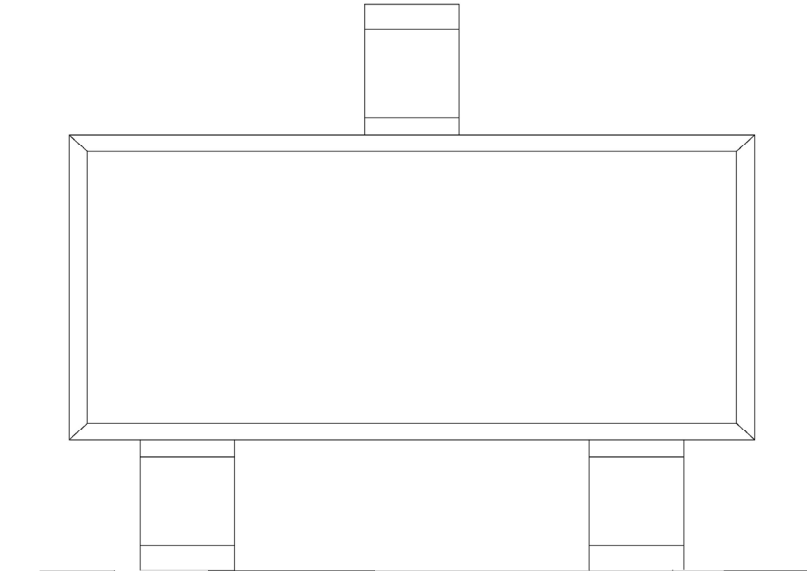

H
EA
O:

() /

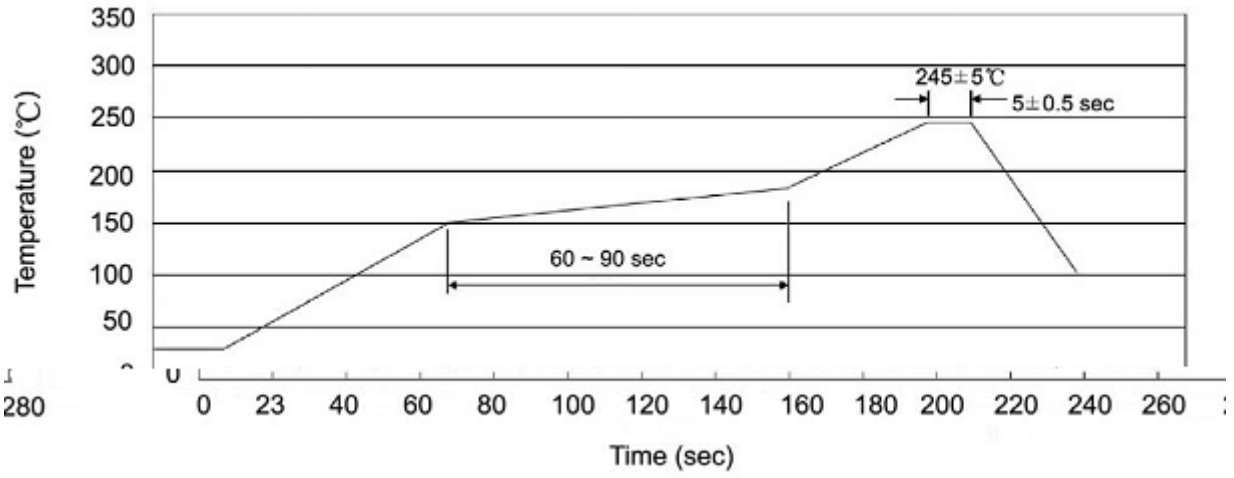

± ± ± ±

/ Resistance to Soldering Heat Test Conditions

± ±

/ Packaging SPEC.

包装数量

包装尺寸 :