

/ Descriptions

/ Features

/ Applications

/ Equivalent Circuit

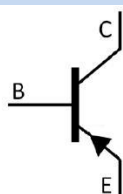

/ Pinning

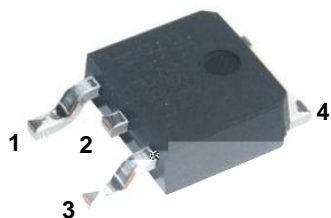

/  $h_{FE}$  Classifications & Marking

	~	~	~

**/ Absolute Maximum Ratings(Ta=25 )**

		°C	
			~

**/ Electrical Characteristics(Ta=25 )**

		μ				
		μ				
						μ
						μ

/ Electrical Characteristic Curve

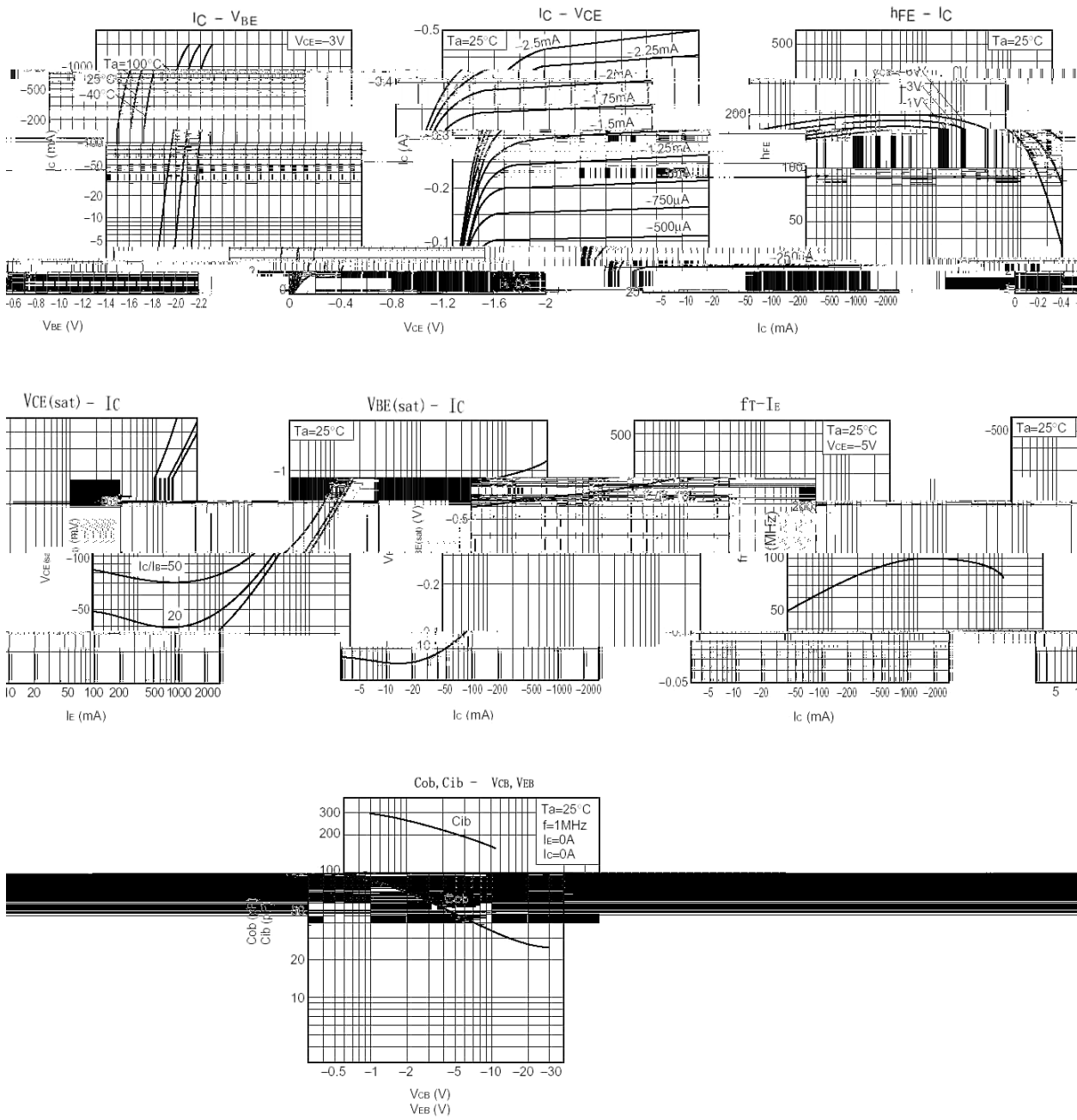

/ Package Dimensions

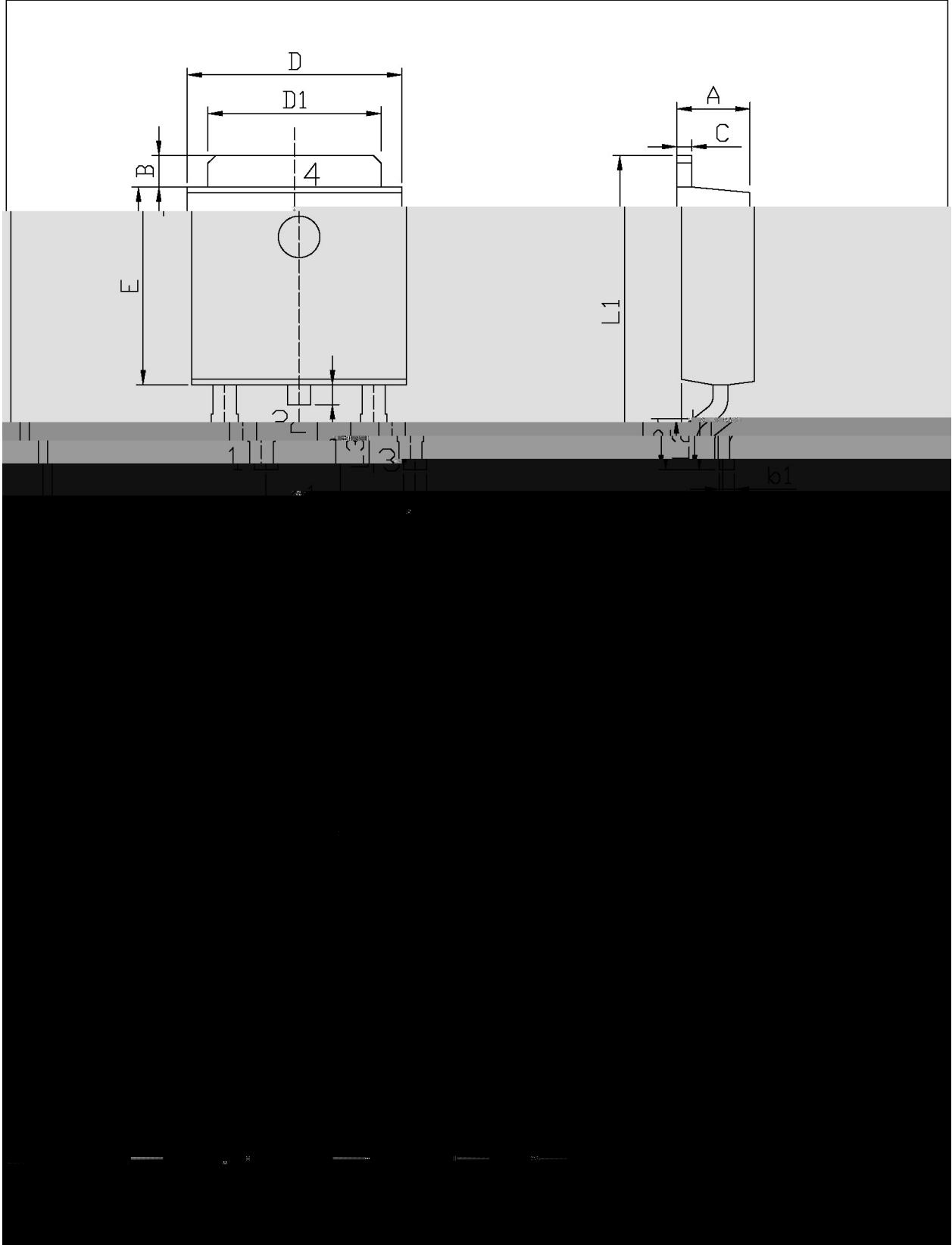

/ Marking Instructions

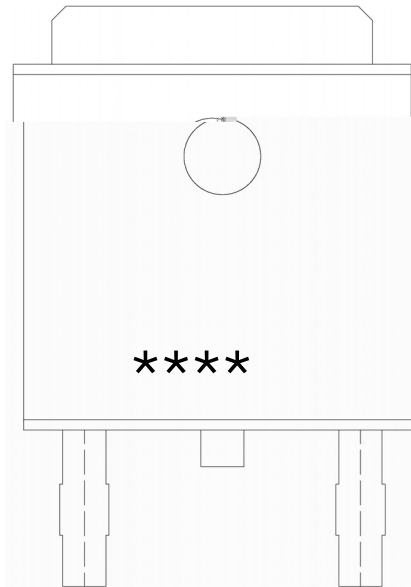

( ) / Temperature Profile for IR Reflow Soldering(Pb-Free)

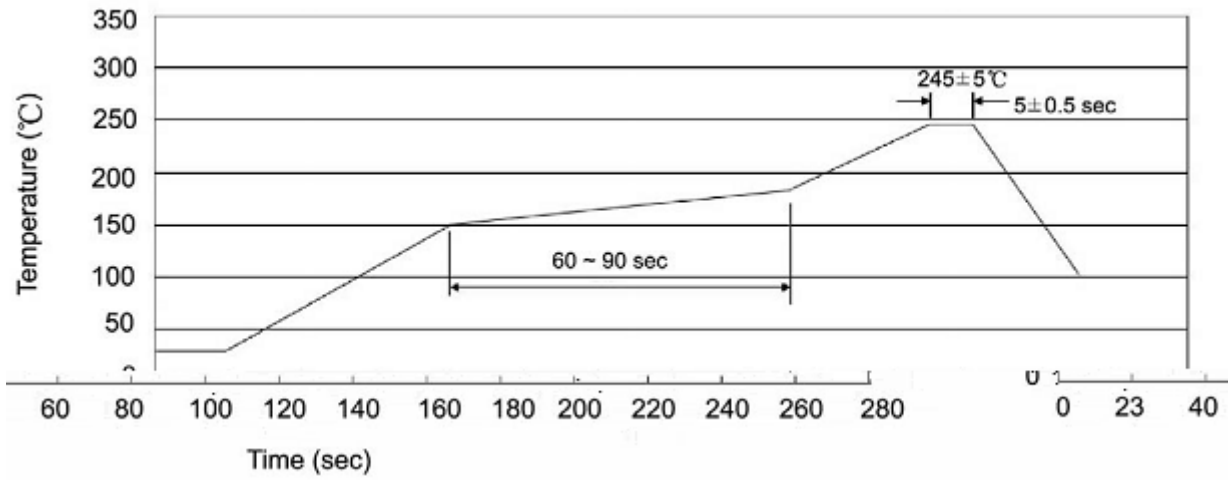

/ Resistance to Soldering Heat Test Conditions

/ Packaging SPEC.

封装形式	包装数量					包装尺寸 :		
	Units/Reel 只/卷盘	Reels/Inner Box 卷盘/盒	Units/Inner Box 只/盒	Inner Boxes/Outer Box 盒/箱	Units/Outer Box 只/箱	Reel	Inner Box 盒	Outer Box 箱
TO-252	2,500	2	5,000	5	25,000	13" ×16	360×360×50	385×257×392

封装形式	包装数量					包装尺寸 :		
	Units/Tube 只/套管	Tubes/Inner Box 套管/盒	Units/Inner Box 只/盒	Inner Boxes/Outer Box 盒/箱	Units/Outer Box 只/箱	Tube 套管	Inner Box 盒	Outer Box 箱

Tuter B-6.3-251/252s/