

SOT-89          PNP          Silicon PNP transistor in a SOT-89 Plastic Package.

, 2SD1766

Low  $V_{CE(sat)}$ , complements the 2SD1766.

Medium power amplifier applications.

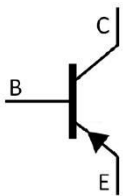

PIN1 Base          PIN 2 Collector          PIN 3 Emitter

$h_{FE}$ Classifications Symbol	P	Q	R
$h_{FE}$ Range	82~180	120~270	180~390
Marking	HBCP	HBCQ	HBCR

Parameter	Symbol	Rating	Unit
Collector to Base Voltage	$V_{CBO}$	-40	V
Collector to Emitter Voltage	$V_{CEO}$	-32	V
Emitter to Base Voltage	$V_{EBO}$	-5.0	V
Collector Current-Continuous	$I_C$	-2.0	A
Collector Current-Continuous(Pulse)	$I_{CP}$	-3.0	A
Collector Power Dissipation	$P_C$	0.5	W
	* $P_C$	2.0	W
Junction Temperature	$T_j$	150	
Storage Temperature Range	$T_{stg}$	-55~150	

\*:mounted on 40×40×0.7mm ceramic board.

\*: 40×40×0.7m

Parameter	Symbol	Test Conditions	Min	Typ	Max	Unit
Collector to Base Breakdown Voltage	$V_{CBO}$	$I_C=-50\mu A$ $I_E=0$	-40			V
Collector to Emitter Breakdown Voltage	$V_{CEO}$	$I_C=-1.0mA$ $I_B=0$	-32			V
Emitter to Base Breakdown Voltage	$V_{EBO}$	$I_E=-50\mu A$ $I_C=0$	-5.0			V
Collector Cut-Off Current	$I_{CBO}$	$V_{CB}=-20V$ $I_E=0$			-1.0	$\mu A$
Emitter Base Cut-Off Current	$I_{EBO}$	$V_{EB}=-4.0V$ $I_C=0$			-1.0	$\mu A$
DC Current Gain	$h_{FE}$	$V_{CE}=-3.0V$ $I_C=-0.5A$	82		390	
Collector to Emitter Saturation Voltage	$V_{CE(sat)}$	$I_C=-2.0A$ $I_B=-0.2A$		-0.5	-0.8	V
Transition Frequency	$f_T$	$V_{CE}=-5.0V$ $I_C=-0.5A$ $f=30MHz$		100		MHz
Collector Output Capacitance	$C_{ob}$	$V_{CB}=-10V$ $I_E=0$ $f=1.0MHz$		50		pF

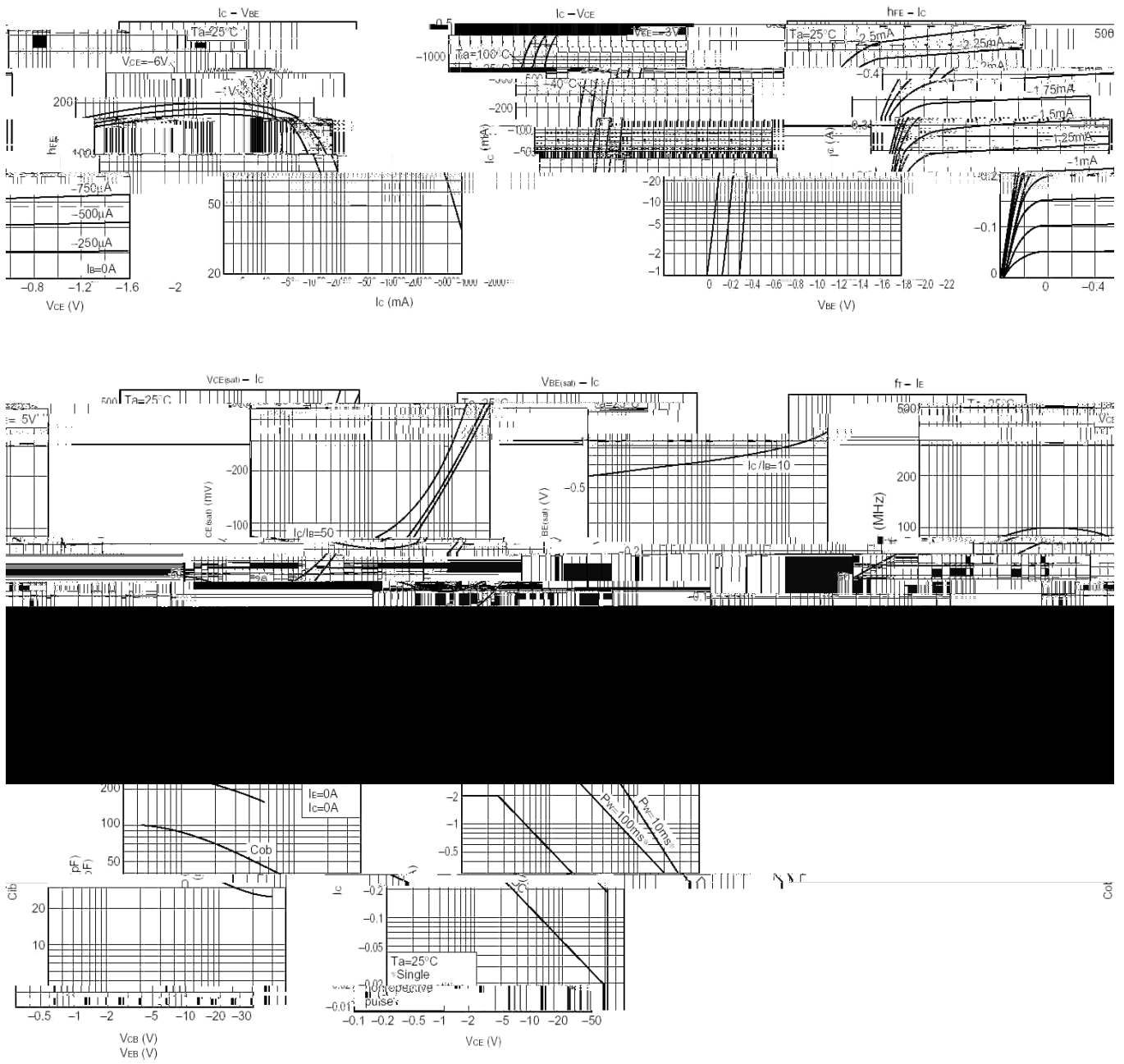

SOT-89

单位: mm

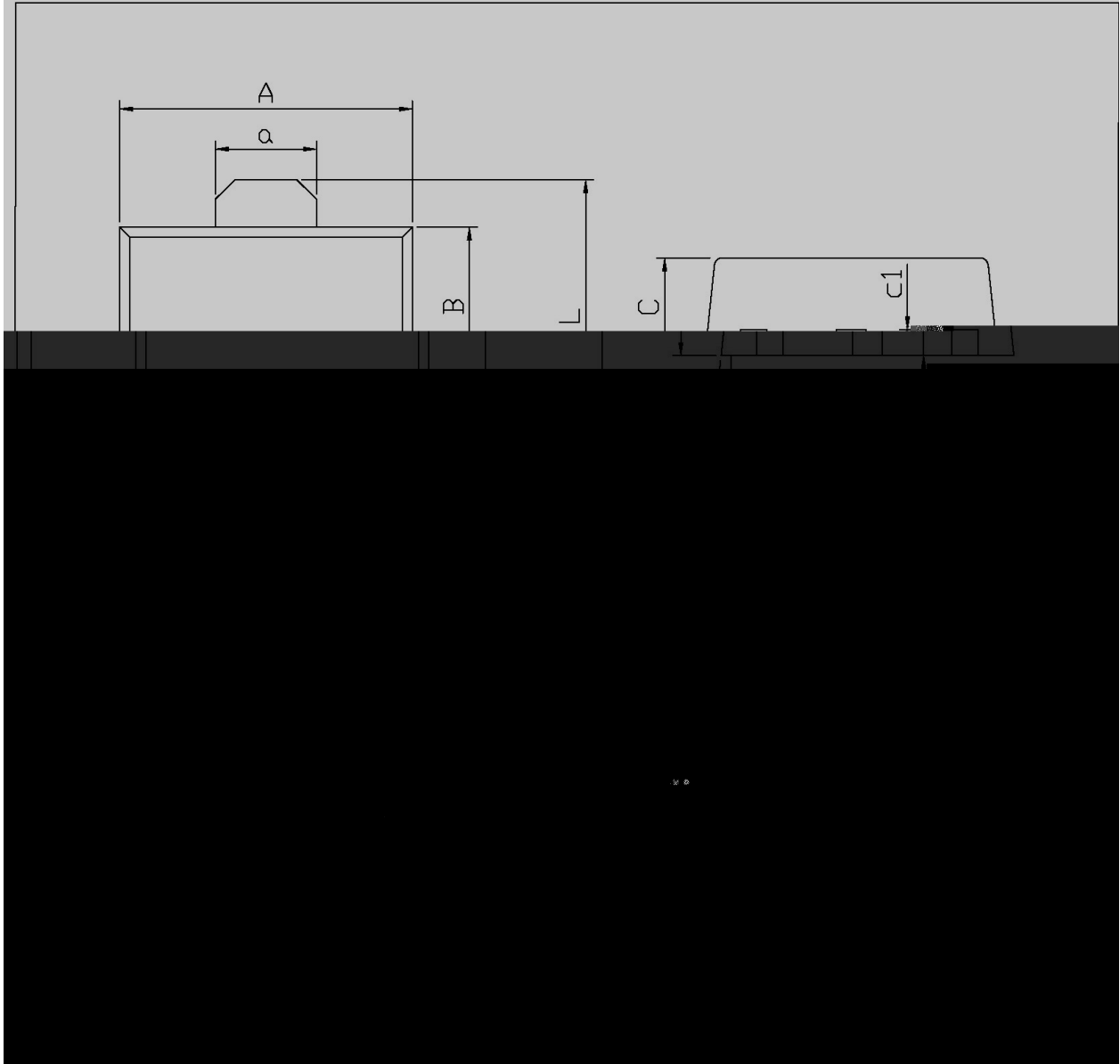

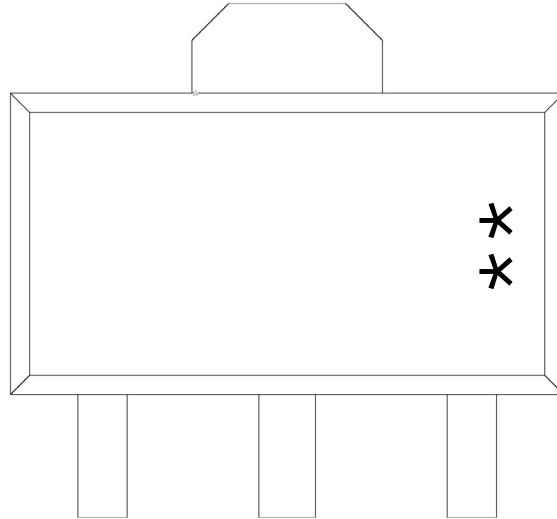

H

BC

P             $h_{FE}$

\*\*

Note:

H:            Company Code.

BC:          Product Type.

P             $h_{FE}$  Classifications Symbol

\*\*:

Lot No. Code, code change with Lot No.

## K\d g\iXk i\`Gif]`d`]fi`@`l`]\fn`Jfd` \i`e`^ZGY\$=i\`z

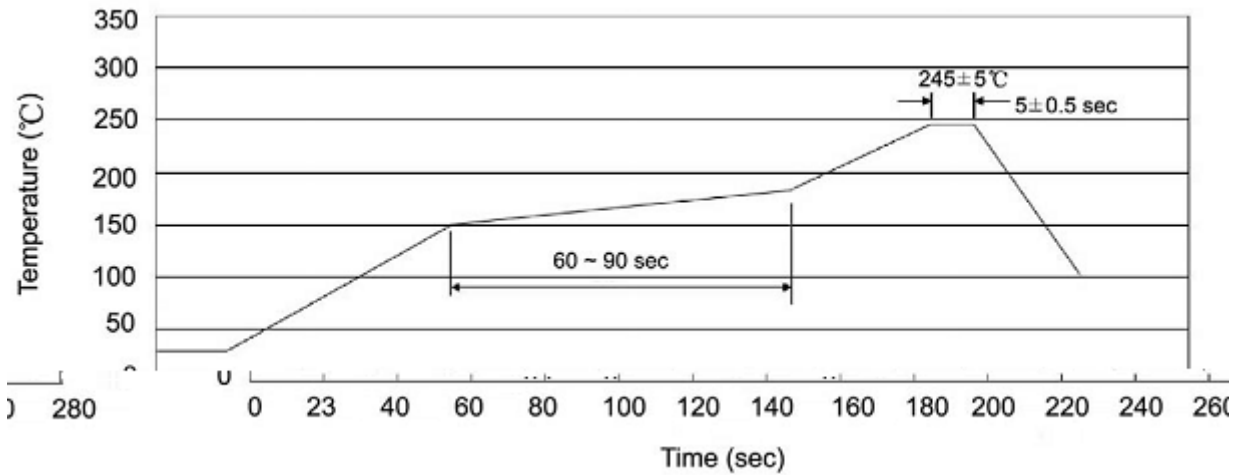

Note:

- |   |       |     |           |        |   |
|---|-------|-----|-----------|--------|---|
| 1 | 25    | 150 | 60        | 90sec; | 1.Preheating:25~150 , Time:60~90sec.    |
| 2 | 245±5 |     | 5±0.5sec; |        | 2.Peak Temp.:245±5 , Duration:5±0.5sec. |
| 3 |       | 2   | 10        | /sec.  | 3. Cooling Speed: 2~10 /sec.            |

260±5

10±1 sec.

Temp.:260±5

Time:10±1 sec

/ REEL

Package Type 封装形式	Units 包装数量					Dimension 包装尺寸 (unit: mm <sup>3</sup> )		
	只卷盘	卷盘盒	只盒	盒箱	只箱		盒	箱
						"		