

Rev.H Oct.-2018

TO-220 NPN Silicon NPN transistor in a TO-220 Plastic Package.

, 2SA940

Wide Safe Operating Area, complementary to 2SA940.

Power amplifier applications, vertical output applications.

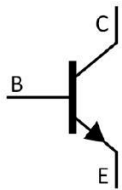

PIN1 Base PIN 2 Collector PIN 3 Emitter

See Marking Instructions.

Parameter	Symbol	Rating	Unit
Collector to Base Voltage	V_{CBO}	150	V
Collector to Emitter Voltage	V_{CEO}	150	V
Emitter to Base Voltage	V_{EBO}	5.0	V
Collector Current - Continuous	I_C	1.5	A
Base Current - Continuous	I_B	0.5	A
Collector Power Dissipation	P_C	2.0	W
	$P_C(T_C=25^\circ\text{C})$	25	W
Junction Temperature	T_j	150	
Storage Temperature Range	T_{stg}	-55~150	

Parameter	Symbol	Test Conditions	Min	Typ	Max	Unit
Collector Cut-Off Current	I_{CBO}	$V_{CB}=120V$ $I_E=0$			10	μA
Emitter Cut-Off Current	I_{EBO}	$V_{EB}=5.0V$ $I_C=0$			10	μA
DC Current Gain	h_{FE}	$V_{CE}=10V$ $I_C=500mA$	40	75	140	
Collector to Emitter Saturation Voltage	$V_{CE(sat)}$	$I_C=500mA$ I_B				

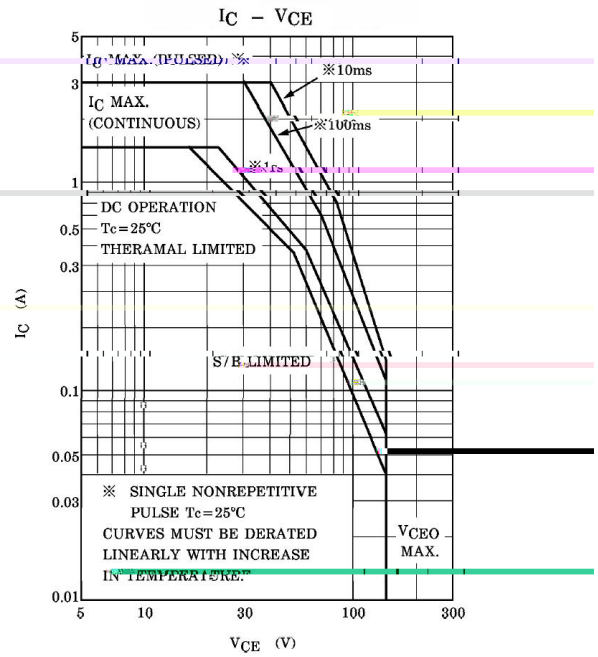
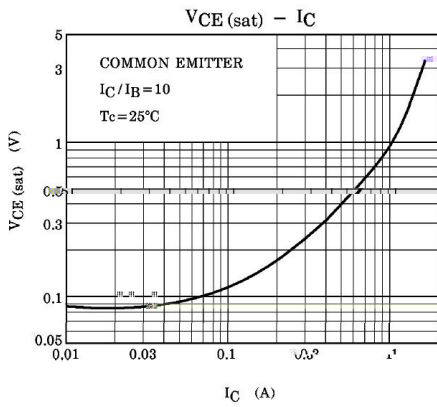
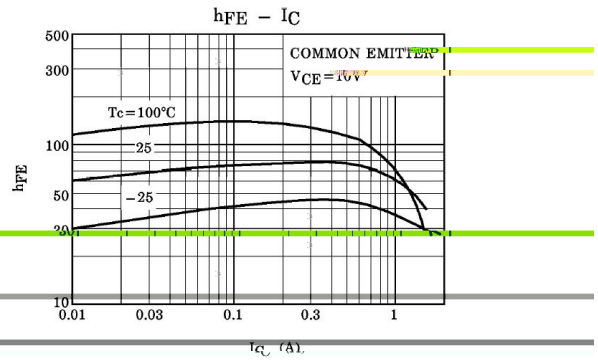
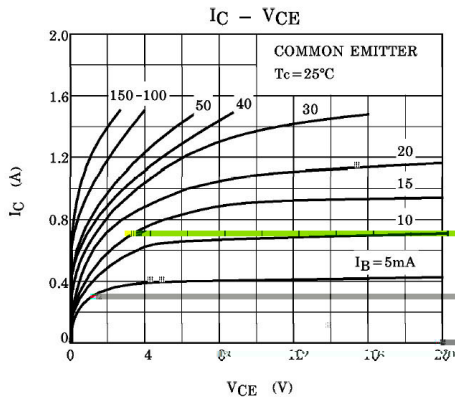

单位: mm

TO-220

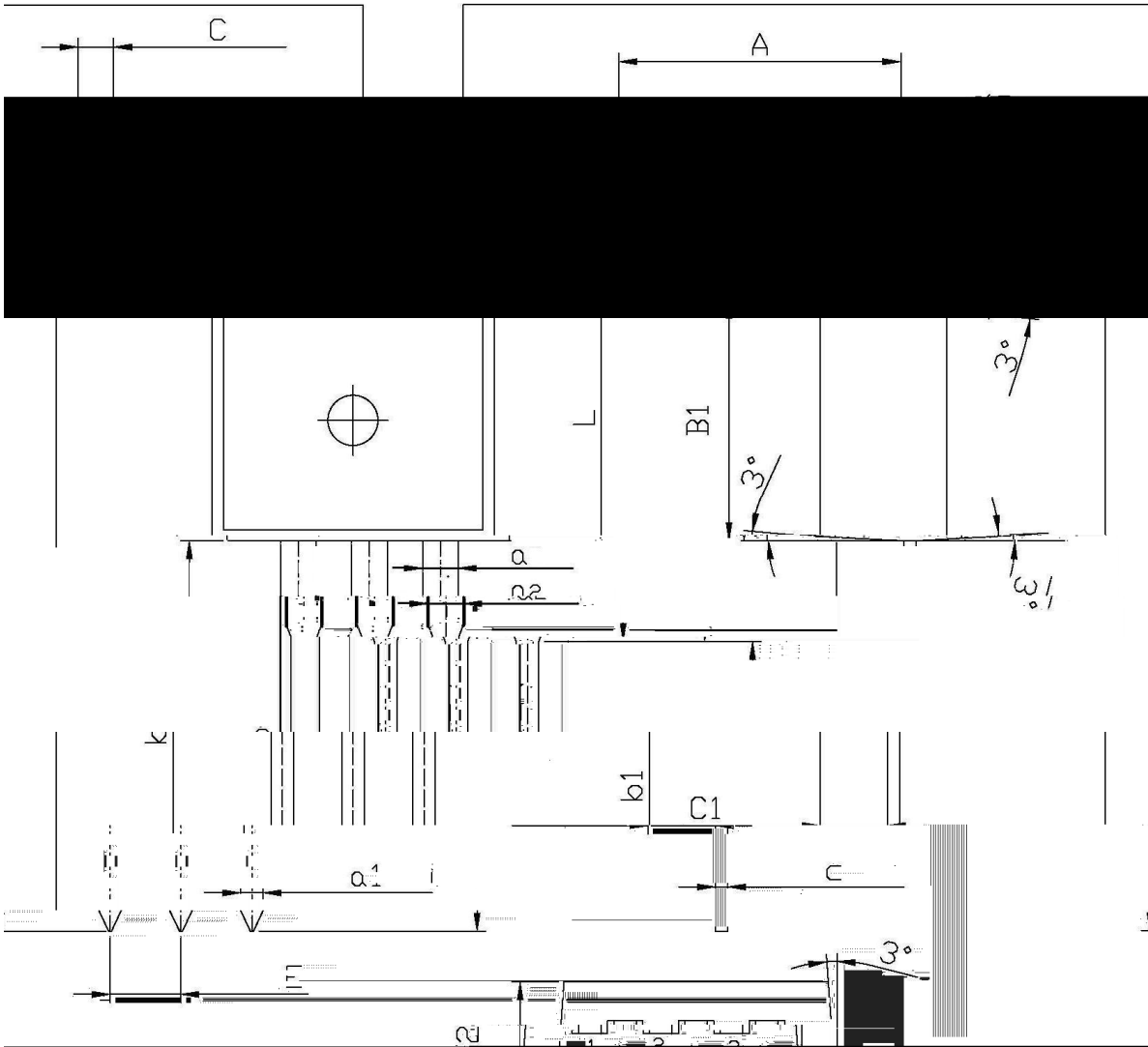

Symbol	Dimensions in Millimeters		Symbol	Dimensions in Millimeters	
	Min	Max		Min	Max
A	9.8	16.2	C	12	14
R	3.56	3.64	B1	6.3	6.7
k	9.0	9.4	L	15.7	16.1
C1	2.2	2.6	a	12.6	13.6
a	0.7	0.9	a1	9.6	10.6
a1	0.4	0.6	b1	0.8	1.22
b1	0.74	1.42	C1	1.3	1.7
C1	1.45			0.2	1.25

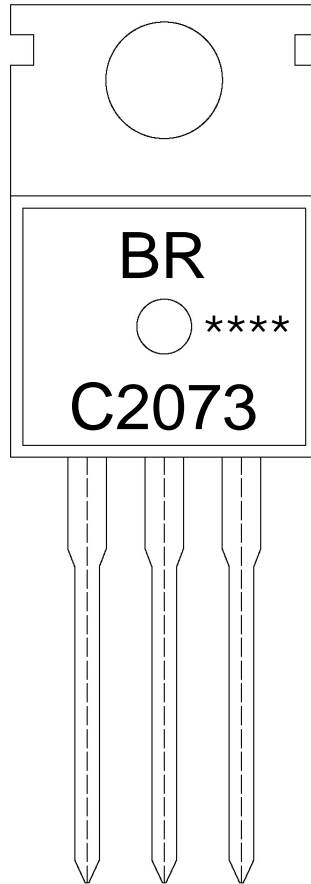

BR

C2073

Note:

BR: Company Code

C2073: Product Type.

****: Lot No. Code, code change with Lot No.

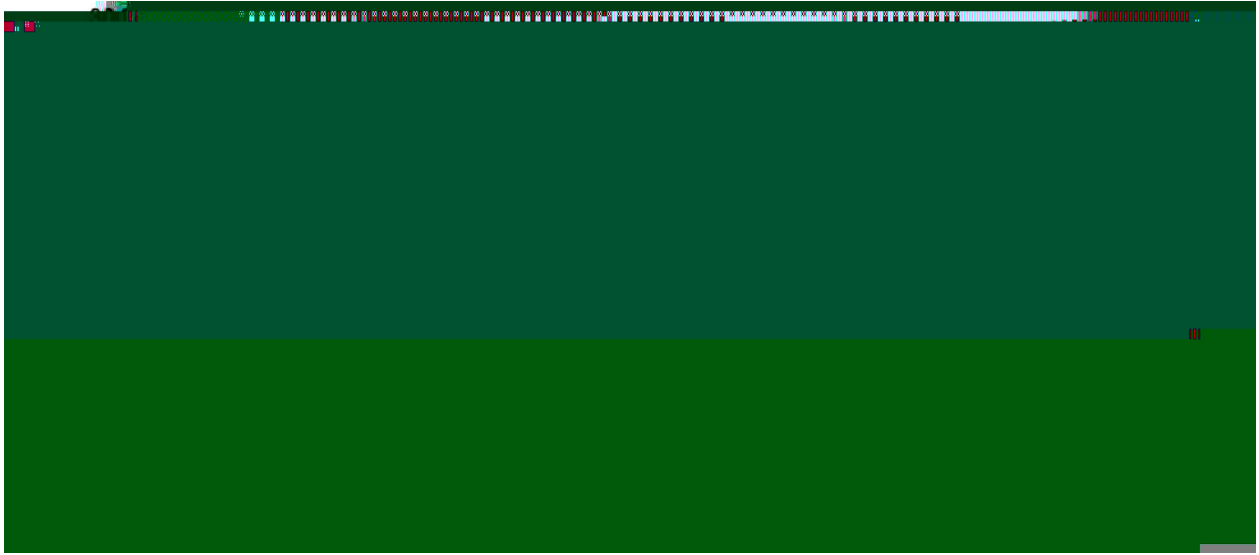

- | | | | | | | |
|---|-------|-----|-----------|--------|---|--------------------------------------|
| 1 | 25 | 150 | 60 | 90sec; | Note: | 1.Preheating:25~150 , Time:60~90sec. |
| 2 | 255±5 | | 5±0.5sec; | | 2.Peak Temp.:255±5 , Duration:5±0.5sec. | |
| 3 | | 2 | 10 | /sec. | 3. Cooling Speed: 2~10 /sec. | |

270±5 10±1 sec. Temp.:270±5 Time:10±1 sec

/ BULK

Package Type	Units					Dimension (unit mm ³)		
	Units/Bag /	Bags/Inner Box /	Units/Inner Box /	Inner Boxes/Outer Box /	Units/Outer Box /	Bag	Inner Box	Outer Box
TO-220/F	200	10	2,000	5	10,000	135×190	237×172×102	560×245×195

/ TUBE

Package Type	Units					Dimension (unit mm ³)		
	Units/Tube /	Tubes/Inner Box /	Units/Inner Box /	Inner Boxes/Outer Box /	Units/Outer Box /	Tube	Inner Box	Outer Box
TO-220/F	50	20	1,000	5	5,000	532×31.4×5.5	555×164×50	575×290×180