

/ h_{FE}

/ Absolute Maximum Ratings(Ta=25)

/ Electrical Characteristics(Ta=25)

						μ
						μ
						μ
						μ
						μ
		Ω				
						μ

/ Electrical Characteristic Curve

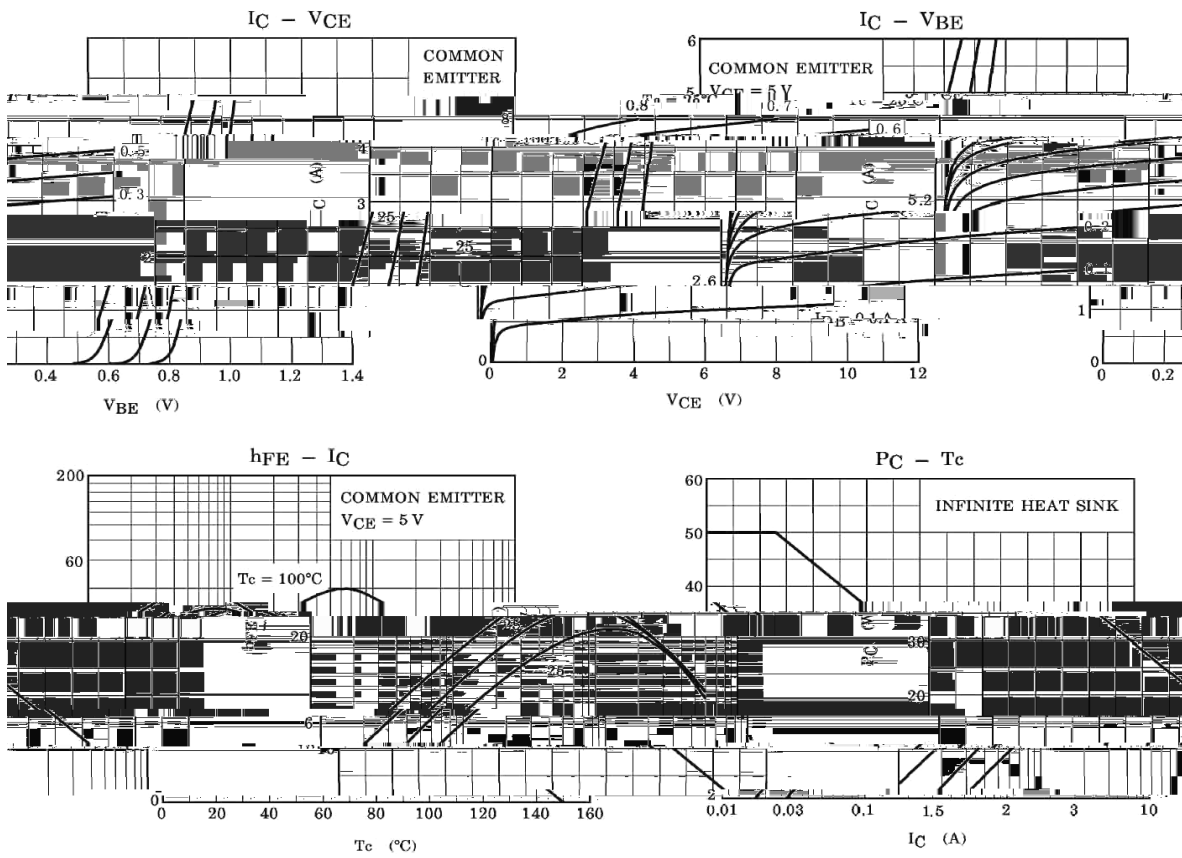

/ Package Dimensions

单位: mm

T0-220

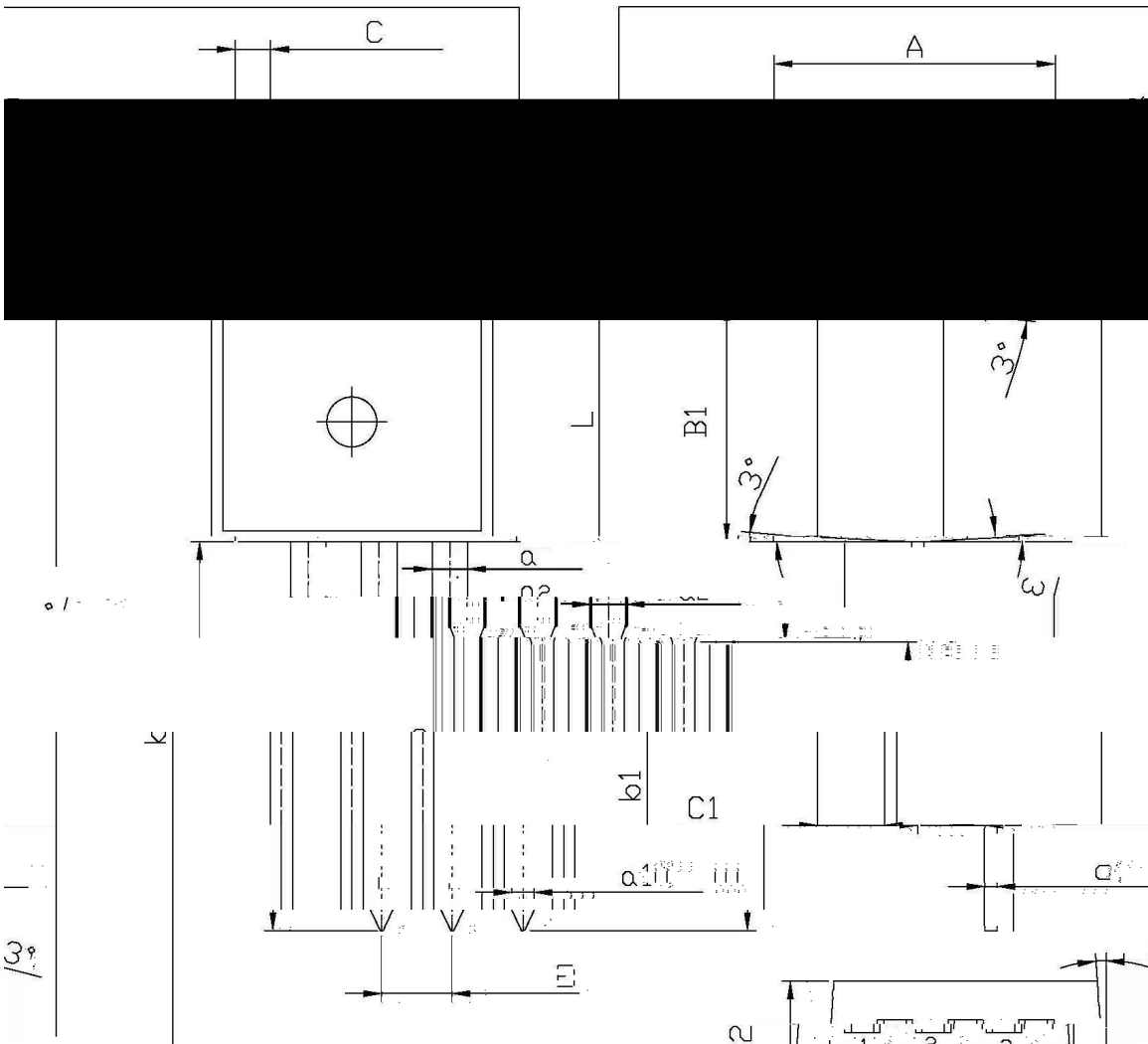

Symbol	Dimensions in Millimeters		Symbol	Dimensions in Millimeters	
	Min	Max		Min	Max
A	9.8	10.2	C	1.2	1.4
B	9.0	9.4	B1	6.3	6.7
C1	15.7	16.1			
a	1.45	1.45			
b1	0.2	0.25			
E	0.4	0.6			

/ Marking Instructions

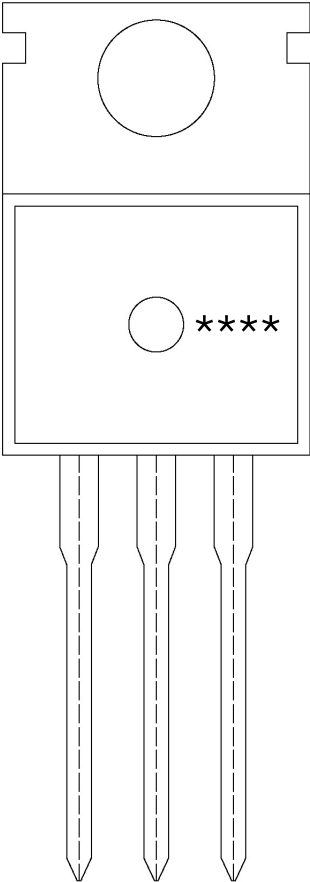

() / Temperature Profile for Dip Soldering(Pb-Free)

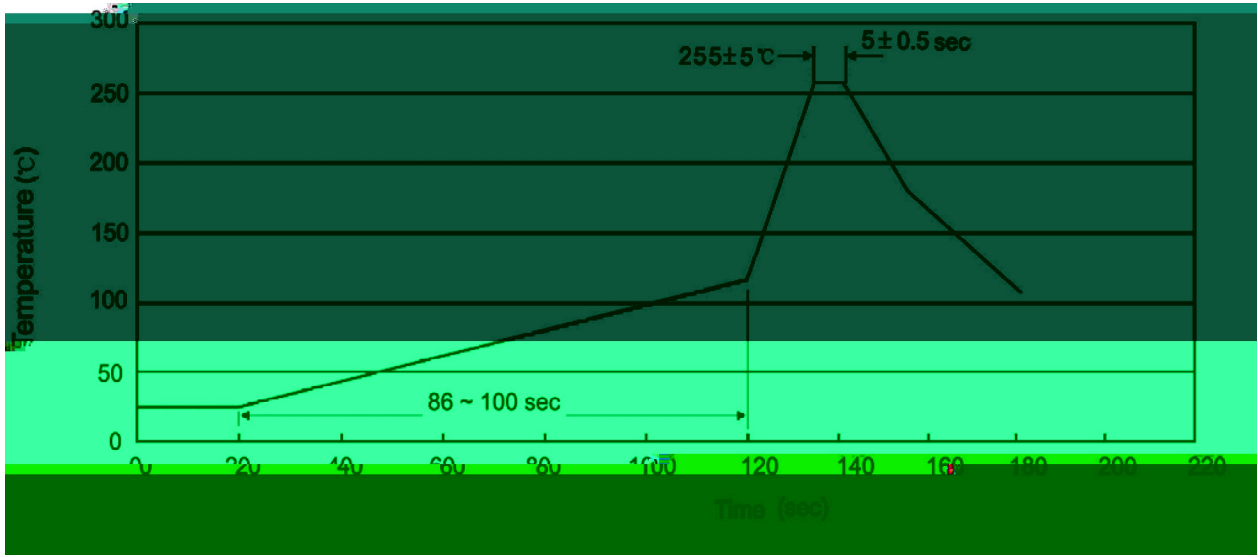

/ Resistance to Soldering Heat Test Conditions

/ Packaging SPEC.

封装形式	Units/Bag 只/袋	Bags/Inner Box 袋/盒	Units/Inner Box 只/盒	包装数量 c	包装尺寸	:
------	------------------	-----------------------	------------------------	-----------	------	---