

/ Descriptions

SOT-23 PNP Silicon PNP transistor in a SOT-23 Plastic Package.

/ Features

P_C , h_{FE} , 9014MG
High P_C and I_C , excellent h_{FE} linearity, complementary pair with 9014MG, HF Product.

/ Applications

low frequency, low noise pre-amplifier.

/ Equivalent Circuit

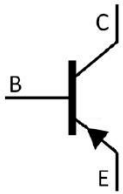

/ Pinning

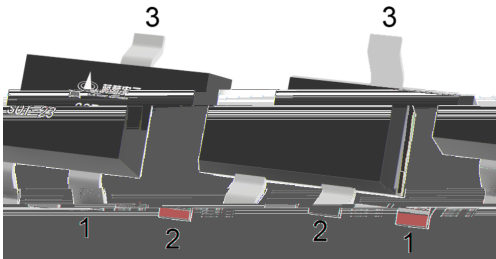

PIN1 Base PIN 2 Emitter PIN 3 Collector

/ h_{FE} Classifications & Marking

h _{FE} Classifications Symbol	A	B	C	D
h _{FE} Range	60 150	100 300	200 600	400 1000
Marking	GM6A	GM6B	GM6C	GM6D

/ Absolute Maximum Ratings(Ta=25)

Parameter	Symbol	Rating	Unit
Collector to Base Voltage	V _{CBO}	-50	V
Collector to Emitter Voltage	V _{CEO}	-45	V
Emitter to Base Voltage	V _{EBO}	-5.0	V
Collector Current	I _C	-100	mA
Collector Power Dissipation	P _C	200	mW
Junction Temperature	T _j	150	°C
Storage Temperature Range	T _{stg}	-55 150	°C

/ Electrical Characteristics(Ta=25)

Parameter	Symbol	Test Conditions	Min	Typ	Max	Unit
Collector to Base Breakdown Voltage	V _{CBO}	I _C =-0.1mA I _E =0	-50			V
Collector to Emitter Breakdown Voltage	V _{CEO}	I _C =-1.0mA I _B =0	-45			V
Emitter to Base Breakdown Voltage	V _{EBO}	I _E =-0.1mA I _C =0	-5.0			V
Collector Cut-Off Current	I _{CBO}	V _{CB} =-50V I _E =0			-0.05	A
Emitter Cut-Off Current	I _{EBO}	V _{EB} =-5.0V I _C =0			-0.05	A
DC Current Gain	h _{FE}	V _{CE} =-5.0V I _C =-1.0mA	60		600	
Collector-Emitter Saturation voltage	V _{CE(sat)}	I _C =-100mA I _B =-5.0mA		-0.2	-0.7	V
Base-Emitter Saturation Voltage	V _{BE(sat)}	I _C =-100mA I _B =-5.0mA		-0.82	-1.0	V
Base-Emitter Voltage	V _{BE}	V _{CE} =-5.0V I _C =-2.0mA		-0.65	-0.75	V
Transition Frequency	f _T	V _{CE} =-5.0V I _C =-10mA	100	190		MHz
Collector Output Capacitance	C _{ob}	V _{CB} =-10V I _E =0 f=1.0MHz		4.5	7.0	pF
Noise Figure	NF	V _{CE} =-5.0V I _C =-0.2mA R _g =2.0K f=1.0KHz Δf=200Hz		0.7	10	dB

/ Electrical Characteristic Curve

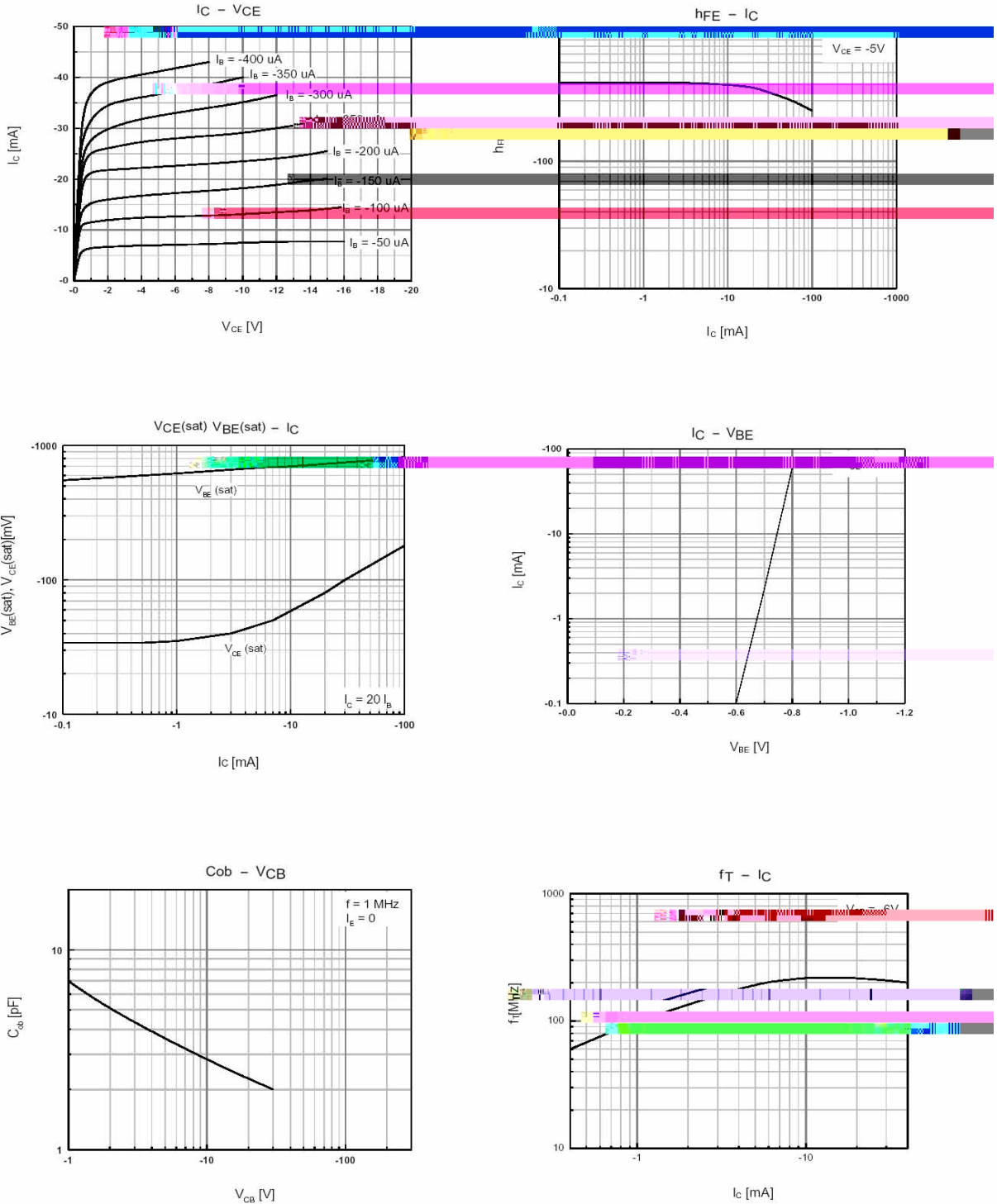

/ Package Dimensions

SOT-23

单位: mm

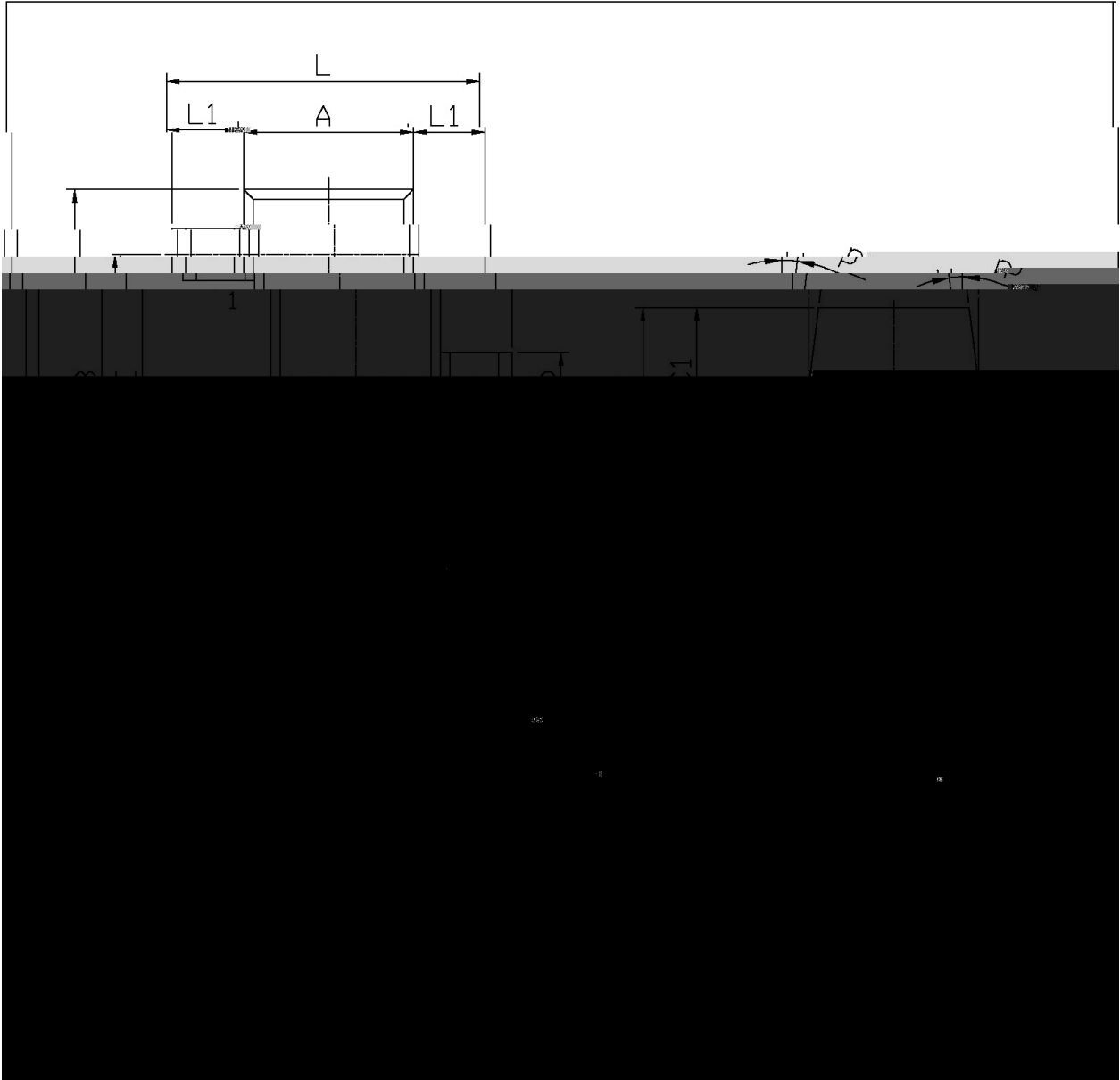

/ Marking Instructions

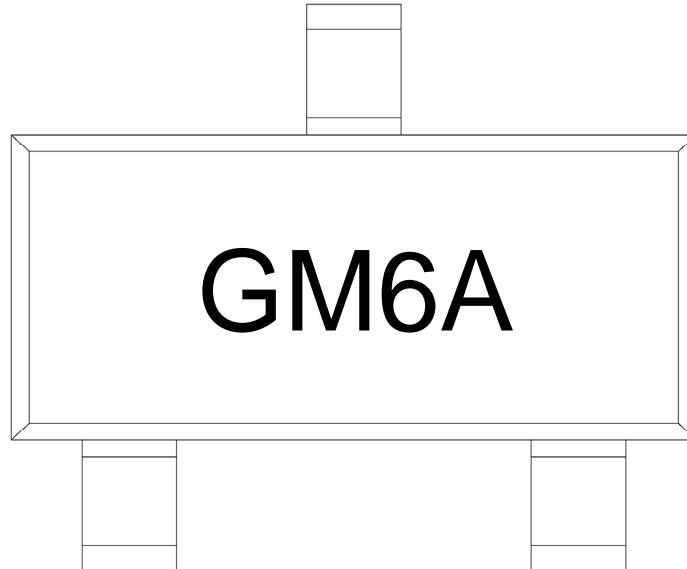

G

M6

A h_{FE}

Note:

G HF Product Code

M6 Product Type Code

A h_{FE} Classifications Symbol Code

