

SOT-23

Schottky diodes in a SOT-23 Plastic Package.

Schottky diodes, HF Product.

Low forward and reverse recovery times.

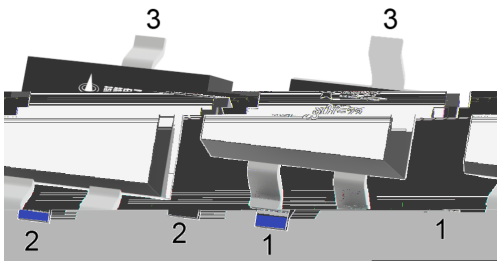
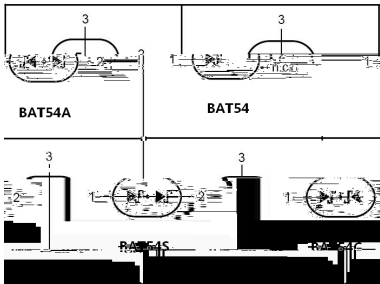

PIN: See Equivalent Circuit.

Model	BAT54	BAT54A	BAT54C	BAT54S
Marking	HL4P	HL42	HL43	HL44

Parameter	Symbol	Rating	Unit
Repetitive Reverse Voltage	V_{RRM}	30	V
Average Rectified Forward Current	$I_{F(AV)}$	200	mA
Non-repetitive Peak Forward Surge Current	I_{FSM}	600	mA
Power Dissipation	P_D	290	mW
Thermal Resistance, Junction to Ambient	R_{JA}	430	/W
Junction Temperature	T_j	125	
Storage Temperature Range	T_{stg}	-55 150	

Parameter	Symbol	Test Conditions	Min	Typ	Max	Unit
Breakdown Voltage	V_R	$I_R=10\mu A$	30			V
Forward Voltage	V_F	$I_F=0.1mA$			240	mV
		$I_F=1.0mA$			320	mV
		$I_F=10mA$			400	mV
		$I_F=30mA$			500	mV
		$I_F=100mA$			0.8	V
Instantaneous Reverse Current	I_R	$V_R=25V$			2.0	μA
Total Capacitance	C_T	$V_R=1.0V$ $f=1.0MHz$			10	pF
Reverse Recovery Time	t_{rr}	$I_F=10mA$ $I_{RR}=1.0mA$ $R_L=100$			5.0	ns

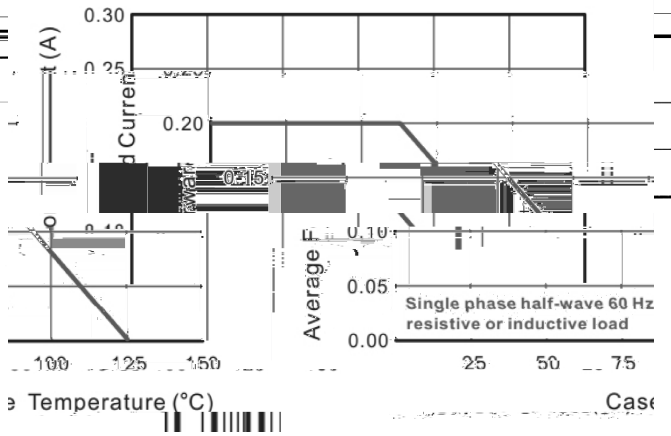
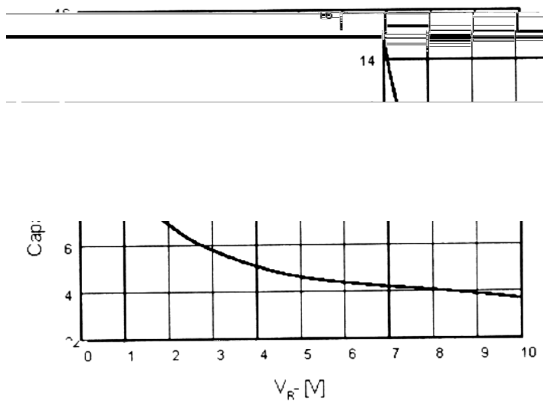
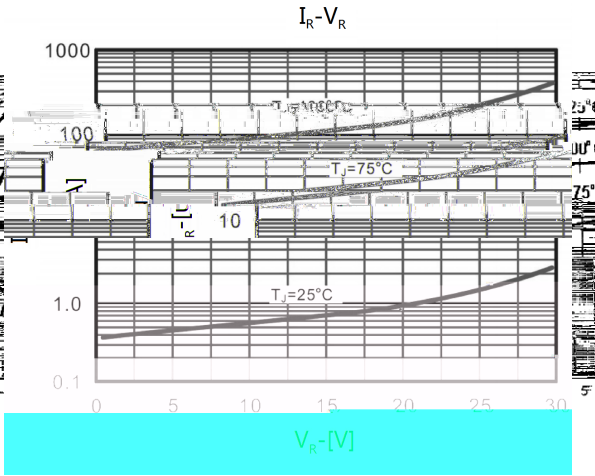
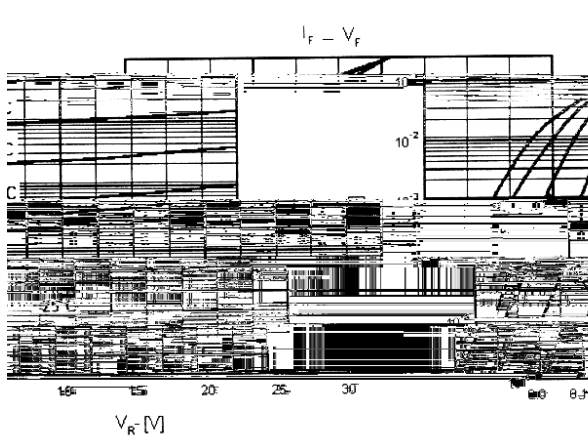

SOT-23

单位: mm

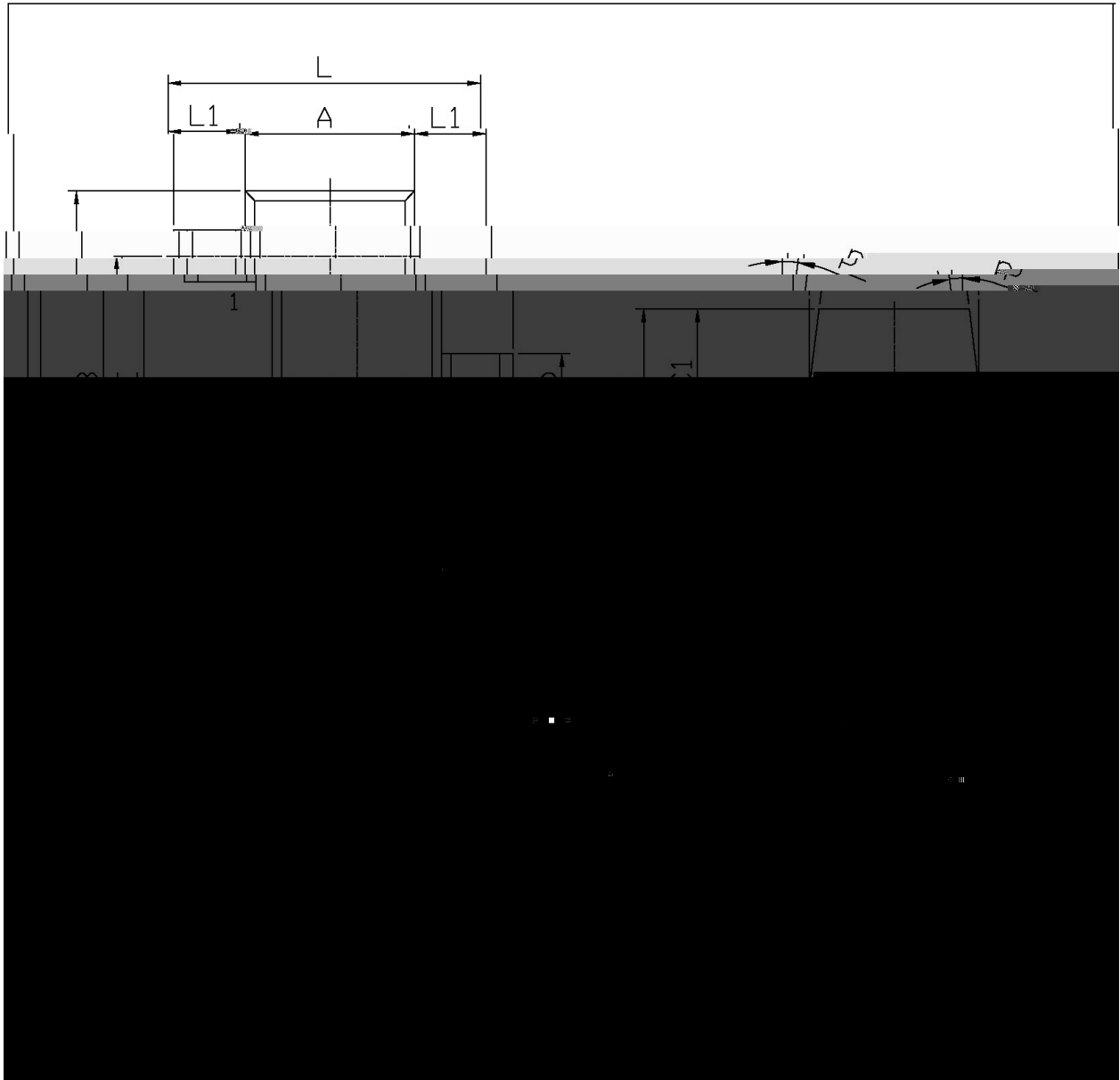

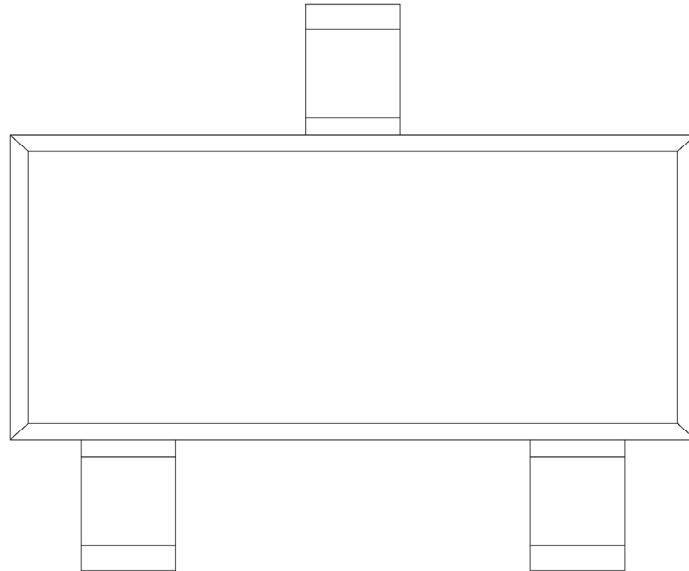

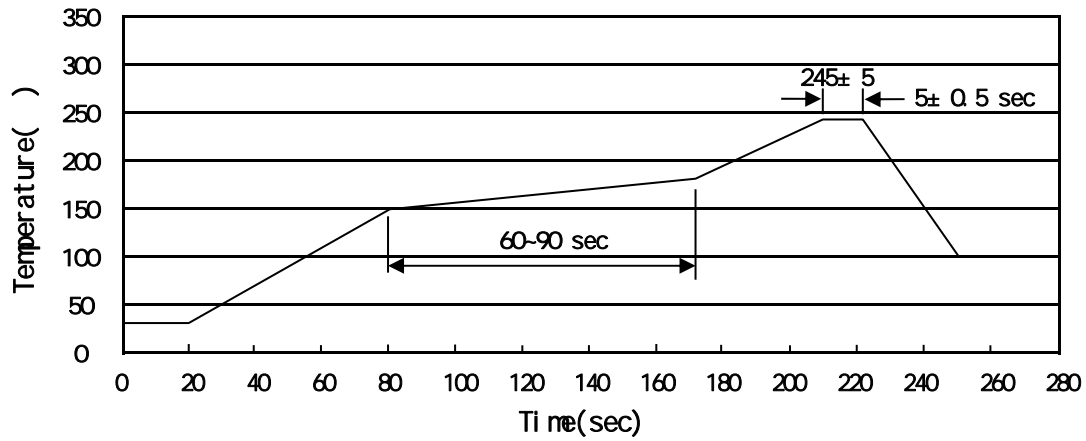

Note:

- | | | | | | |
|---|-------|-----|-----------|--------|-----------------------------------------|
| 1 | 150 | 180 | 60 | 90sec; | 1.Preheating:150~180 , Time:60~90sec. |
| 2 | 245±5 | | 5±0.5sec; | | 2.Peak Temp.:245±5 , Duration:5±0.5sec. |
| 3 | | 2 | 10 | /sec. | 3. Cooling Speed: 2~10 /sec. |

260±5

10±1 sec.

Temp.:260±5

Time:10±1 sec

/ REEL

Package Type	Units					Dimension (unit mm ³)		
SOT-23	3,000	10	30,000	6	180,000	7 x8	180x120x180	390x385x205