

/ Descriptions

TO-92 NPN

/ Features

, BF421

/ Applications

/ Equivalent Circuit



/ Pinning



/ hFE Classifications & Marking

/ Electrical Characteristic Curve

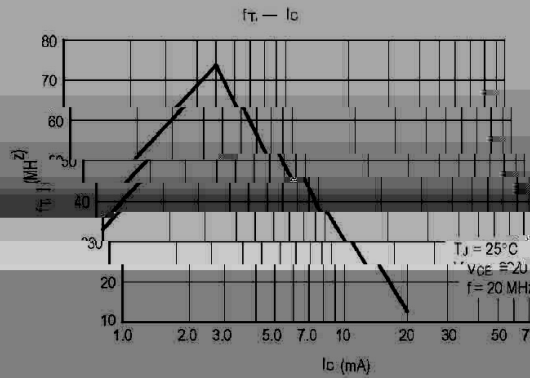
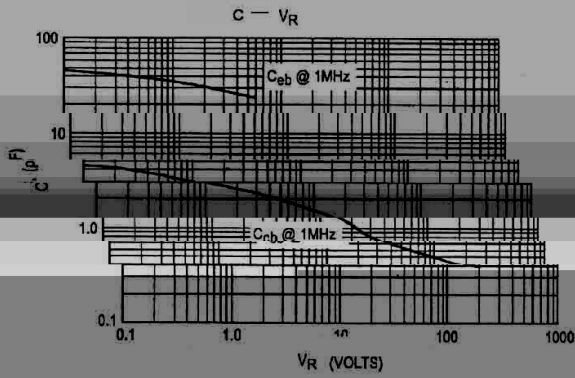
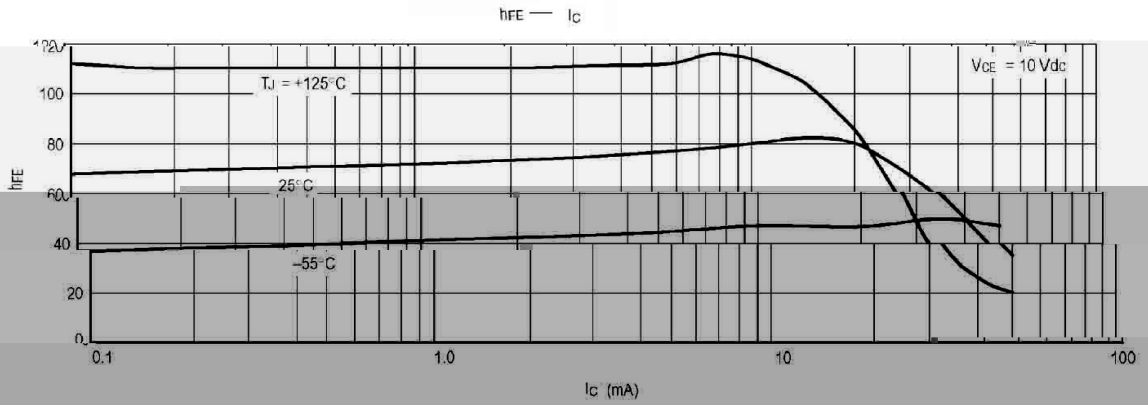

/ Package Dimensions

TO-92

Unit: mm

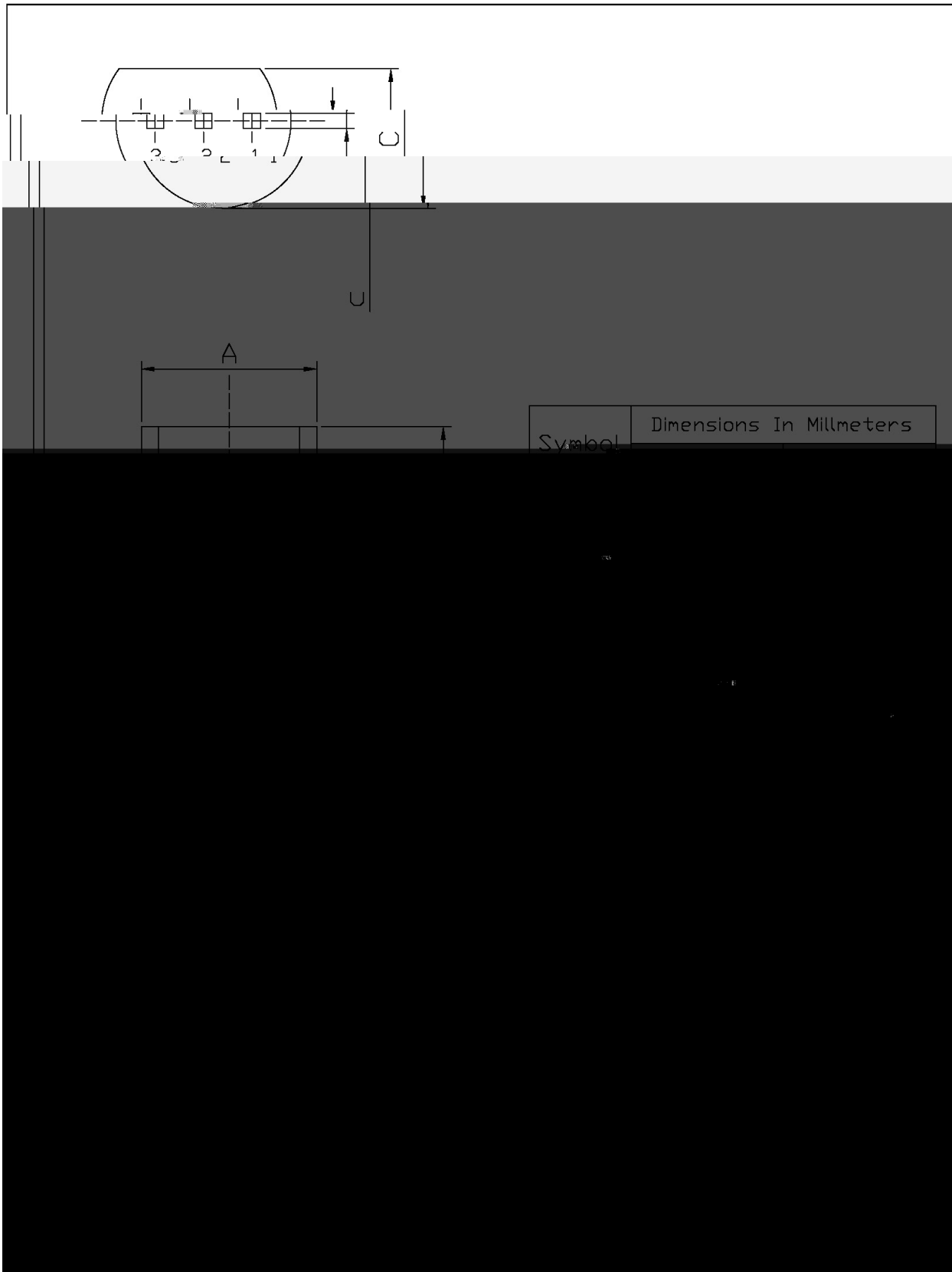

/ Marking Instructions

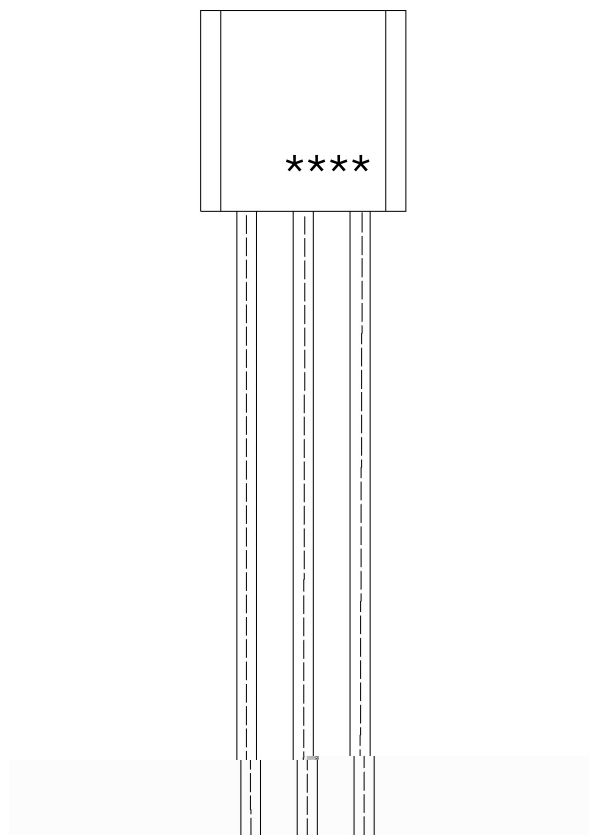

BR:
BF420

() / Temperature Profile for Dip Soldering(Pb-Free)

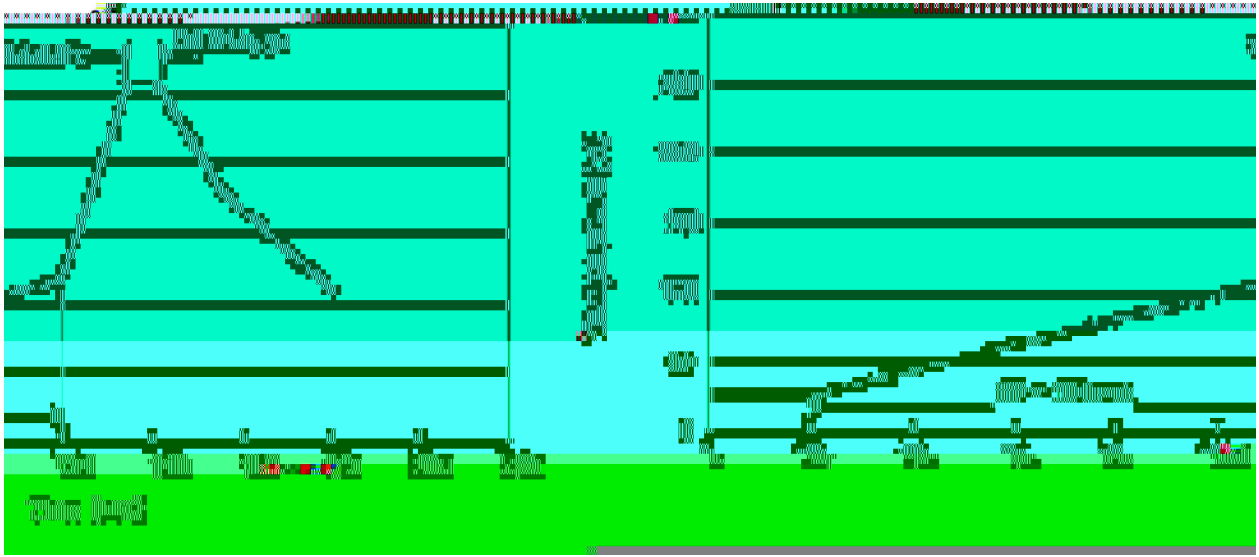

± ± ± ±

/ Resistance to Soldering Heat Test Conditions

± ± °C

/ Packaging SPEC.

	Units/Bag	Bags/Inner Box	Units/Inner Box	Inner Boxes/Outer Box	Units/Outer Box	Bag	Inner Box	Outer Box
	/	/	/	/	/			
TO-92	1,000	10	10,000	5	50,000	135×190	237×172×102	560×245×195
	1,000	10	10,000	10	100,000	135×190	237×172×102	560×245×375

	Units/tape	Tape/Inner Box	Rows/Inner Box	Inner Boxes/Outer Box	Units/Outer Box	Inner Box	Outer Box
	/	/	/	/	/		
TO-92	3,000	1	120	10	30,000	328×230×42	480×346×235 547×407×268

/ Notices