

SOT-23

Precision adjustable shunt regulator in a SOT-23 Plastic Package.

1.250V 0.5% 1% 100uA 100mA
 $V_O = V_{ref}$ 20V (:55μA) (:0.05)

Precise reference voltage to 1.250V, guaranteed 0.5%, 1% ,reference voltage Tolerance, sink current capability, 100uA 100mA, quick turn-on, adjustable output voltage, $V_O = V_{ref}$ 20V, low operational cathode current, 55μA typical, 0.05 typical output impedance.

Linear regulators, adjustable power supply, switching power supply.

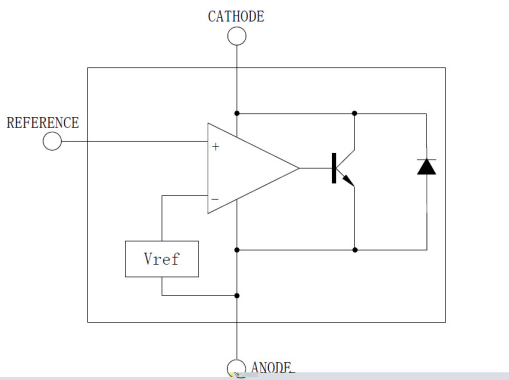

PIN1 R PIN 2 K PIN 3 A ref

BR432M
Rev.A Jun.-2018

DATA SHEET

/ Electrical Characteristic Curve

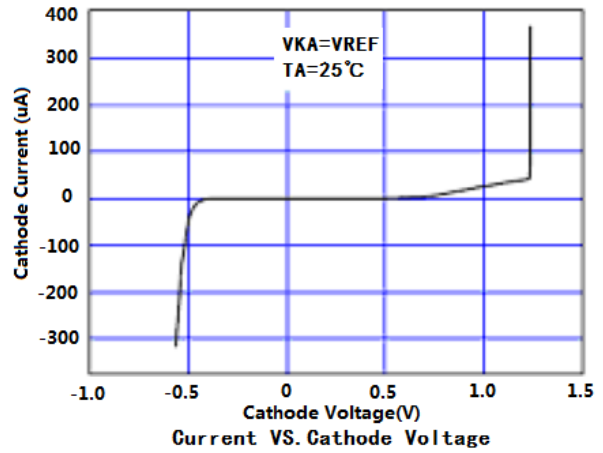
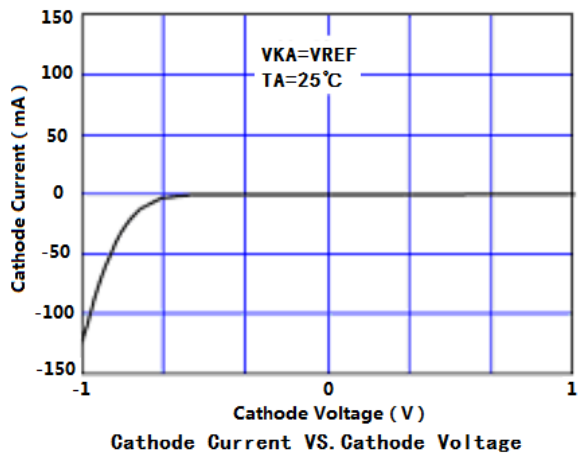
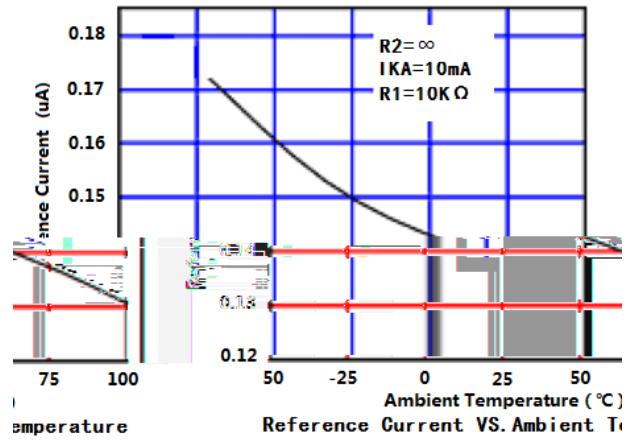
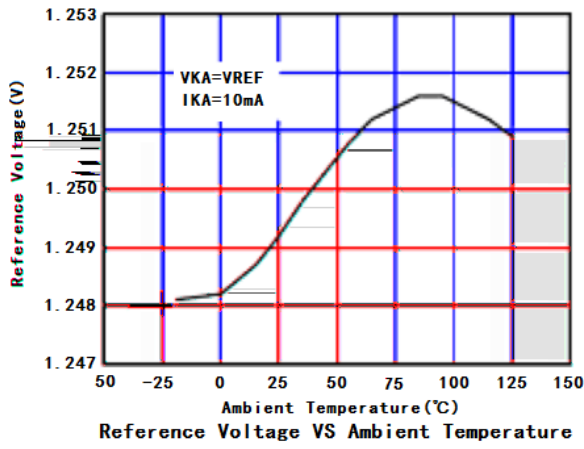

BR432M
Rev.A Jun.-2018

&

/ Package Dimensions

SOT-23

单位: mm.

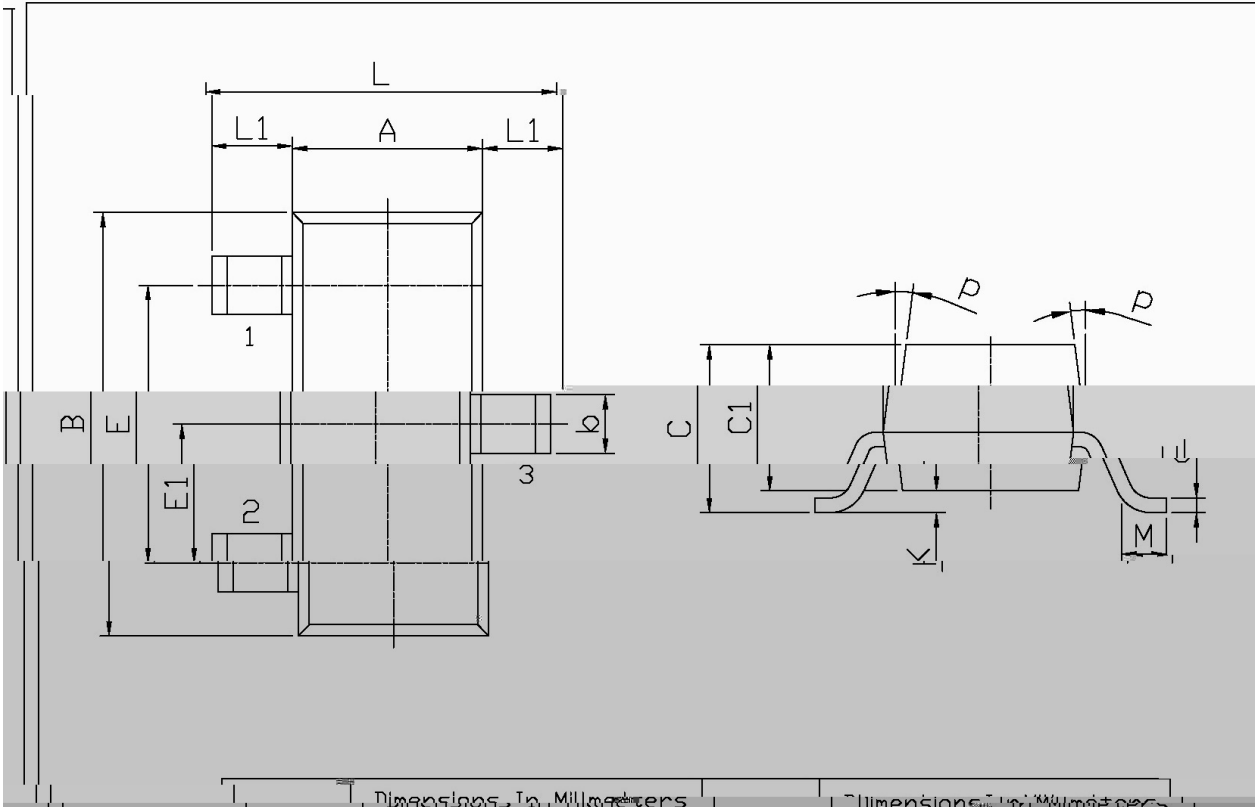

Dimensions In Millimeters			Dimensions In Millimeters		
Symbol	Min	Max	Symbol	Min	Max
L	2.2	2.7	C	1.30Max	
L1	0.45	0.65	C1	0.90	1.20

/ **Marking Instructions**

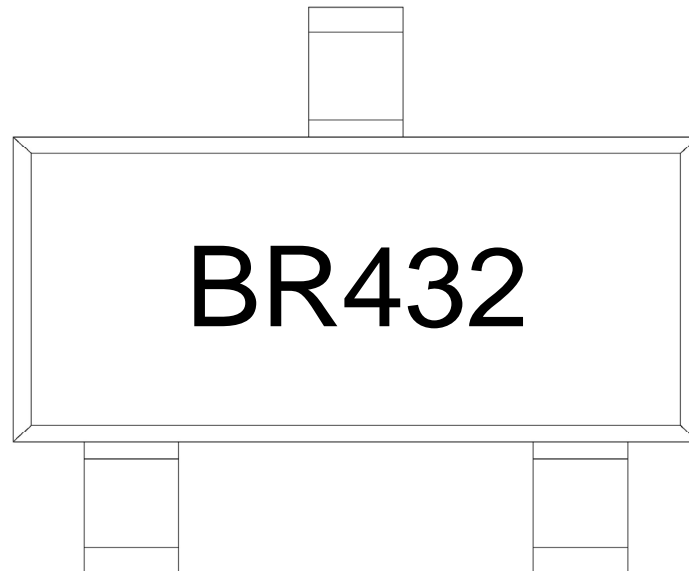

BR

432

Note:

BR: Company Code.

432: Product Type.

() / Temperature Profile for IR Reflow Soldering(Pb-Free)

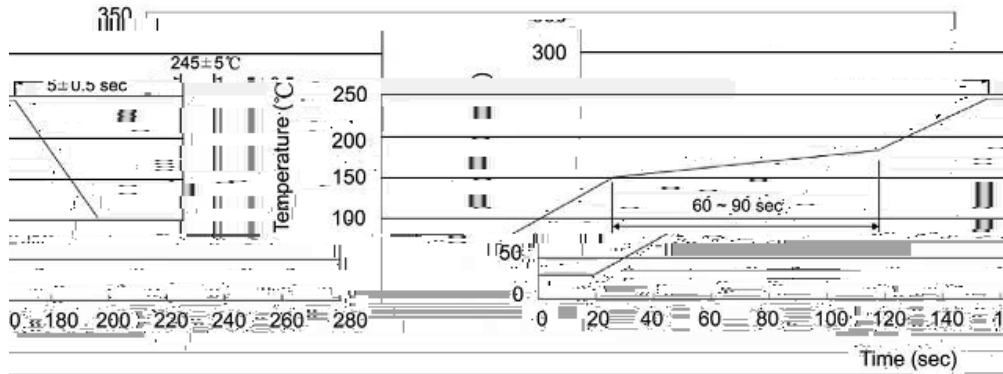

Note:

- | | | | |
|---|---------|-----------|---|
| 1 | 150 180 | 60 90sec; | 1.Preheating:150~180 , Time:60~90sec. |
| 2 | 245±5 | 5±0.5sec; | 2.Peak Temp.:245±5 , Duration:5±0.5sec. |
| 3 | 2 10 | /sec. | 3. Cooling Speed: 2~10 /sec. |

/ Resistance to Soldering Heat Test Conditions

260±5 10±1 sec. Temp.:260±5 Time:10±1 sec

/ Packaging SPEC.

/ REEL

Package Type 封装形式	Units 包装数量					Dimension 包装尺寸 (unit: mm ³)		
	只卷盘	卷盘盒	只盒	盒箱	只箱		盒	箱

/ Notices