

Rev.A Apr.-2023

Parameter	Symbol	Rating	Unit
Repetitive Reverse Voltage	$V_{RRM}$	85	V
Continuous Reverse Voltage	$V_R$	75	V
Average Rectified Forward Current	$I_{F(\text{single diode loaded})}$	215	mA
	$I_{F(\text{double diode loaded})}$	125	mA
Repetitive Peak Forward Current	$I_{FRM}$	450	mA
Non-repetitive Peak Forward Surge Current	$I_{FSM(1)(t=1\mu S)}$	4.0	A
	$I_{FSM(2)(t=1mS)}$	1.0	A
	$I_{FSM(3)(t=1S)}$	0.5	A
Power Dissipation	$P_{tot}$	250	mW
Junction Temperature	$T_j$	150	°C
Storage Temperature Range	$T_{stg}$	-55 150	°C

Parameter	Symbol	Test Conditions	Min	Typ	Max	Unit
Forward Voltage	$V_F$	$I_F=1.0mA$			715	mV
		$I_F=10mA$			855	mV
		$I_F=50mA$			1.0	V
		$I_F=150mA$			1.25	V
Instantaneous Reverse Current	$I_R$	$V_R=25V$			30	nA
		$V_R=75V$			1.0	μA
		$V_R=25V$ $T_A=150$			30	μA
		$V_R=75V$ $T_A=150$			50	μA
Total Capacitance	$C_T$	$V_R=0$ $f=1.0MHz$			2.0	pF
Reverse Recovery Time	$t_{rr}$	$I_F=1R=10mA$ $I_{RR}=1.0mA$ $R_L=100\Omega$			4.0	ns
Forward recovery voltage	$V_{ft}$	$I_F=10mA$ $t_r=20ns$			1.75	V

Rev.A Apr.-2023

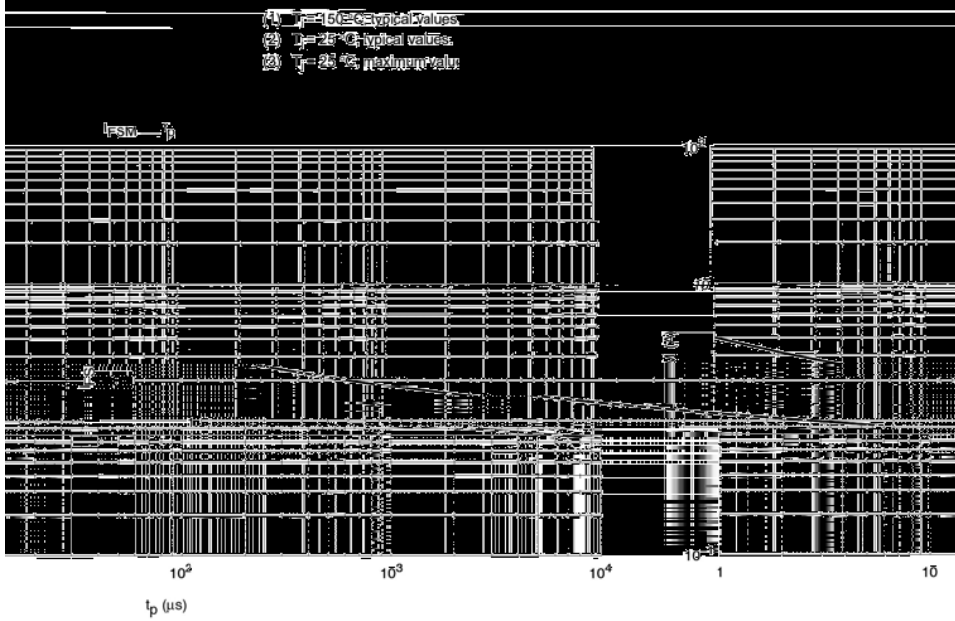
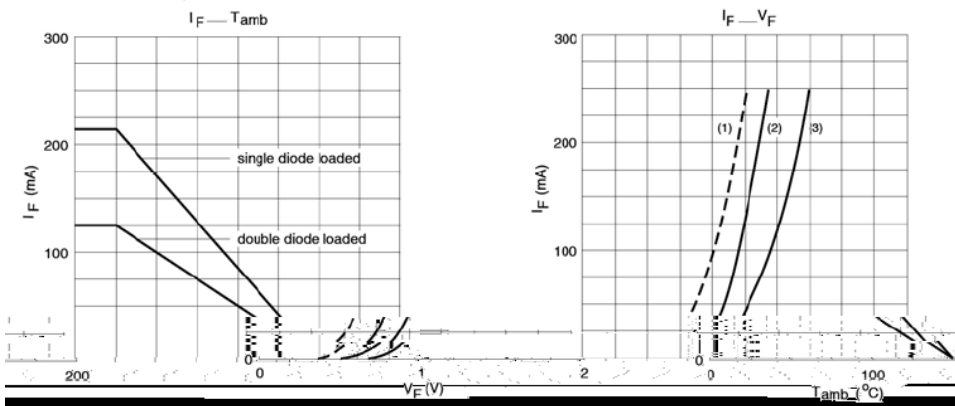

$T_j = 25^\circ\text{C}$  prior to surge.

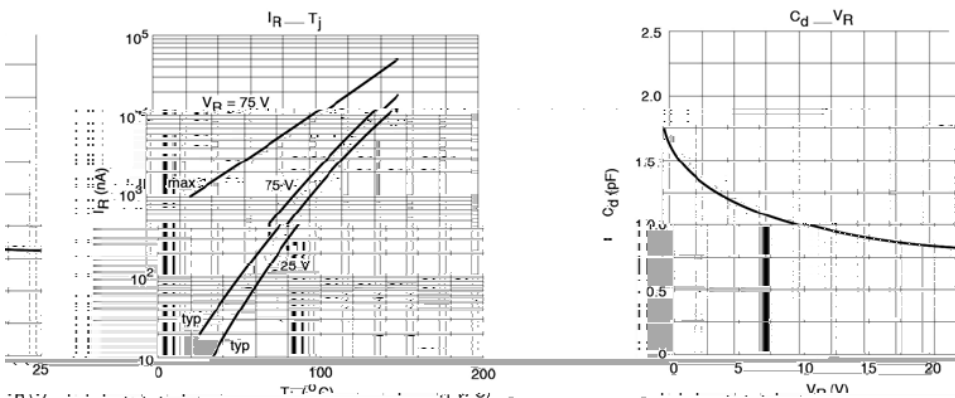

SOT-23

单位: mm

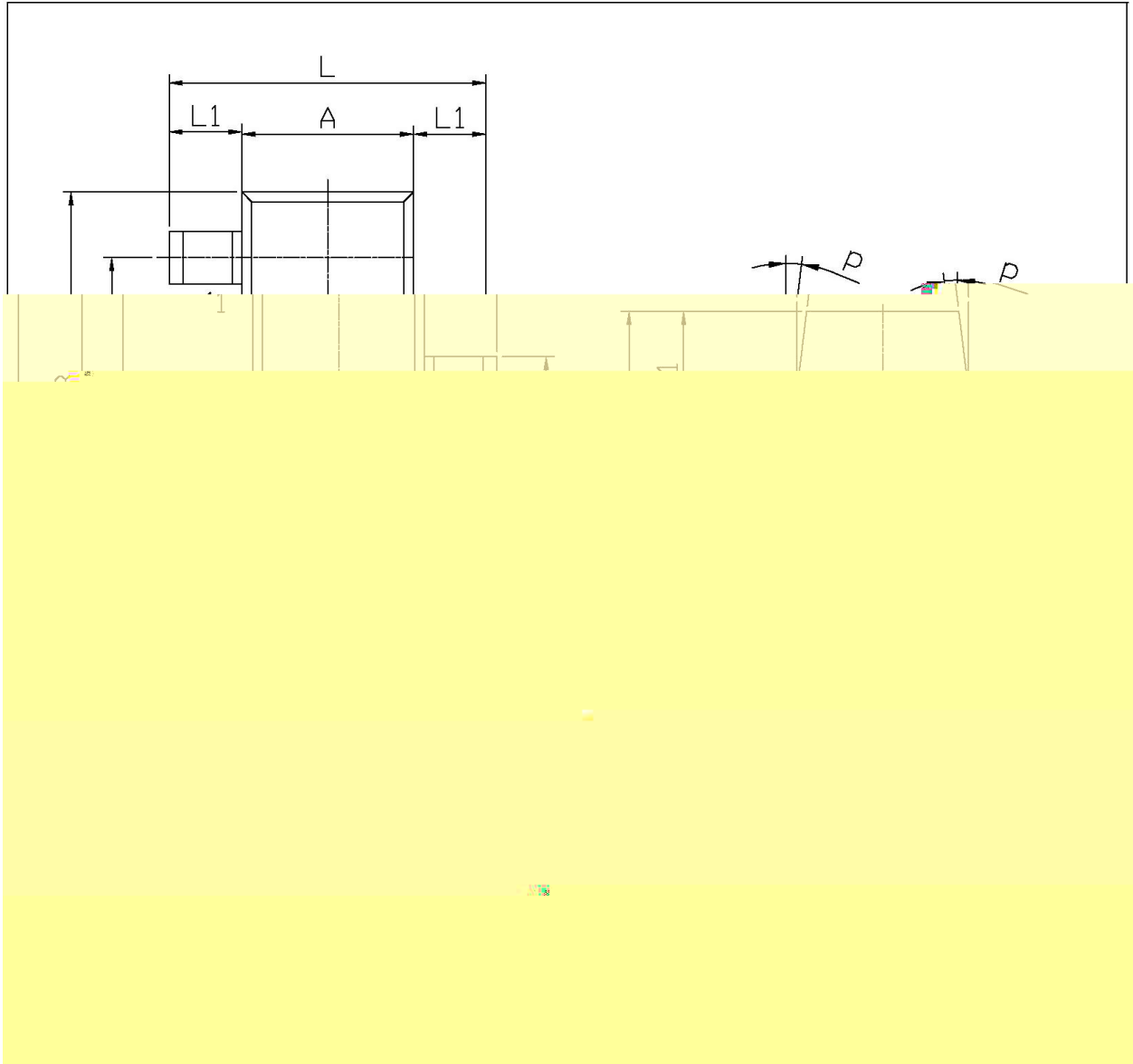

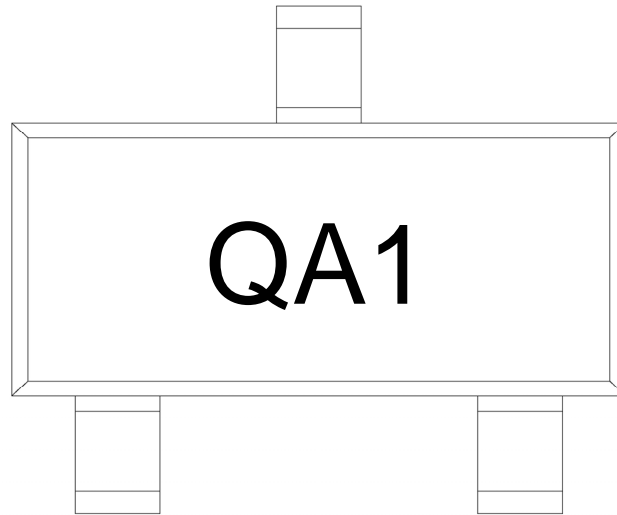

Note:

Q: Automobile halogen-free product Code

A1: Product Type

**Temperature Profile for IR Reflow Soldering(Pb-Free)**

**Note:**

- 1            150 200            60 120sec;    1.Preheating:150~200 , Time:60~120sec.
- 2            255 5                    5 0.5sec;    2.Peak Temp.:255 5 , Duration:5 0.5sec.
- 3                            2 10 /sec.            3.Cooling Speed: 2~10 /sec.

260 5                    10 1 sec.                    Temp.:260±5℃                    Time:10±1 sec

/ REEL

Package Type	Units					Dimension (unit mm <sup>3</sup> )		
	Units/Reel /	Reels/Inner Box /	Units/Inner Box /	Inner Boxes/Outer Box /	Units/Outer Box /	Reel	Inner Box	Outer Box