



/ Descriptions

/ Features

$R_{DS(on)}$

C_{rss}

/ Applications

DC/DC

/ Equivalent Circuit

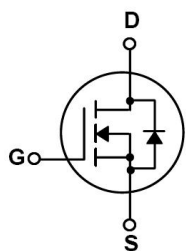

/ Pinning



/ Marking



/ Absolute Maximum Ratings(Ta=25)

参数		符号	数值	单位
		°C		
			±	
		°C		
				°C
	≤	θ		°C
		θ		

/ Electrical Characteristics(Ta=25)

参数	符号	测试条件	最小值	典型值	最大值	单位
					±	



/ Electrical Characteristics(Ta=25)

参数	符号	测试条件	最小值	典型值	最大值	单位
		Ω Ω				

/ Electrical Characteristic Curve

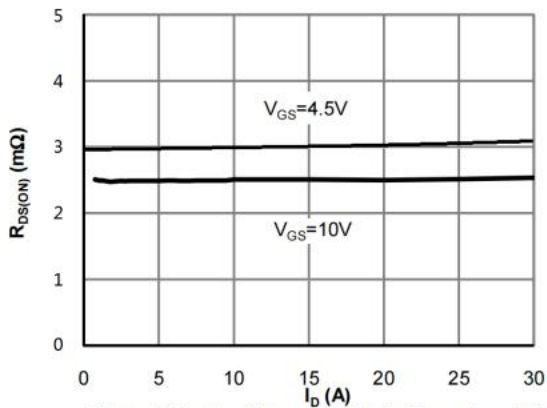
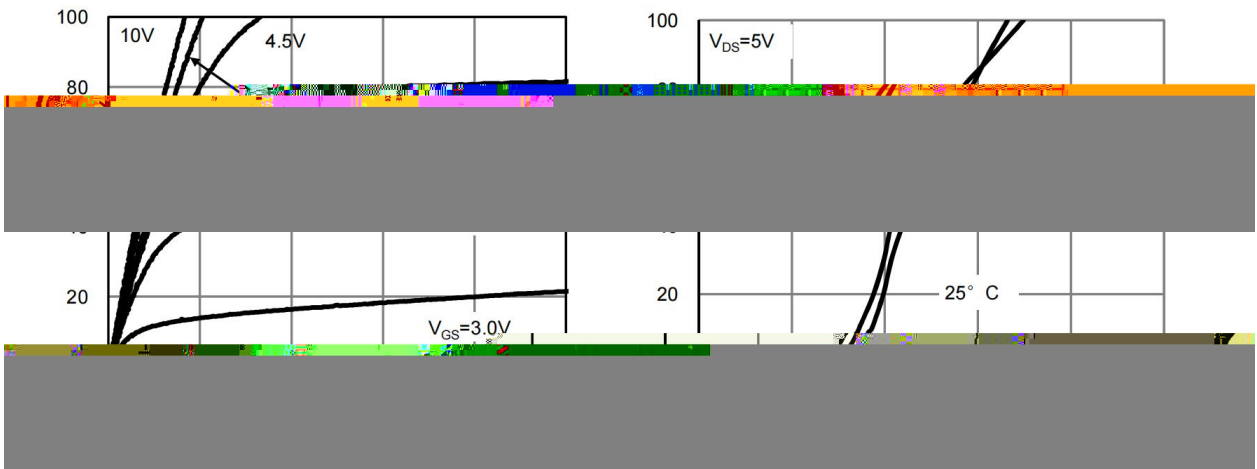

Figure 3: On-Resistance vs. Drain Current and Gate Voltage

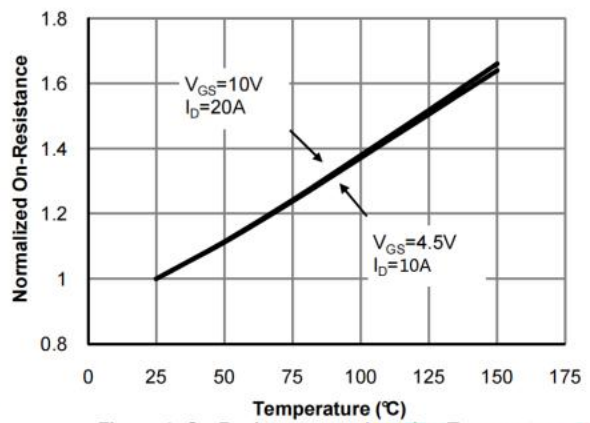
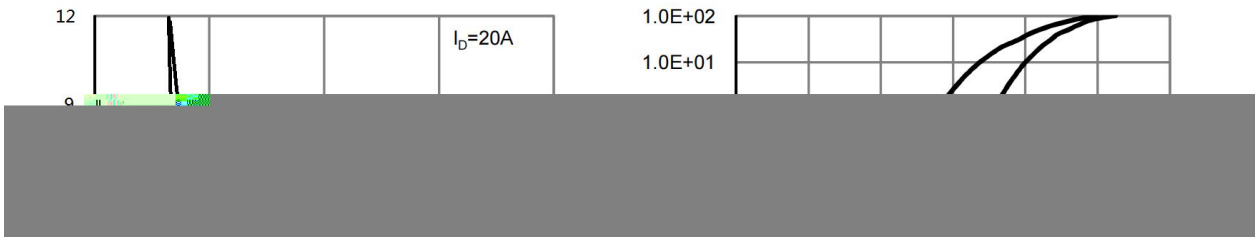
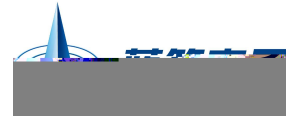

Figure 4: On-Resistance vs. Junction Temperature





/ E



/ Package Dimensions

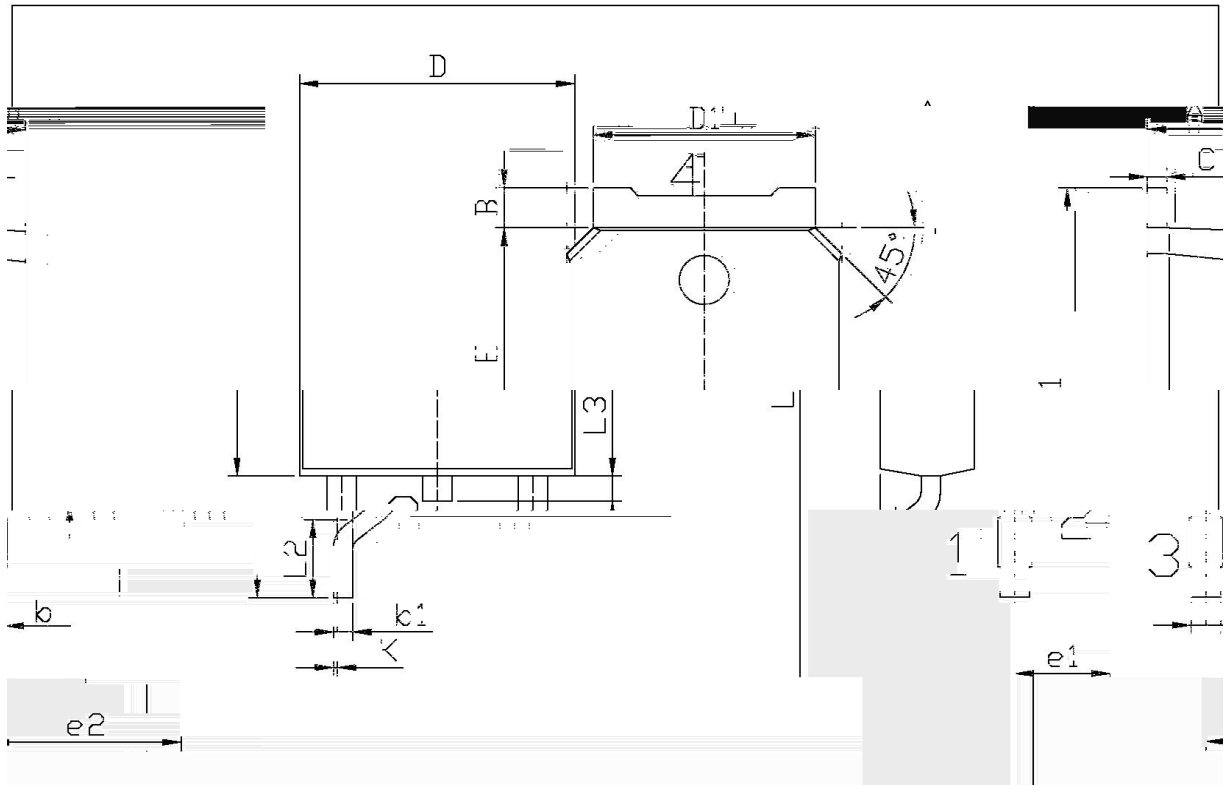

单位: mm

Dimension in Millimeters		Dimension in Millimeters	
Symbol	Max	Symbol	Max
B	0.95	e1	2.32
D	6.20	D'	3.90
L2	10.85	L3	1.10
L3	0.60	D	6.45
k	0.60	k	0.60
k1	0.55	k1	0.55

TN-252

/ Marking Instructions

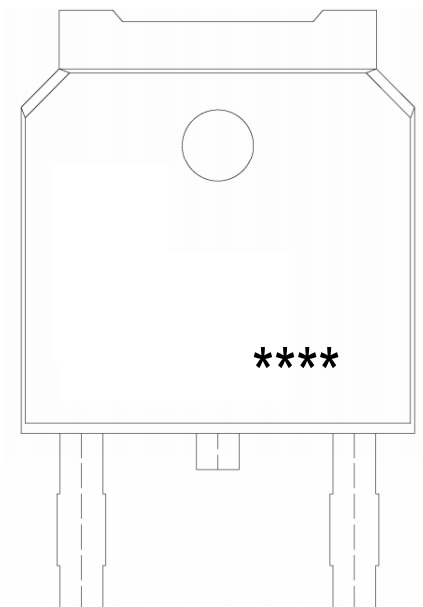

说明：

： 为公司代码

： 为型号代码

****： 为生产批号代码，随生产批号变化



() /

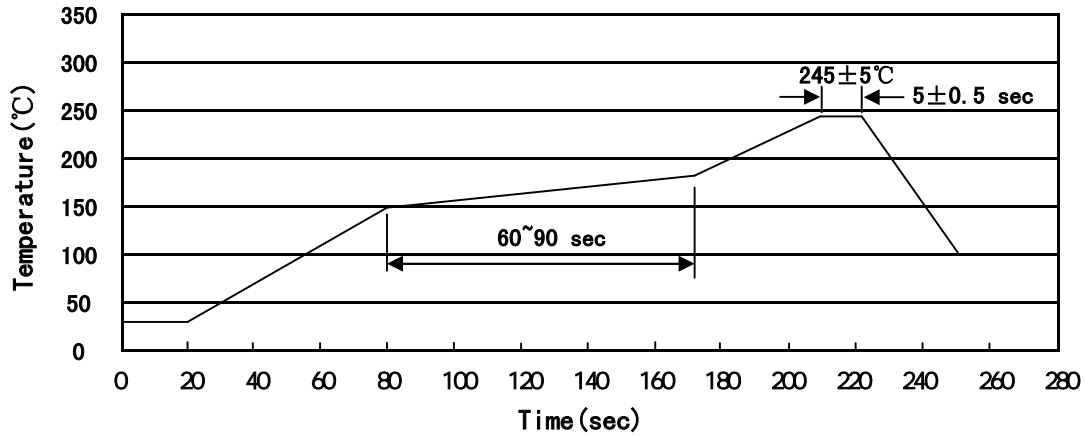

± °C ± °C ± °C ± °C

/ Resistance to Soldering Heat Test Conditions

± °C ± °C °C

/ Packaging SPEC.

						Reel	Inner Box	Outer Box
	Units/Reel 只/卷盘	Reels/Inner Box 卷盘/盒	Units/Inner Box 只/盒	Inner Boxes/Outer Box 盒/箱	Units/Outer Box 只/箱			
TO-252	2,500	2	5,000	6	30,000	13" ×16	360×360×50	380×335×366

						Tube	Inner Box	Outer Box
	Units/Tube 只/套管	Tubes/Inner Box 套管/盒	Units/Inner Box 只/盒	Inner Boxes/Outer Box 盒/箱	Units/Outer Box 只/箱			
TO-251/252	75	48	3,600	5	18,000	526×20.5×5.25	555×164×50	575×290×180

/ Notices