

/ Descriptions

/ Features

/ Applications

DC/DC

/ Equivalent Circuit

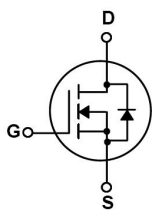

/ Pinning



/ h_{FE} Classifications & Marking

/ Absolute Maximum Ratings(Ta=25)

			°C

/ Electrical Characteristics(Ta=25)

			μ			
						μ
		°C				μ
			μ			

/ Electrical Characteristics(Ta=25)

						Ω
		Ω				

/ Electrical Characteristic Curve

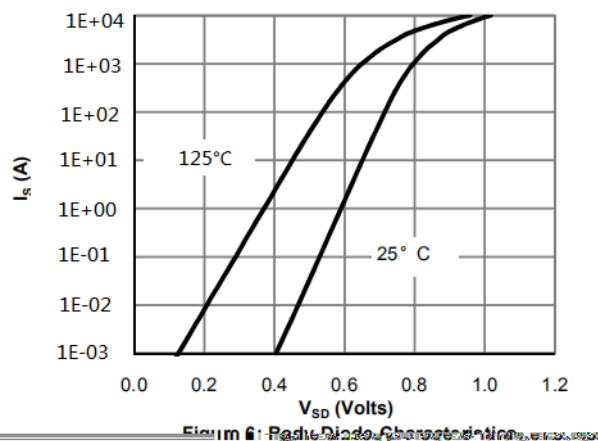
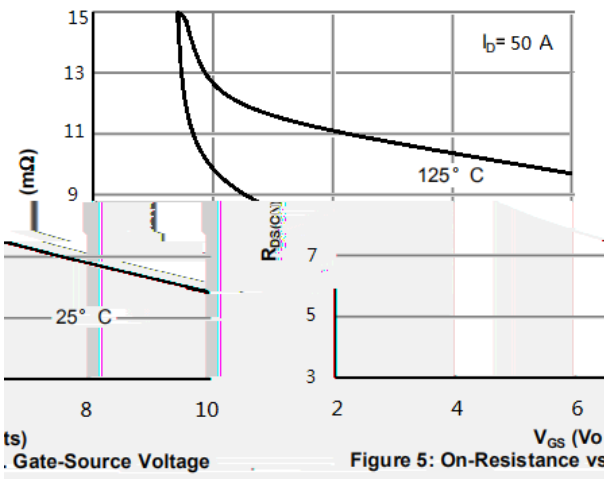
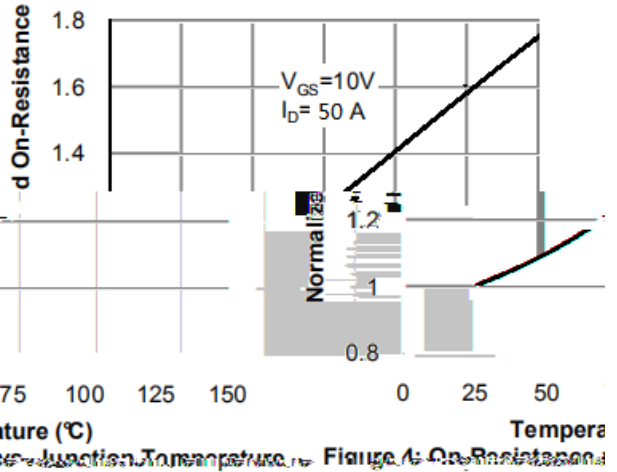
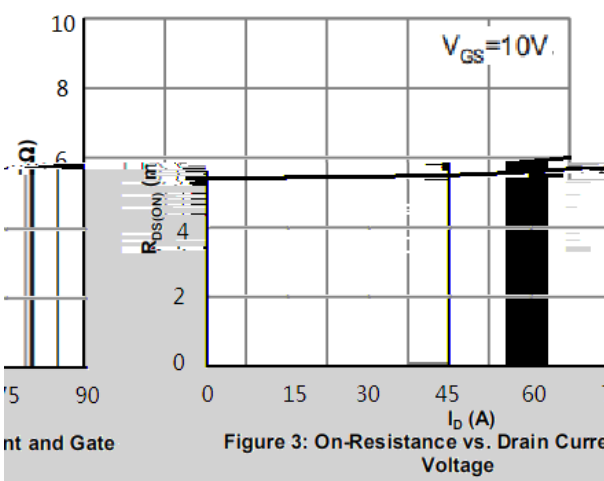
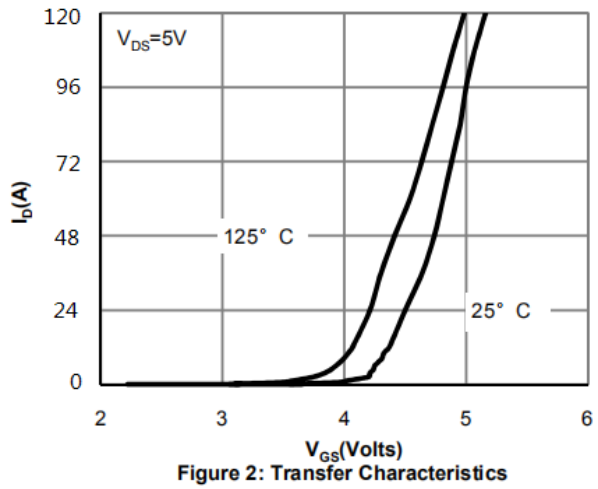
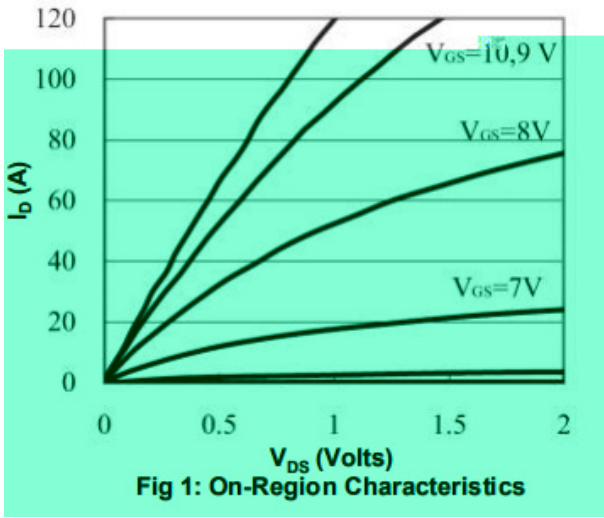

/ Electrical Characteristic Curve

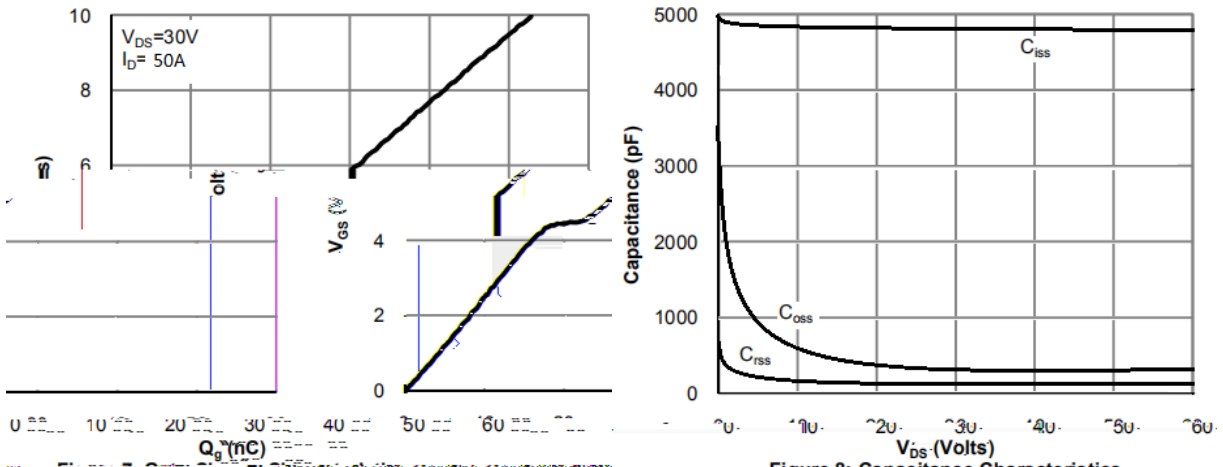

Figure 8: Capacitance Characteristics

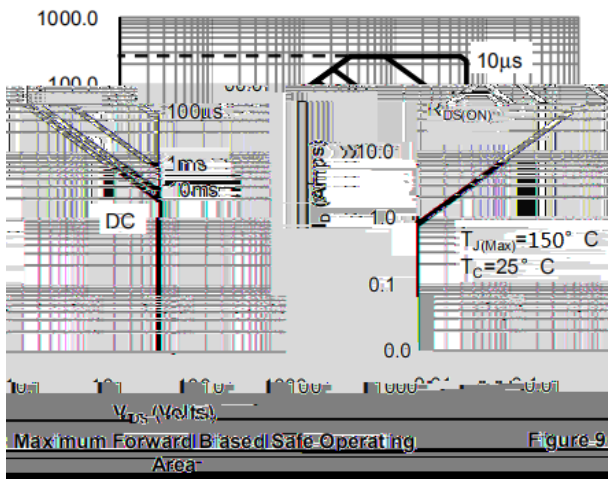

Figure 9:

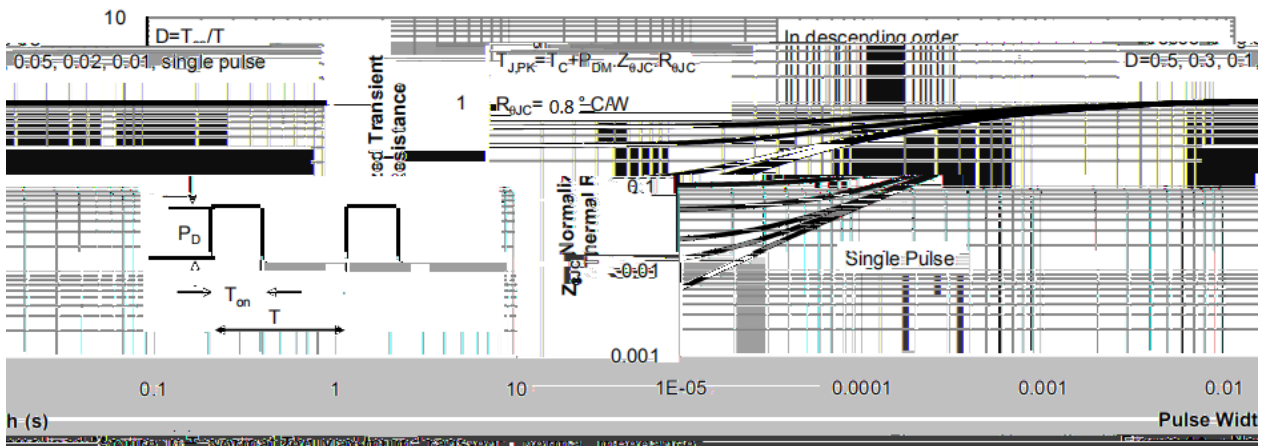
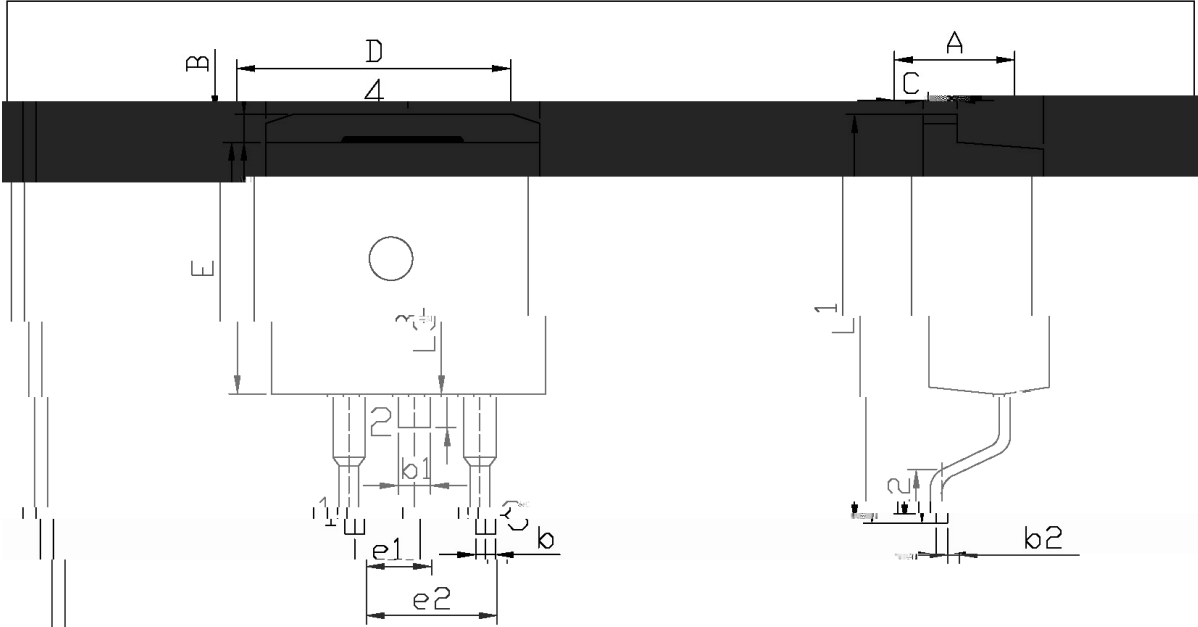

Figure 10: Normalized Maximum Transient Thermal Impedance

/ Package Dimensions



单位: mm

Symbol	Dimensions In Millimeters		Symbol	Dimensions In Millimeters	
	Min	Max		Min	Max
A	4.30	4.70	E	9.00	9.40
B	1.00	1.40	e1	2.34	2.74

/ Marking Instructions

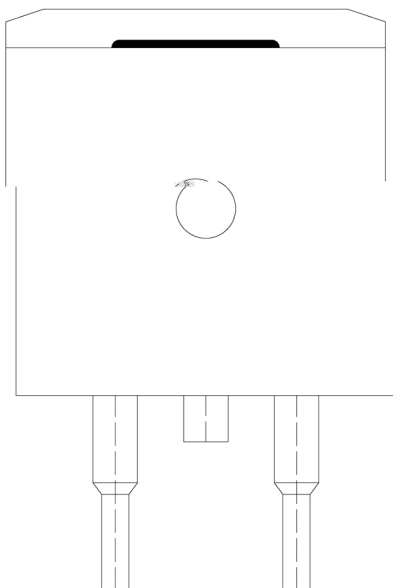

100N06

() / Temperature Profile for IR Reflow Soldering(Pb-Free)

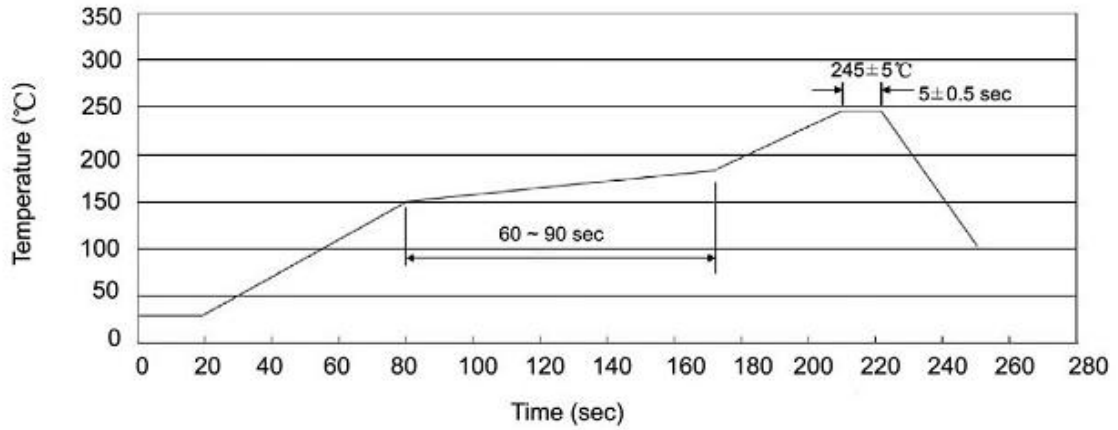

± ± ± ±

/ Resistance to Soldering Heat Test Conditions

± ± °C



封装形式	包装数量					包装尺寸 :		
	只卷盘	卷盘盒	只盒	盒箱	只箱	盒	箱	

封装形式	包装数量					包装尺寸 :		
	只套管	套管盒	只盒	盒箱	只箱	套管	盒	箱