

DFN1006-2L

ESD

μ

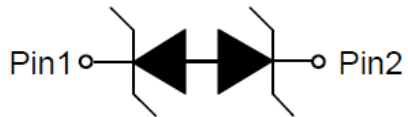



μ			
μ			
		\pm	
		\pm	

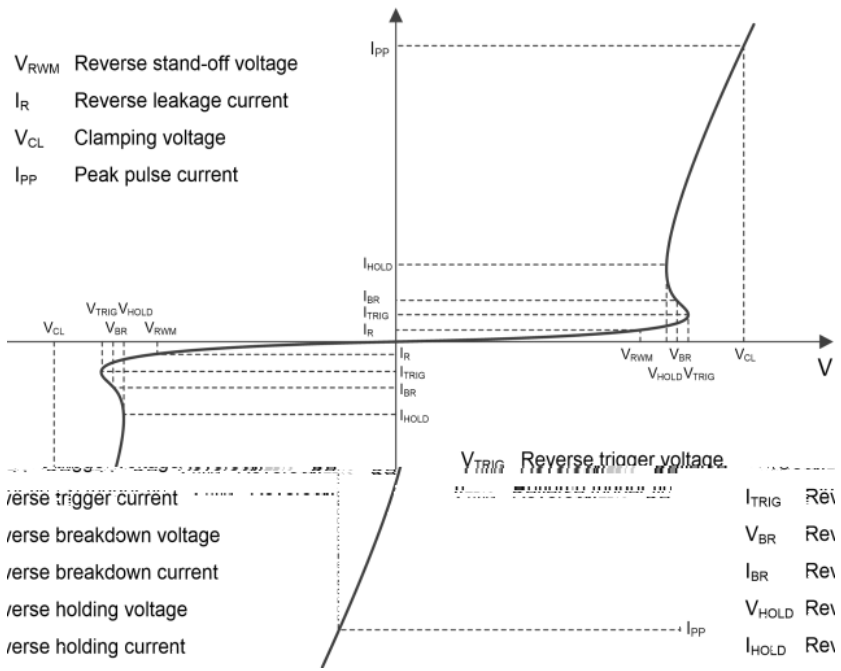

							Ω
				μ			
				μ			

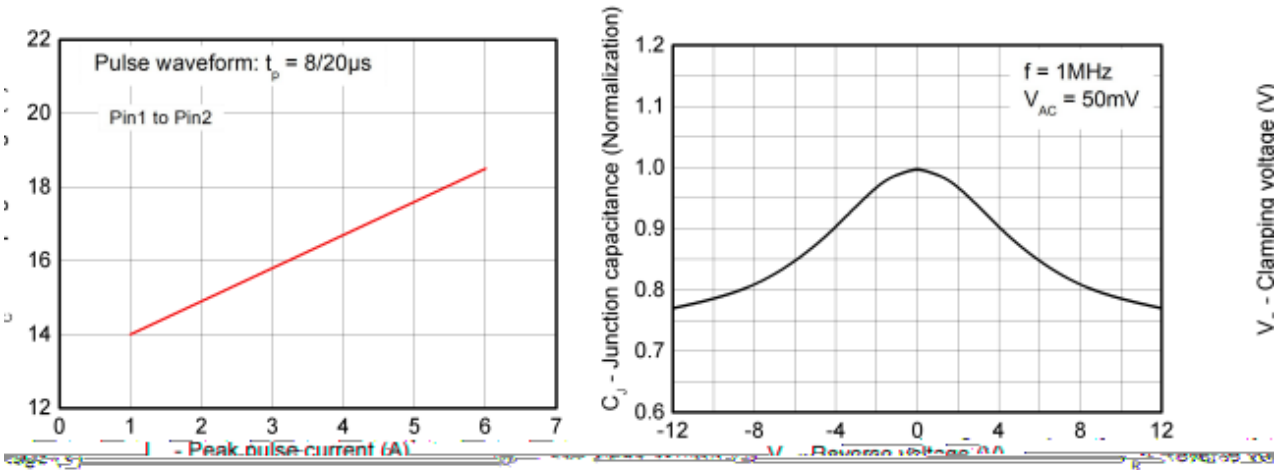
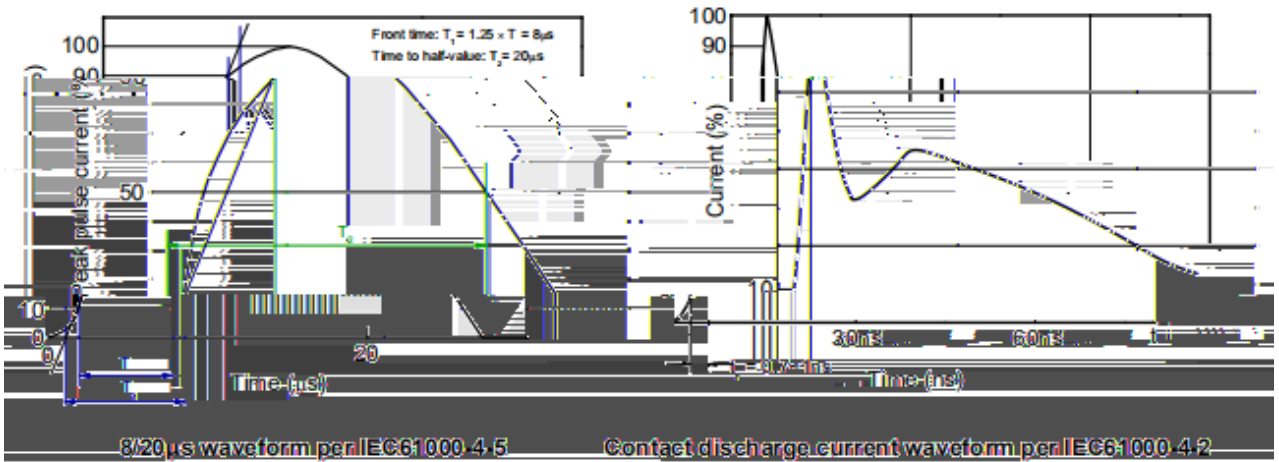

Reverse voltage

Clamping voltage vs. Peak pulse current

Capacitance vs. f

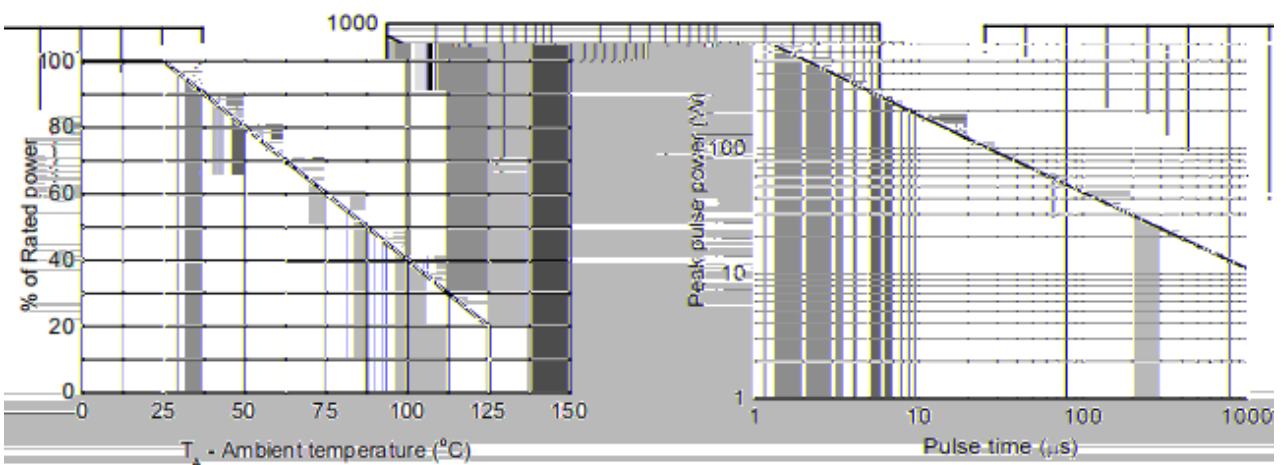

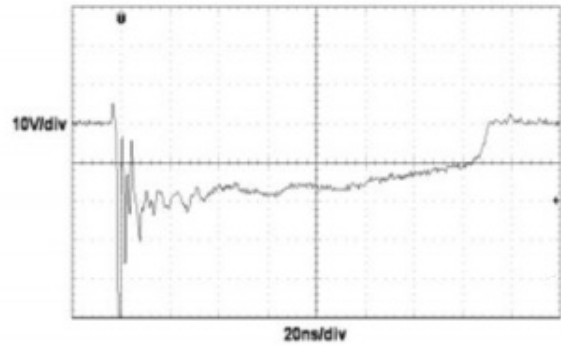
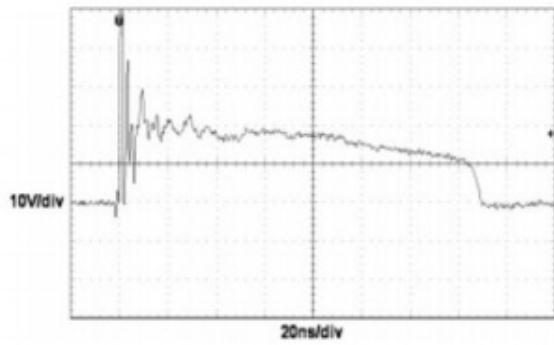

ESD clamping (+8kV contact discharge per IEC 61000-4-2) ESD clamping (-8kV contact discharge per IEC 61000-4-2)

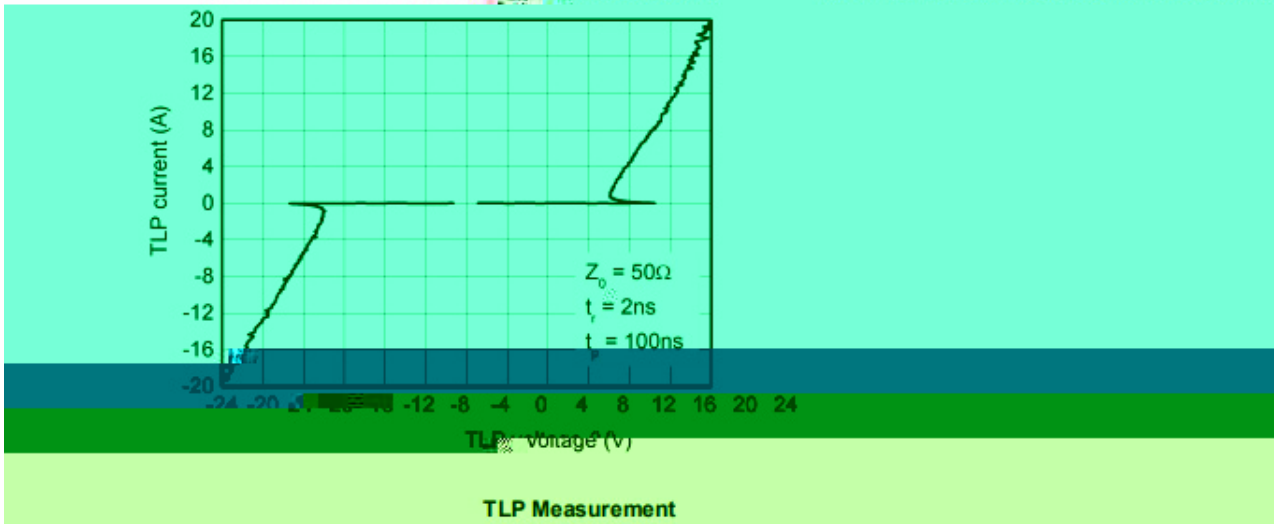

DFN1006-2L

Unit:mm

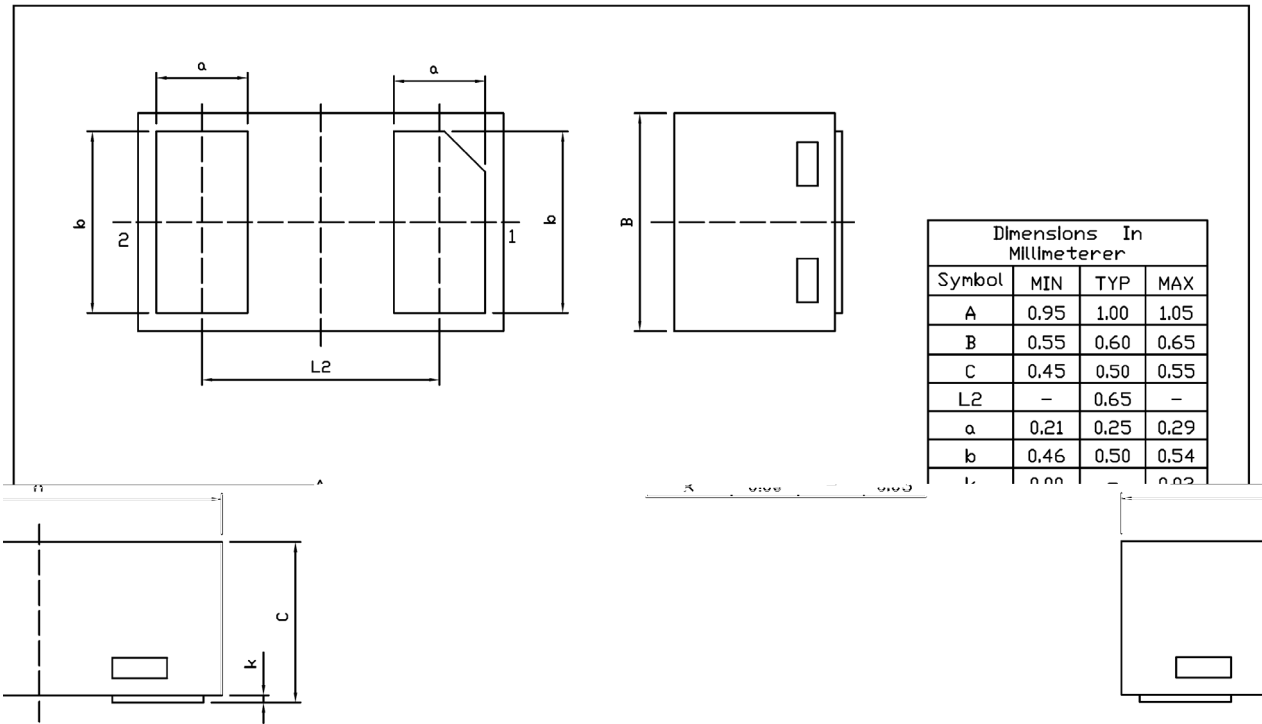

Dimensions In Millimeter			
Symbol	MIN	TYP	MAX
A	0.95	1.00	1.05
B	0.55	0.60	0.65
C	0.45	0.50	0.55
L2	-	0.65	-
a	0.21	0.25	0.29
b	0.46	0.50	0.54
k	0.20	-	0.22



cD

