

**/ Descriptions**

**/ Features**

**/ Applications**

DC/DC

**/ Equivalent Circuit**

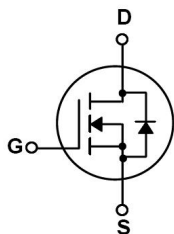

**/ Pinning**

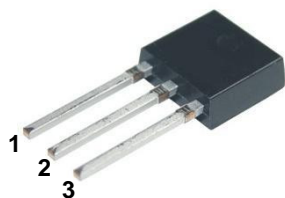

**/ h<sub>FE</sub> Classifications & Marking**

**/ Absolute Maximum Ratings(Ta=25 )**

		°C	
		°C	
		°C	

**/ Electrical Characteristics(Ta=25 )**

			μ			
						μ
			°C			μ
						μ
			μ			
						Ω
			Ω			

/ Electrical Characteristic Curve

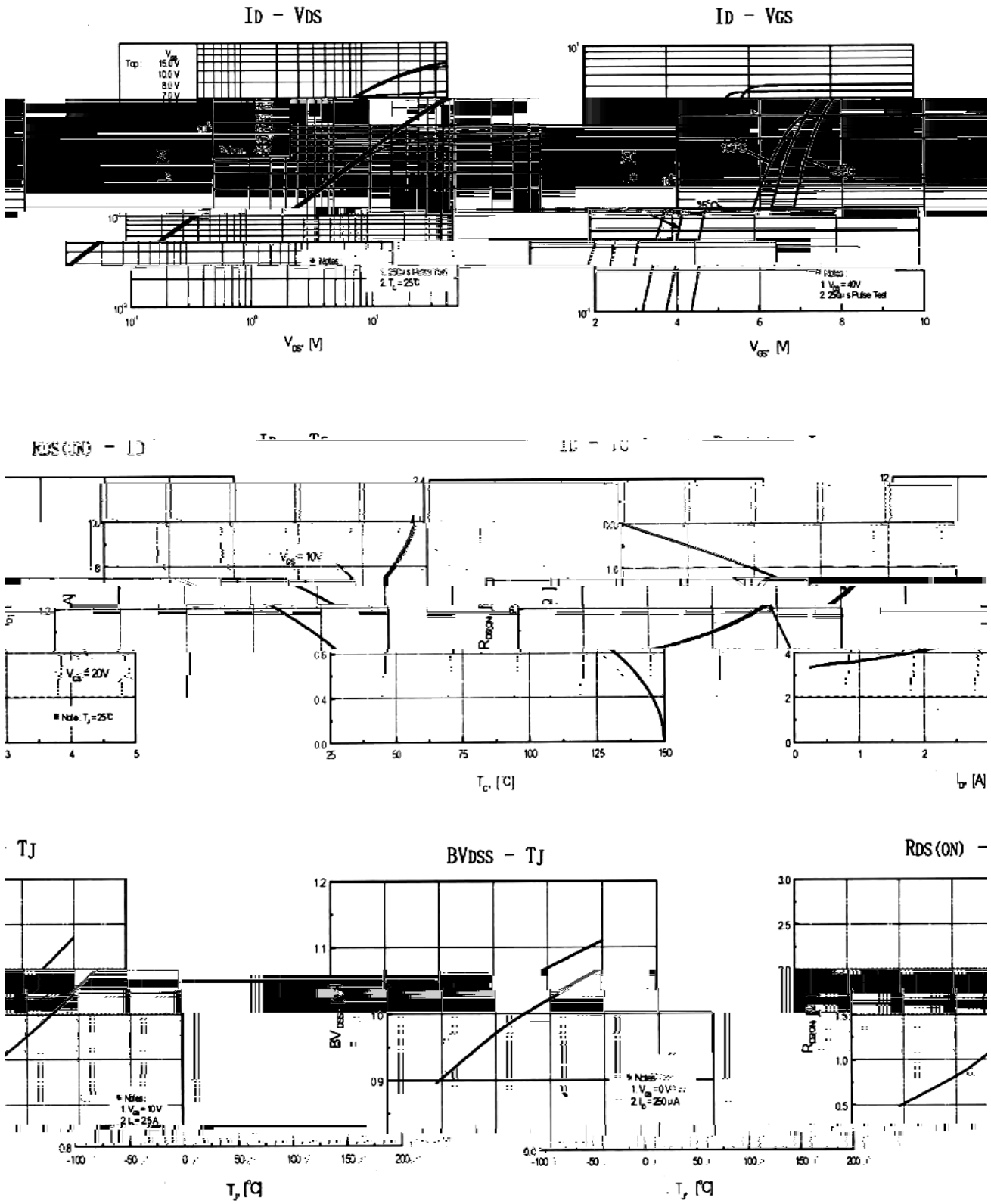

/ Package Dimensions

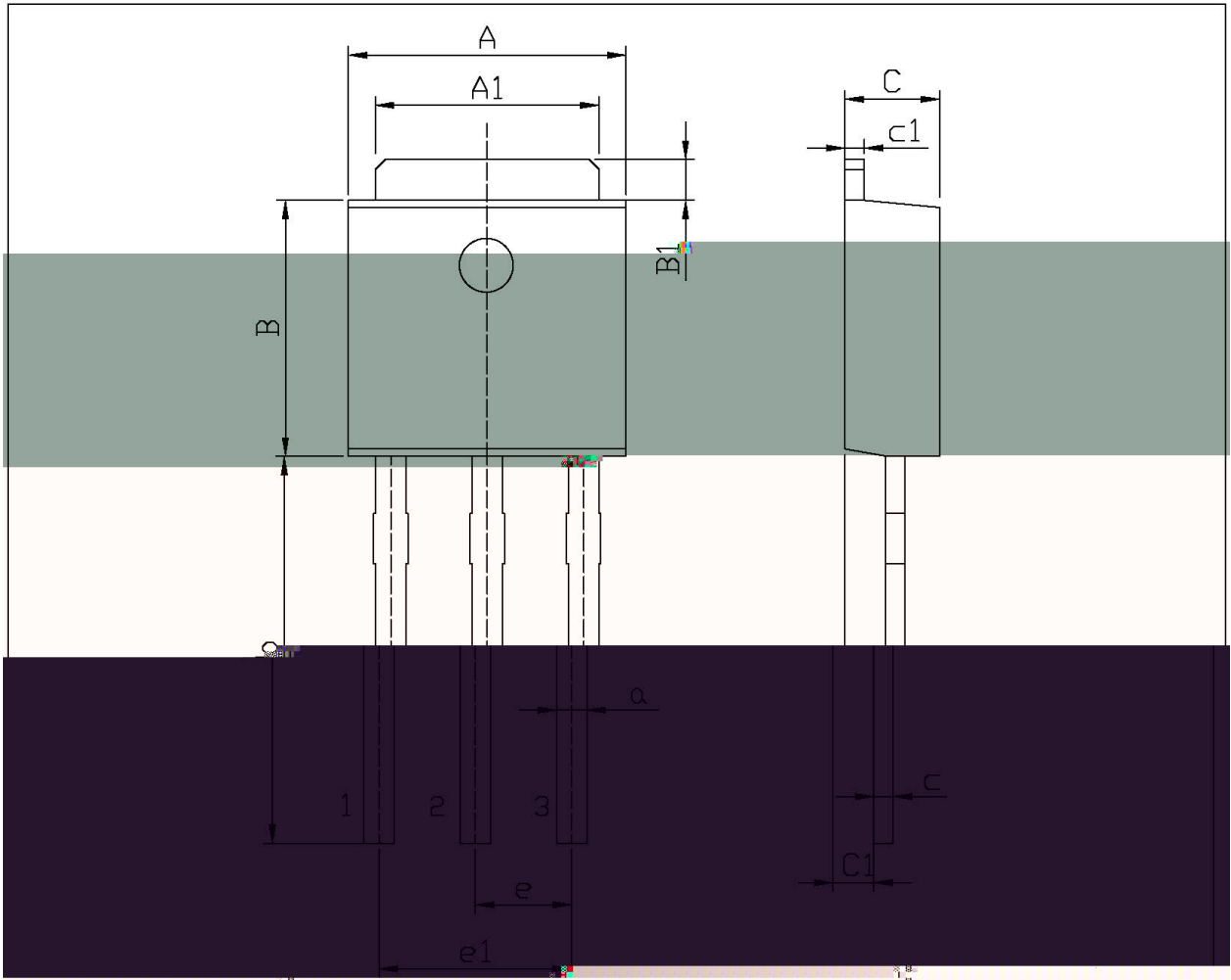

單位: mm

Dimensions In Millimeters			Symbol	Dimensions In Millimeters		Symbol
Min	Max	Min		Max		
6.45	6.75	a	0.50	0.70	a	
5.10	5.50	b	9.00	9.40	A1	
5.95	6.35	C	0.45	0.55	B1	
0.95	1.25	c1	0.45	0.55	B1	

/ Marking Instructions

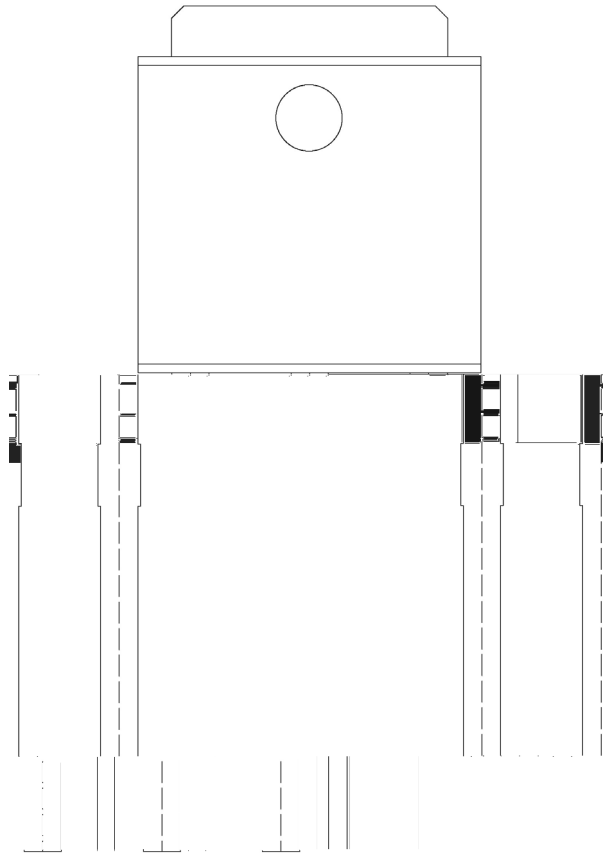

2N 60

\*\*\*\*

( ) / Temperature Profile for Dip Soldering(Pb-Free)

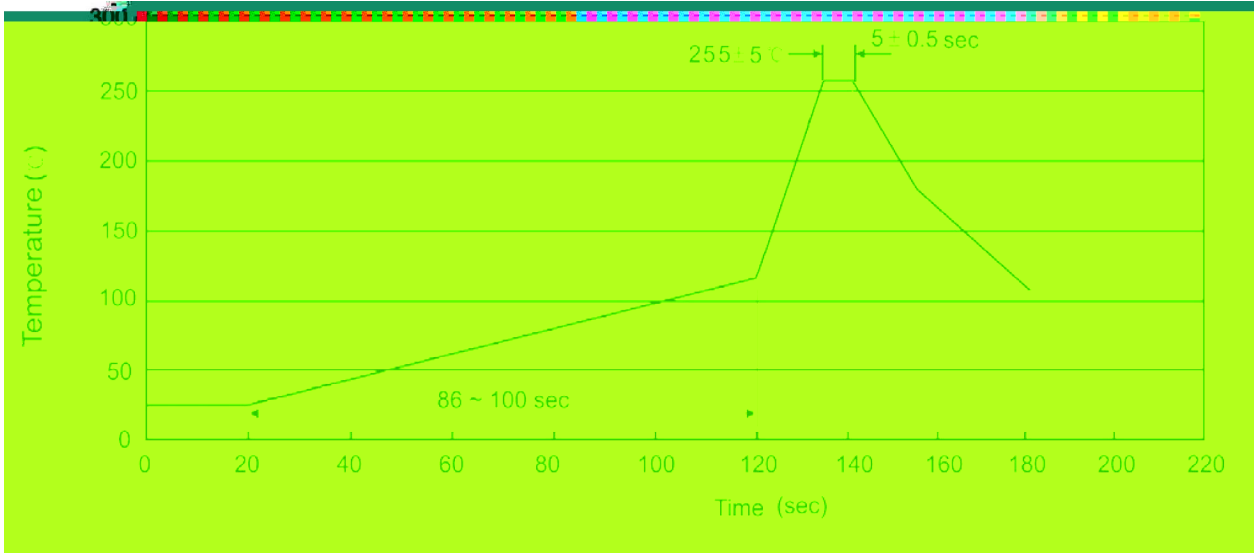

± ± ± ±

/ Resistance to Soldering Heat Test Conditions

± ±

/ Packaging SPEC.

封装形式	包装数量					包装尺寸 :		
	只袋	袋盒	只盒	盒箱	只箱	袋	盒	箱

封装形式	包装数量					包装尺寸 :		
	只套管	套管盒	只盒	盒箱	只箱	套管	盒	箱

/ Notices