

/ Descriptions

TO-220AC

/ Features

/ Applications

UPS

/ Equivalent Circuit

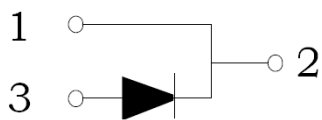

/ Pinning

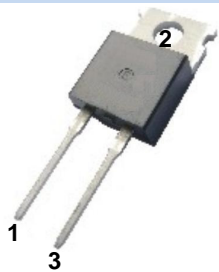

/ h_{FE} Classifications & Marking

/ Electrical Characteristic Curve

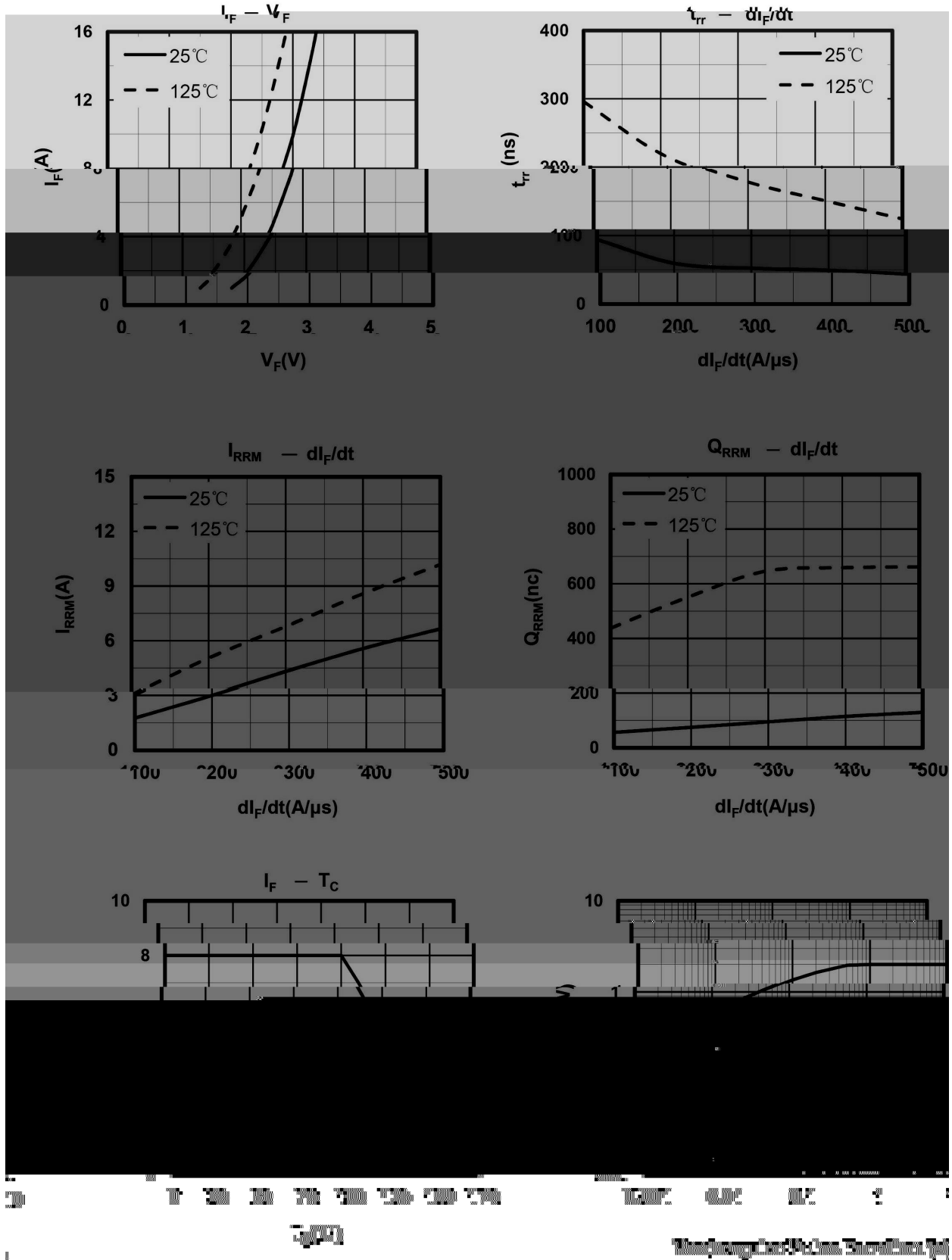

/ Package Dimensions

TO-220AC

Unit:mm

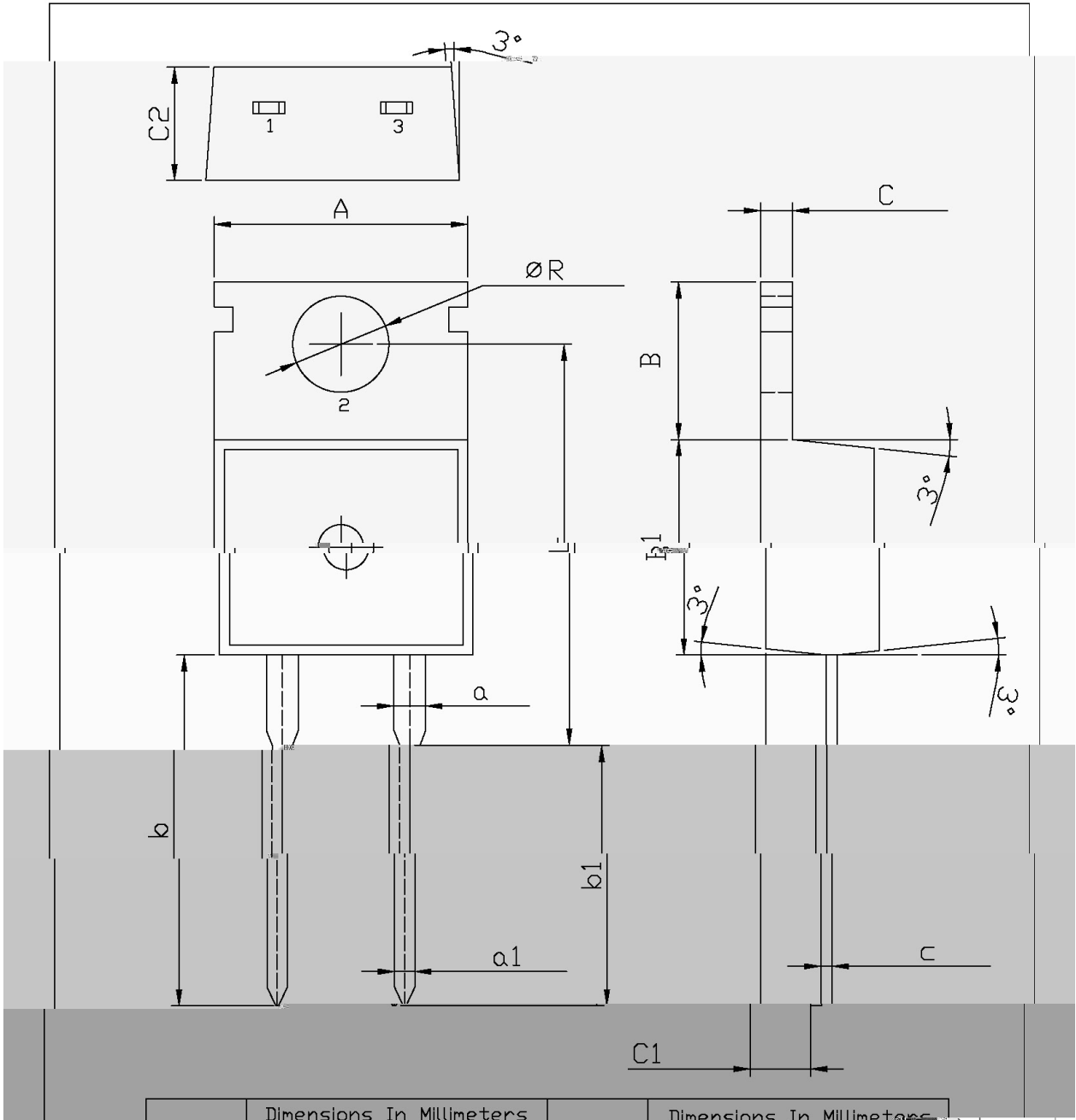

Dimensions In Millimeters			Dimensions In Millimeters		
Symbol	Min	Max	Symbol	Min	Max
A ₁	9.8	10.2	B	6.3	6.7
R	3.56	3.64	B1	9.0	9.4

/ Marking Instructions

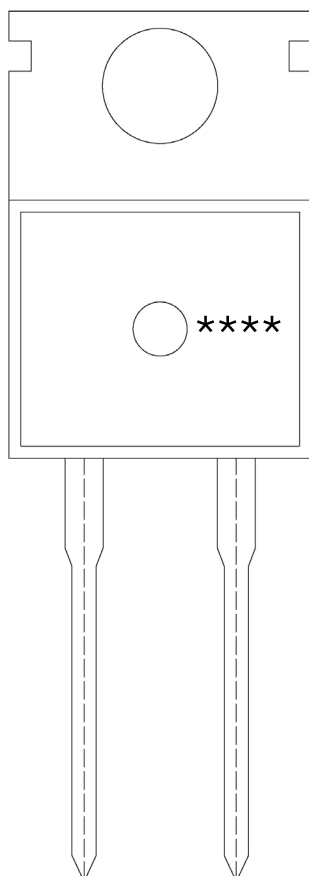

BR

MUR08120

() / Temperature Profile for Dip Soldering(Pb-Free)

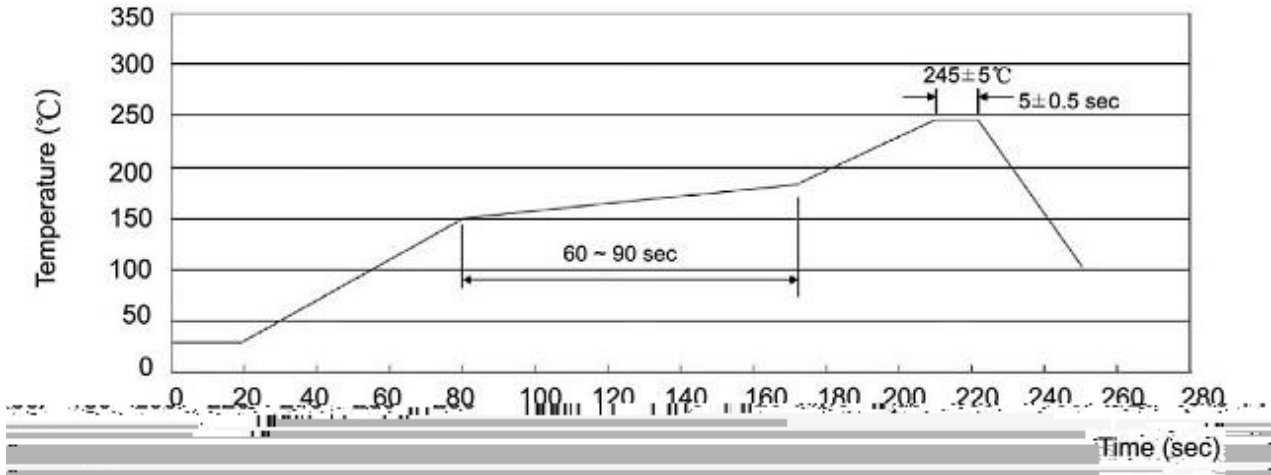

± ± ± ±

/ Resistance to Soldering Heat Test Conditions

± ±

/ Packaging SPEC.

	Units/Bag /	Bags/Inner Box /	Units/Inner Box /	Inner Boxes/Outer Box /	Units/Outer Box /	Bag	Inner Box	Outer Box
TO-220/F/AC	200	10	2,000	5	10,000	135×190	237×172×102	560×245×195

	Units/Tube /	Tubes/Inner Box /	Units/Inner Box /	Inner Boxes/Outer Box /	Units/Outer Box /	Tube	Inner Box	Outer Box
TO-220/F/AC	50	20	1,000	5	5,000	532×31.4×5.5	555×164×50	575×290×180

/ Notices