



**/ Absolute Maximum Ratings(Ta=25 )**

Parameter	Symbol	Rating	Unit
Forward Voltage ( I <sub>F</sub> =10mA)	V <sub>F</sub>	0.9	V
Power Dissipation	P <sub>D</sub>	200	mW
Typical Thermal Resistance Junction to Ambient	R <sub>θJA</sub>	833	°C/W
Junction and Storage Temperature Range	T <sub>j</sub> , T <sub>stg</sub>	-55~150	°C

**/ Electrical Characteristics(Ta=25 )**

Type Number	Marking Code	Zener Voltage Range(Note 1)				Maximum Zener Impedance			Maximum Reverse Current	
		V <sub>Z</sub> @I <sub>ZT</sub>			I <sub>ZT</sub>	Z <sub>ZT</sub> @I <sub>ZT</sub>	Z <sub>ZK</sub> @I <sub>ZK</sub>	I <sub>ZK</sub>	I <sub>R</sub> @V <sub>R</sub>	V <sub>R</sub>
		Min (V)	Nom (V)	Max (V)	(mA)	Max (Ω)		(mA)	Max (μA)	(V)
BZX584C2V4	Z7	2.3	2.4	2.5	5	100	1000	1	120	1
BZX584C2V7	A8	2.6	2.7	2.8	5	100	1000	1	120	1
BZX584C3V0	B8	2.9	3	3.2	5	100	1000	1	50	1
BZX584C3V3	C8	3.1	3.3	3.5	5	95	1000	1	20	1
BZX584C3V6	D8	3.4	3.6	3.8	5	90	1000	1	10	1
BZX584C3V9	E8	3.7	3.9	4.1	5	90	1000	1	5	1
BZX584C4V3	F8	4.1	4.3	4.5	5	90	1000	1	5	1
BZX584C4V7	G8	4.5	4.7	4.9	5	80	800	1	2	1
BZX584C5V1	H8	4.8	5.1	5.4	5	60	500	1	2	1.5
BZX584C5V6	I8	5.3	5.6	5.9	5	40	200	1	1	2.5
BZX584C6V2	J8	5.9	6.2	6.5	5	10	100	1	1	3
BZX584C6V8	K8	6.5	6.8	7.1	5	15	160	1	0.5	3.5
BZX584C7V5	L8	7.1	7.5	7.9	5	15	160	1	0.5	4
BZX584C8V2	M8	7.8	8.2	8.6	5	15	160	1	0.5	5
BZX584C9V1	N8	8.6	9.1	9.6	5	15	160	1	0.5	6
BZX584C10	O8	9.5	10	10.5	5	20	160	1	0.1	7

**/ Electrical Characteristics(Ta=25 )**

Type Number	Marking Code	Zener Voltage Range(Note 1)				Maximum Zener Impedance			Maximum Reverse Current	
		V <sub>z</sub> @ I <sub>ZT</sub>			I <sub>ZT</sub>	Z <sub>ZT</sub> @I <sub>ZT</sub>	Z <sub>ZK</sub> @I <sub>ZK</sub>	I <sub>ZK</sub>	I <sub>R</sub> @V <sub>R</sub>	V <sub>R</sub>
		Min (V)	Nom (V)	Max (V)	(mA)	Max (Ω)		(mA)	Max (μA)	(V)
BZX584C11	P8	10.5	11	11.6	5	20	160	1	0.1	8
BZX584C12	Q8	11.4	12	12.6	5	25	80	1	0.1	9
BZX584C13	R8	12.6	13.25	13.9	5	30	80	1	0.1	10
BZX584C15	S8	14.3	15	15.8	5	30	80	1	0.1	11
BZX584C16	T8	15.4	16.2	17.0	2	40	80	1	0.1	12
BZX584C18	U8	17.1	18	18.9	2	45	80	1	0.1	13
BZX584C20	V8	19.0	20	21.0	2	55	100	1	0.1	15
BZX584C22	W8	20.9	22	23.1	2	55	100	1	0.1	17
BZX584C24	X8	23.0	24.2	25.4	2	70	120	1	0.1	19
BZX584C27	Y8	25.7	27	28.4	2	80	300	1	0.1	21
BZX584C30	Z8	28.5	30	31.5	2	80	300	1	0.1	23
BZX584C33	A9	31.4	33	34.7	2	80	300	1	0.1	25
BZX584C36	B9	34.2	36	37.8	2	90	500	1	0.1	27
BZX584C39	C9	37.1	39	41.0	2	130	500	1	2	30

Notes:

- (1) V<sub>ZT</sub> is tested with pulses (20 ms)
- (2) C:±5%

**/ Electrical Characteristic Curve**

**Fig.1 Maximum Continuous Power Derating**

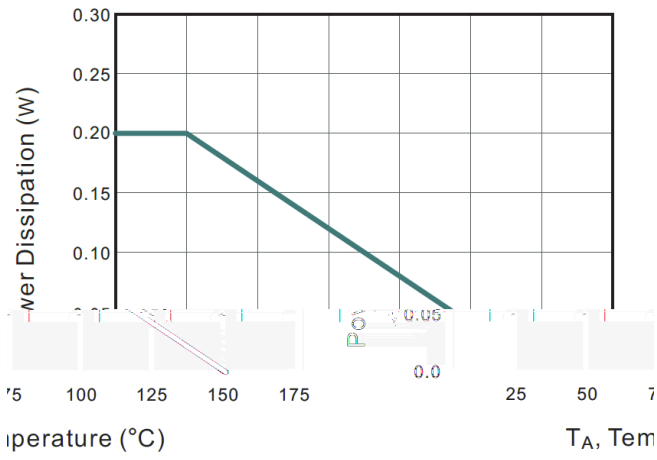

**/ Package Dimensions**

SOD-523

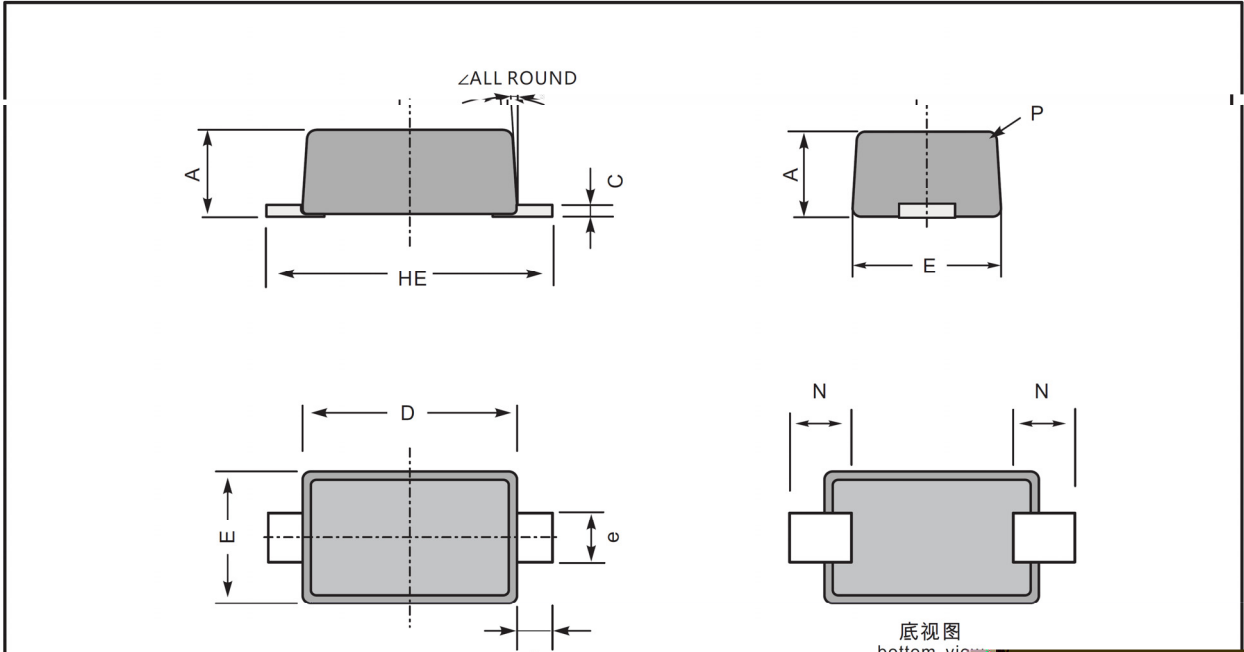

UNIT		A	e	C	D	E	HE	N	L	P	∠
mm	max	0.77	0.35	0.15	1.30	0.99	1.70	0.35 ref.	0.2 ref.	R0.1 ALL ROUND	10° ±1°
	min.	0.51	0.25	0.08	1.10	0.75	1.50				
mil	max	30	14	6	51	39	67	14 ref.	8.0 ref.	R4.0 ALL ROUND	
	min	20	10	3	43	30	59				

/ Marking Instructions

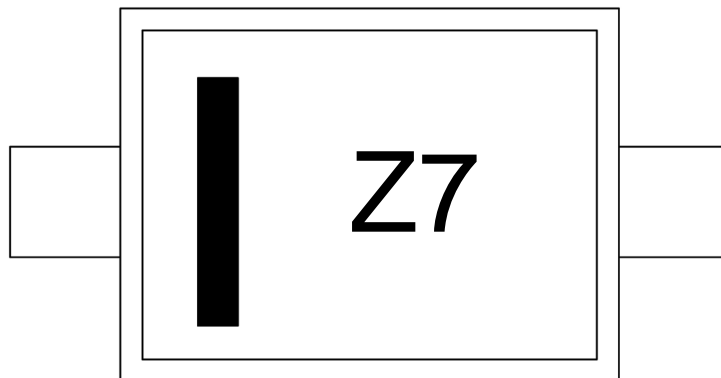

Note:

Z7: Product Type Code

( ) /

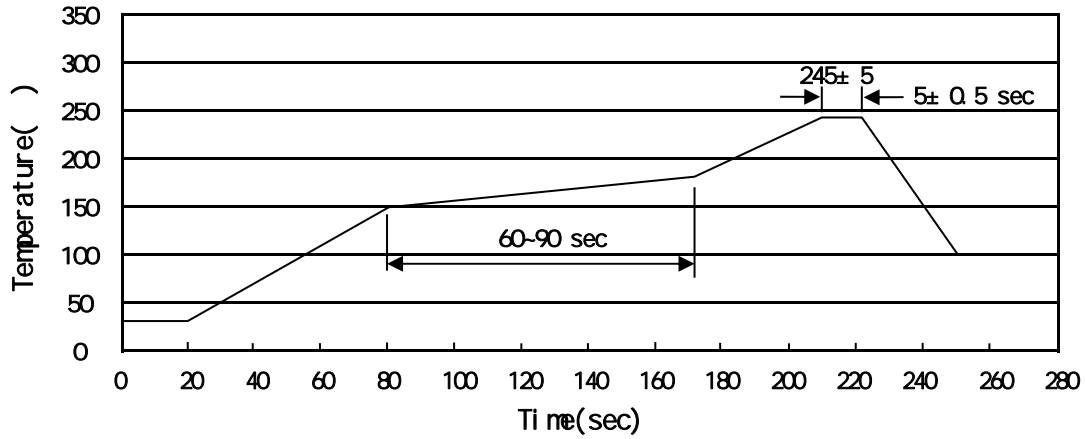

Note:

- |   |     |     |    |          |   |
|---|-----|-----|----|----------|---|
| 1 | 150 | 180 | 60 | 90sec;   | 1.Preheating:150~180 , Time:60~90sec.   |
| 2 | 245 | 5   | 5  | 0.5sec;  | 2.Peak Temp.:245 5 , Duration:5 0.5sec. |
| 3 |     |     | 2  | 10 /sec. | 3. Cooling Speed: 2~10 /sec.            |

/ Resistance to Soldering Heat Test Conditions

260 ±5                      10 ±1 sec.                      Temp.:260±5                      Time:10±1 sec

/ Packaging SPEC.

/ REEL

Package Type	Units					Dimension (unit mm <sup>3</sup> )		
	Units/Reel	Reels/Inner Box	Units/Inner Box	Inner Boxes/Outer Box	Units/Outer Box	Reel	Inner Box	Outer Box
SOD-523	3,000	10	30,000	6	180,000	7" x8	180x120x180	390x385x205

/ Notices