

Rev. H Oct.-2018

TO-220 NPN Silicon NPN transistor in a TO-220 Plastic Package.

V_{CE0}
 High collector-Emitter voltage, current-Gain-Bandwidth product.

Color TV chroma output.

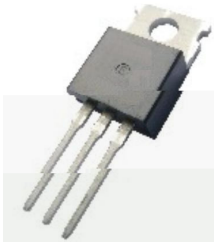

PIN1 Base PIN 2 Collector PIN 3 Emitter

h_{FE} Classifications Symbol	R	O	Y
h_{FE} Range	40 80	70 140	120 240

Parameter	Symbol	Rating	Unit
Collector to Base Voltage	V_{CBO}	300	V
Collector to Emitter Voltage	V_{CEO}	300	V
Emitter to Base Voltage	V_{EBO}	7.0	V
Collector Current - Continuous	I_C	200	mA
Collector Power Dissipation	P_C	15	W
Junction Temperature	T_j	150	
Storage Temperature Range	T_{stg}	-55 150	

Parameter	Symbol	Test Conditions	Min	Typ	Max	Unit
Collector to Base Breakdown Voltage	V_{CBO}	$I_C=10\mu A$ $I_E=0$	300			V
Collector to Emitter Breakdown Voltage	V_{CEO}	$I_C=10mA$ $I_B=0$	300			V
Emitter to Base Breakdown Voltage	V_{EBO}	$I_E=-10\mu A$ $I_C=0$	7.0			V
Collector Cut-Off Current	I_{CBO}	$V_{CB}=200V$ $I_E=0$			100	μA
DC Current Gain	h_{FE}	$V_{CE}=10V$ $I_C=10mA$	40		240	
Collector to Emitter Saturation Voltage	$V_{CE(sat)}$	$I_C=50mA$ $I_B=5.0mA$			2.0	V
Transition Frequency	f_T	$V_{CE}=30V$ $I_C=10mA$	40	80		MHz
Collector output capacitance	C_{ob}	$V_{CB}=50V$ $f=1.0MHz$ $I_E=0$		4.0		pF

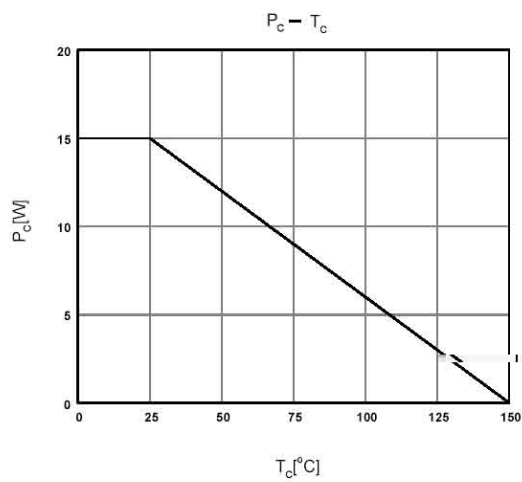
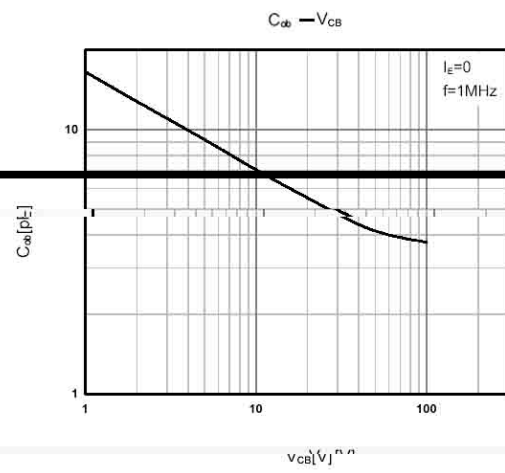
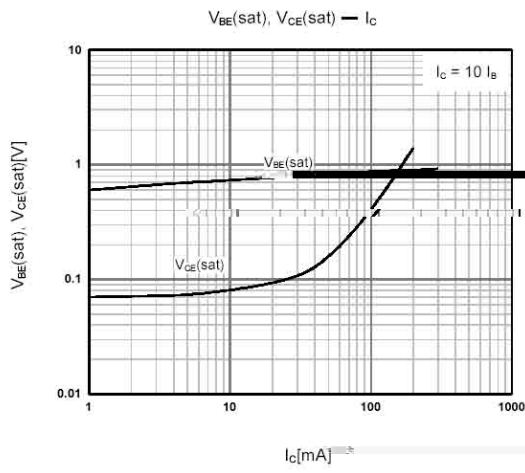
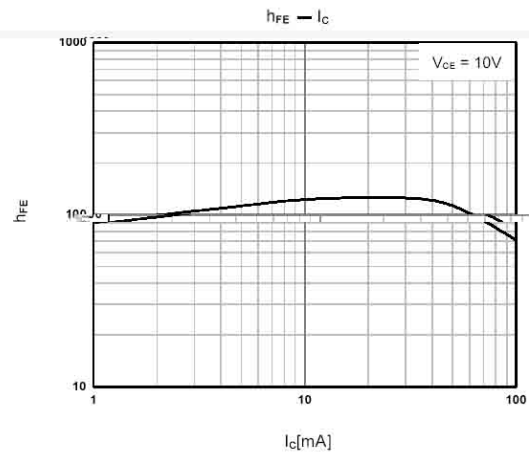
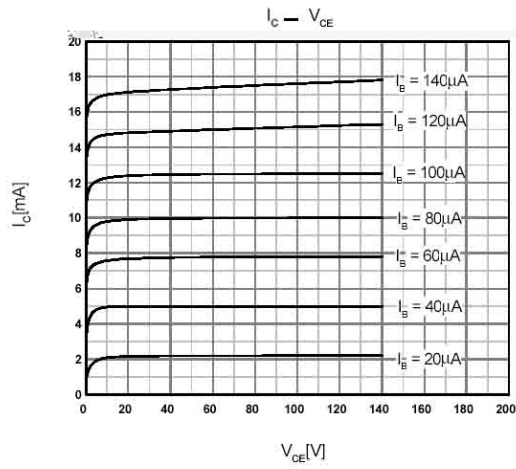

单位: mm

TO-220

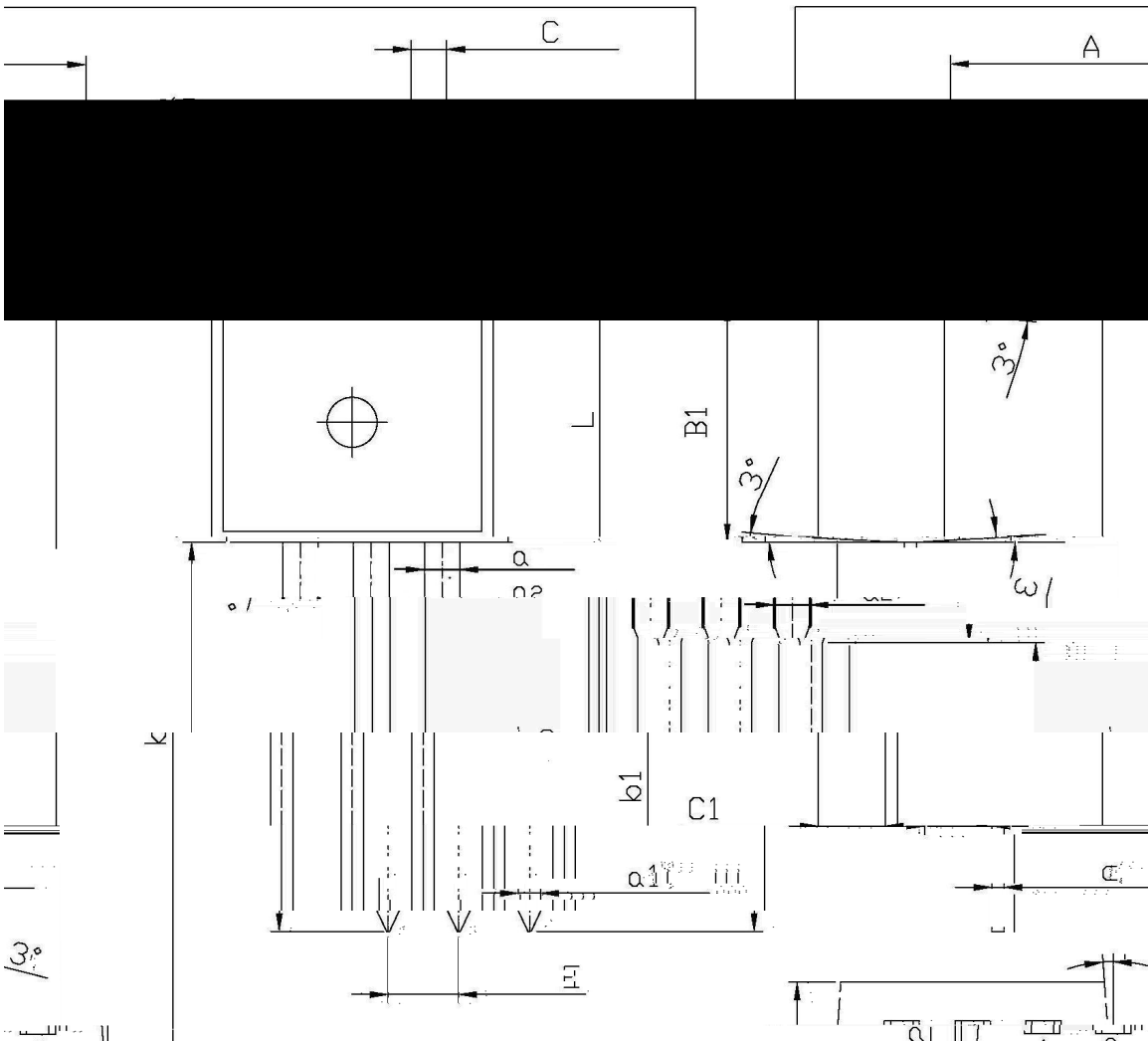

Symbol	Dimensions in Millimeters		Symbol	Dimensions in Millimeters	
	Min	Max		Min	Max
A	9.8	10.2	C	1.2	1.4
B	6.5	7.6	B1	9.0	9.4
b1	12.6	13.6	C1	2.2	2.6
a	1.22	1.32	c	0.4	0.6
a2	1.25	1.45			

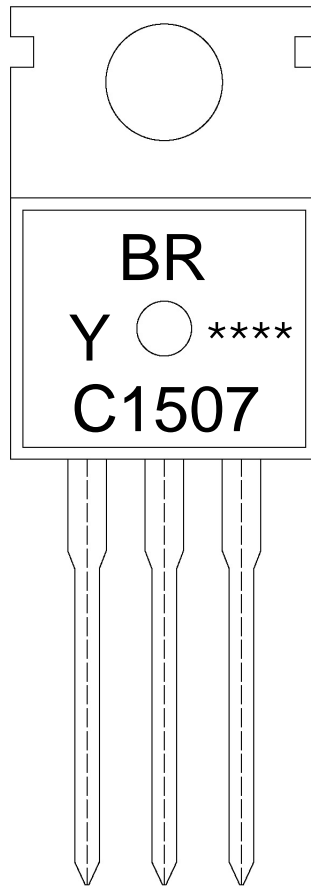

BR

C1507

Y: h_{FE}

Note:

BR: Company Code

C1507: Product Type.

Y: h_{FE} Classifications Symbol

****: Lot No. Code, code change with Lot No.

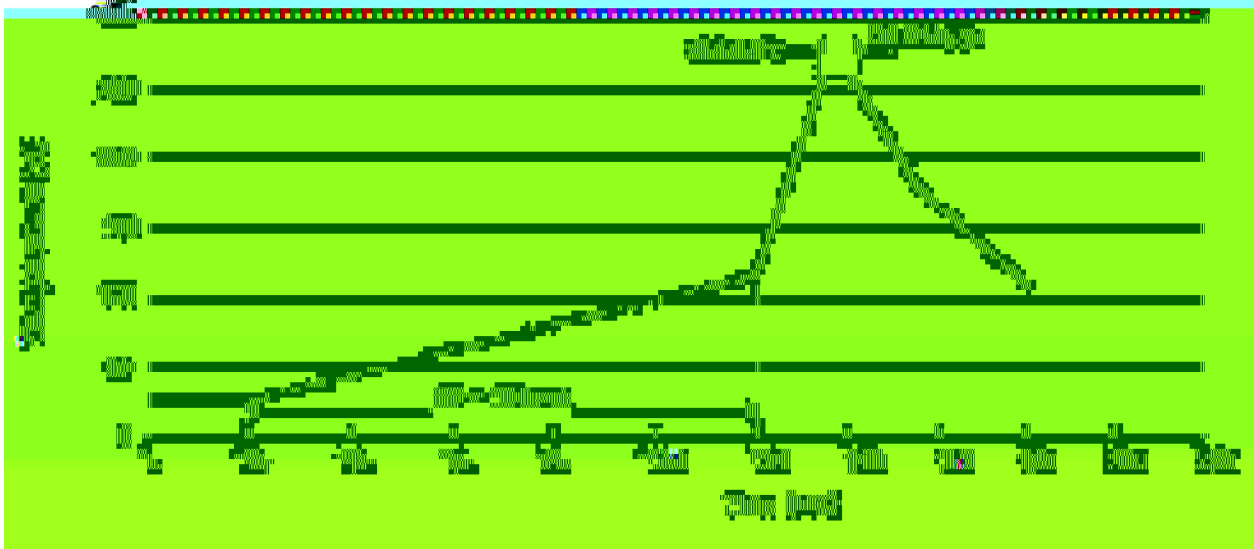
Note:

- | | | | |
|---|--------|-----------|---|
| 1 | 25 150 | 60 90sec; | 1.Preheating:25~150 , Time:60~90sec. |
| 2 | 255±5 | 5±0.5sec; | 2.Peak Temp.:255±5 , Duration:5±0.5sec. |
| 3 | 2 10 | /sec. | 3. Cooling Speed: 2~10 /sec. |

270±5

10±1 sec.

Temp.:270±5

Time:10±1 sec

/ BULK

Package Type 封装形式	Units 包装数量					Dimension 包装尺寸 (unit: mm ³)		
	Units/Bag 只/袋	Bags/Inner Box 袋/盒	Units/Inner Box 只/盒	Inner Boxes/Outer Box 盒/箱	Units/Outer Box 只/箱	Bag 袋	Inner Box 盒	Outer Box 箱
TO-220/F	200	10	2,000	5	10,000	135×190	237×172×102	560×245×195