

# LV10100DCT

Rev.F May.-2016

TO-252

Schottky Diode in a TO-252 Plastic Package.

Low forward voltage drop,low power losses,High efficiency operation,High cost performance.

# LV10100DCT

Rev.F May.-2016

| Parameter  | Symbol                             | Rating  | Unit |
|--|------------------------------------|---------|------|
| Peak Repetitive Reverse Voltage<br>Working Peak Reverse Voltage<br>DC Blocking Voltage | $V_{RRM}$<br>$V_{RWM}$<br>$V_{RM}$ | 100     | V    |
| RMS Voltage  | $V_{RMS}$                          | 70      | V    |
| Average Rectified Forward Current  | $I_{F(AV)}$                        | 2X5     | A    |
| Non Repetitive Peak Surge Current  | $I_{FSM}$                          | 80      | A    |
| Typical Thermal Resistance Junction to Case  | $R_{\theta Jc}$                    | 2.8     | /W   |
| Junction and Storage Temperature Range   | $T_j T_{stg}$                      | -40~150 |      |

| Parameter       | Symbol   | Test Conditions            | Min | Typ  | Max | Unit |
|-----------------|----------|----------------------------|-----|------|-----|------|
| Reverse Voltage | $V_{BR}$ | $I_R=1mA$ $T_a=25^\circ C$ | 100 |      |     | V    |
|                 |          | $I_F=3A$ $T_a=25^\circ C$  |     | 0.59 |     | V    |

Forward Voltage  $V_F$

**/ Electrical Characteristic Curve**

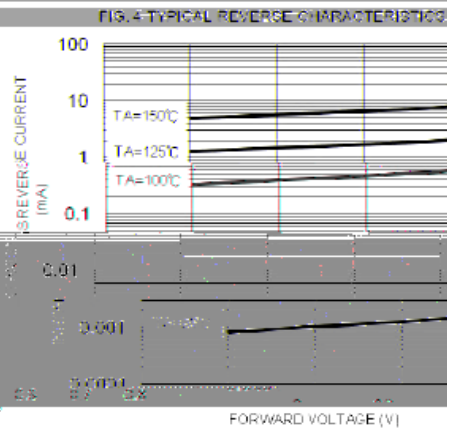
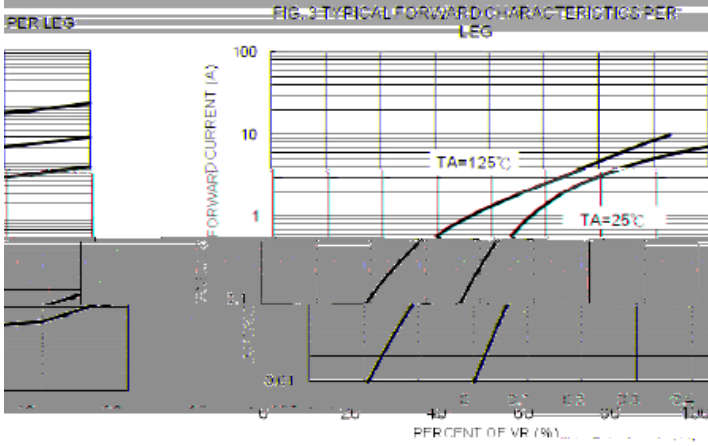
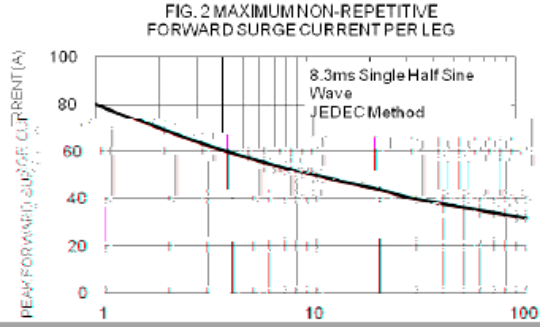
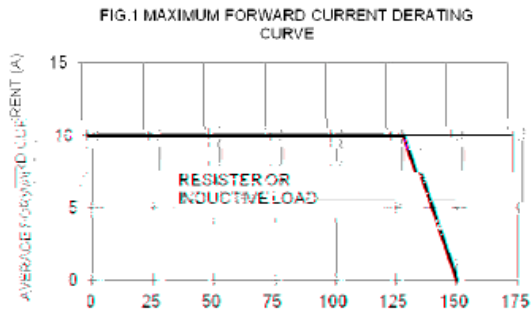

/ Package Dimensions

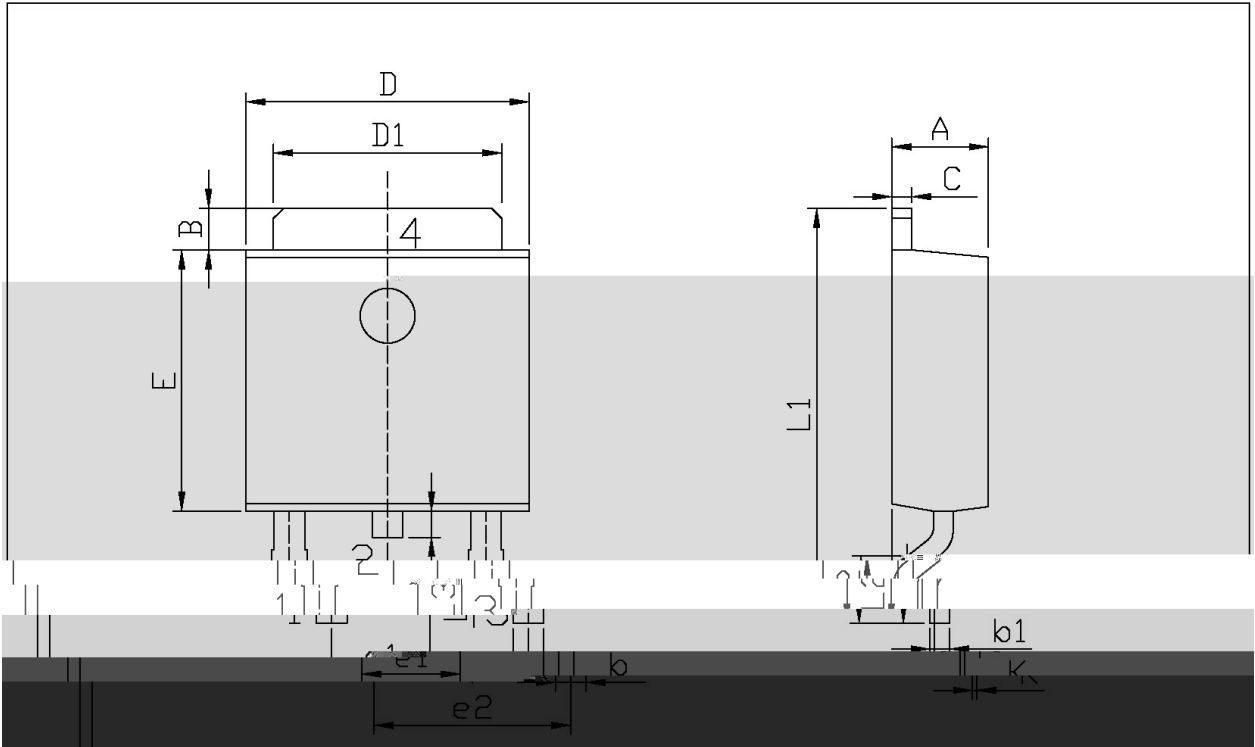

单位: mm

| Symbol | Dimensions In Millimeters |      | Symbol | Dimensions In Millimeters |      |
|--------|---------------------------|------|--------|---------------------------|------|
|        | Min                       | Max  |        | Min                       | Max  |
| A      | 2.20                      | 2.40 | E      | 5.95                      | 6.25 |
| B      | 0.95                      | 1.25 | e1     | 2.24                      | 2.34 |
| b      | 0.50                      | 0.70 | e2     | 4.43                      | 4.73 |
| b1     | 0.45                      | 0.55 | L1     | 0.95                      | 0.95 |
| C      | 0.45                      | 0.55 | L2     | 1.25                      | 1.7  |
| D      | 6.45                      | 6.75 | L3     | 0.60                      | 0.60 |
| D1     | 5.10                      | 5.50 | K      | 0.00                      | 0.00 |

TO-252

/ Marking Instructions

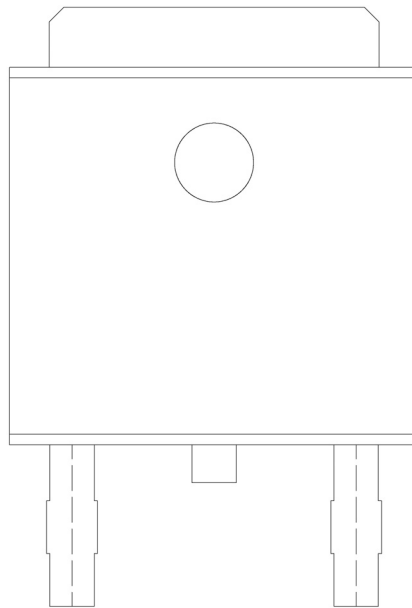

BR

LV10100

CT:

\*\*\*\*

Note:

BR:                   Company Code

LV10100

( ) /

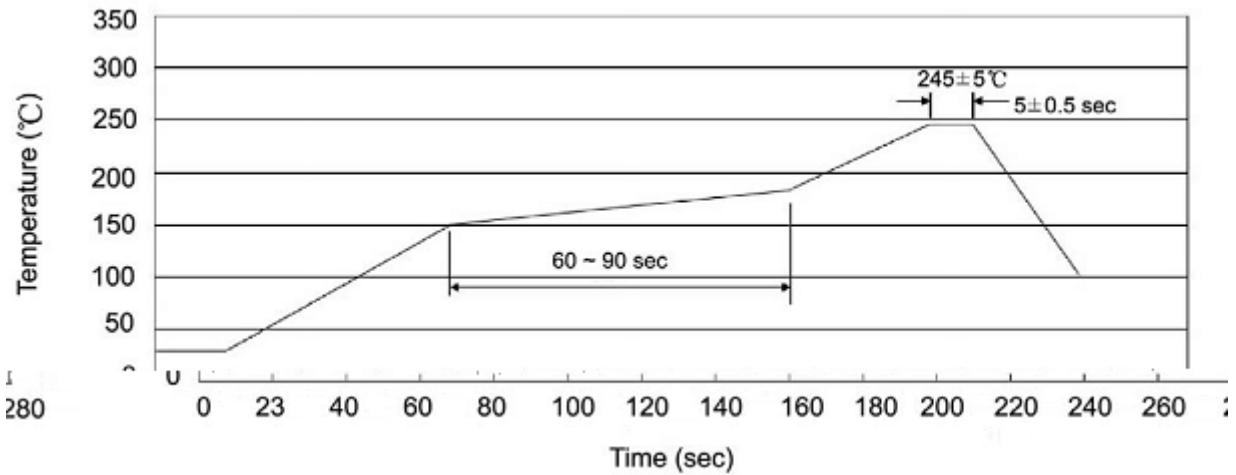

Note:

- 1            25   150            60   90sec;            1.Preheating:25~150 , Time:60~90sec.
- 2            245±5                    5±0.5sec;            2.Peak Temp.:245±5 , Duration:5±0.5sec.
- 3                            2   10 /sec.            3. Cooling Speed: 2~10 /sec.

/ Resistance to Soldering Heat Test Conditions

260±5                    10±1 sec.                    Temp.:260±5                    Time:10±1 sec

/ Packaging SPEC.

/ REEL

| Package Type<br>封装形式 | Units 包装数量 |      |     |     |     | Dimension 包装尺寸 (unit: mm <sup>3</sup> ) |   |   |
|----------------------|------------|------|-----|-----|-----|---|---|---|
|                      | 只 卷盘       | 卷盘 盒 | 只 盒 | 盒 箱 | 只 箱 |   | 盒 | 箱 |
|                      |            |      |     |     |     | "                                       |   |   |

/ TUBE

| Package Type<br>封装形式 | Units 包装数量 |      |     |     |     | Dimension 包装尺寸 (unit: mm <sup>3</sup> ) |   |   |
|----------------------|------------|------|-----|-----|-----|---|---|---|
|                      | 只 套管       | 套管 盒 | 只 盒 | 盒 箱 | 只 箱 | 套管                                      | 盒 | 箱 |
|                      |            |      |     |     |     |   |   |   |

/ Notices