

/ Descriptions

TO-252

/ Features

/ Applications

OR-ing

DC-DC

/ Equivalent Circuit

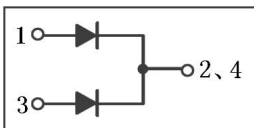

/ Pinning

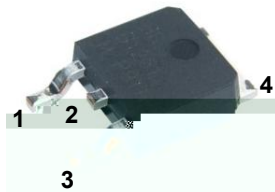

/ h_{FE} Classifications & Marking

/ Absolute Maximum Ratings(Ta=25)

		×	

/ Electrical Characteristics(Ta=25)

- 1.
- 2.

/ Electrical Characteristic Curve

IF - TC

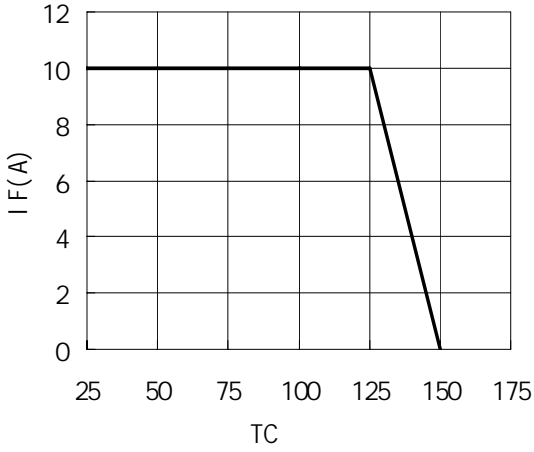

IFSM

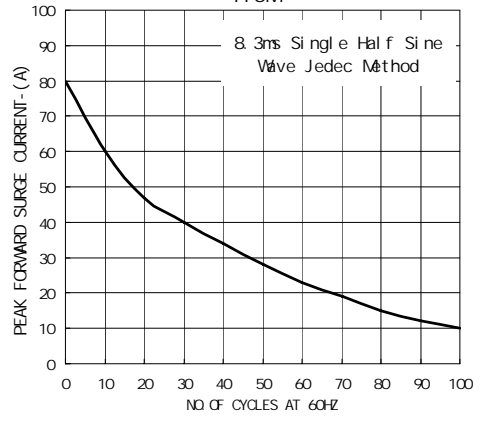

IF - VF

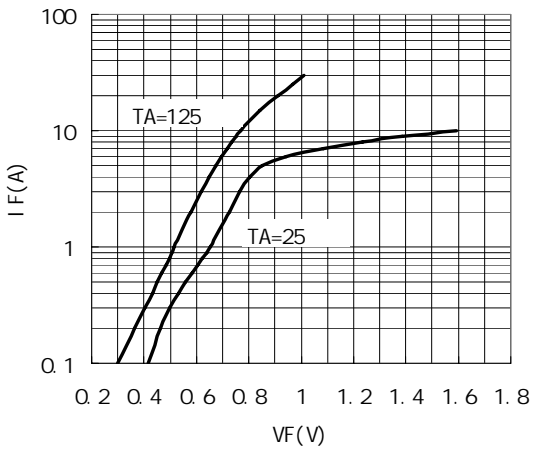

IR - VR

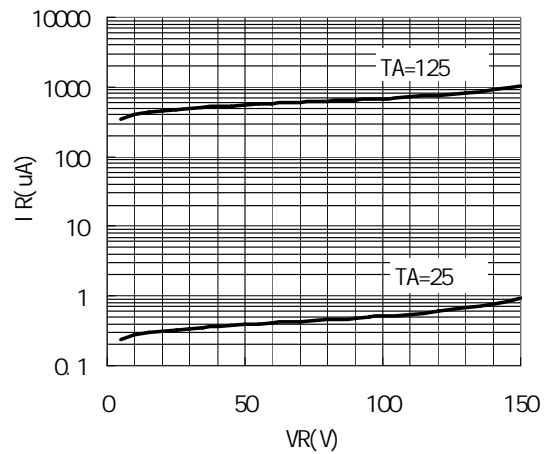

CJ - VR

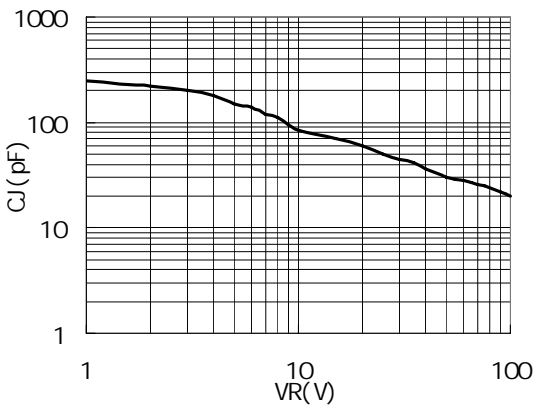

/ Package Dimensions

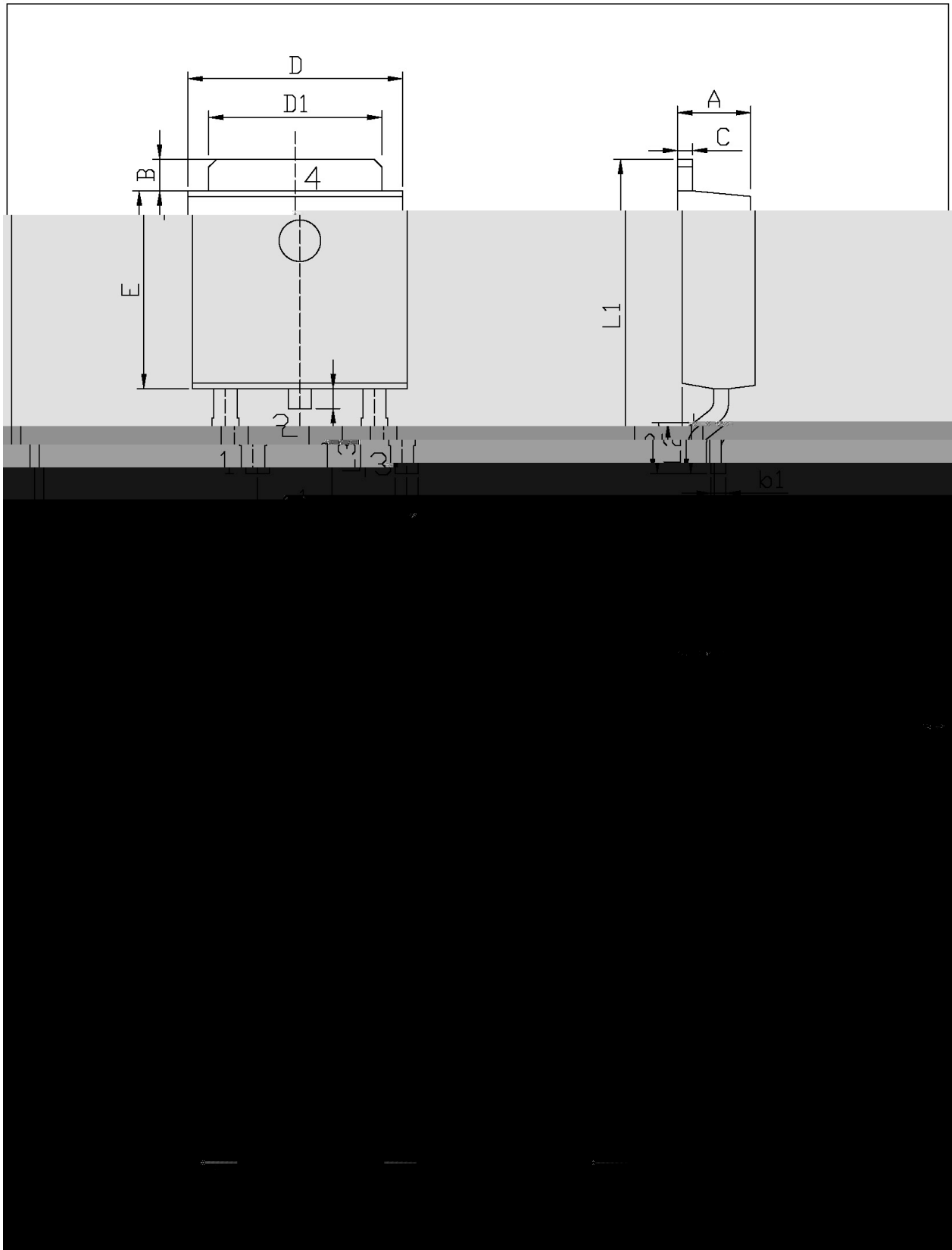

/ Marking Instructions

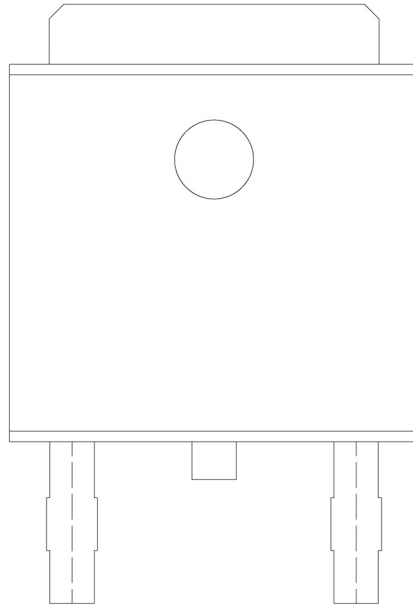

BR

LV10150

CT:

() / Temperature Profile for IR Reflow Soldering(Pb-Free)

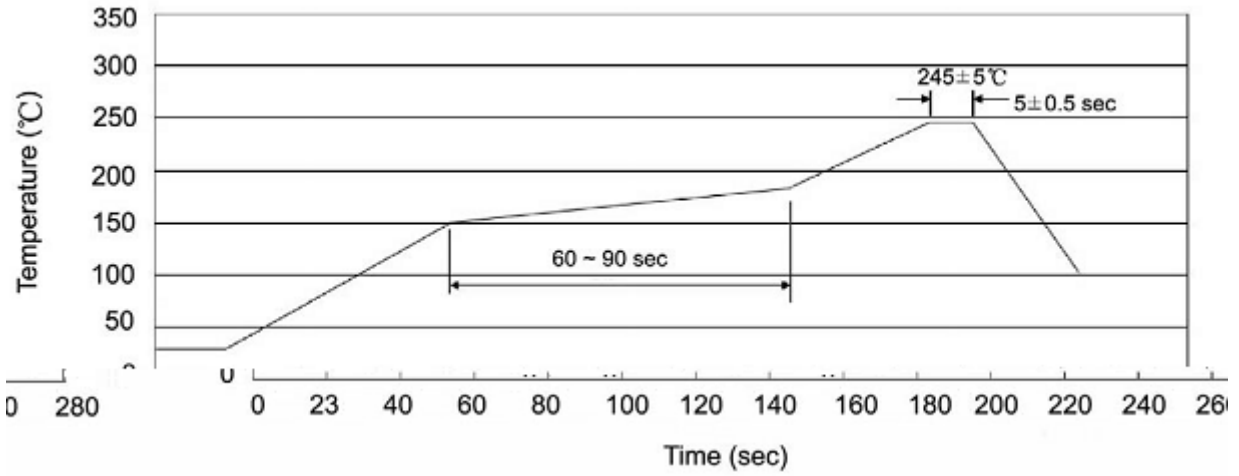

± ± ± ±

/ Resistance to Soldering Heat Test Conditions

± ±

/ Packaging SPEC.

封装形式	包装数量					包装尺寸 :		
	只卷盘	卷盘盒	只盒	盒箱	只箱	盒	箱	

封装形式	包装数量					包装尺寸 :		
	只套管	套管盒	只盒	盒箱	只箱	套管	盒	箱

/ Notices