

/ Descriptions

/ Features

/ Applications

/ Equivalent Circuit

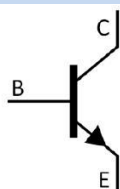

/ Pinning

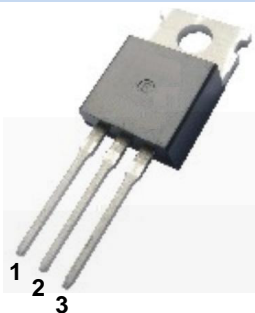

/ h_{FE} Classifications & Marking

MJE15034

/ Electrical Characteristic Curve

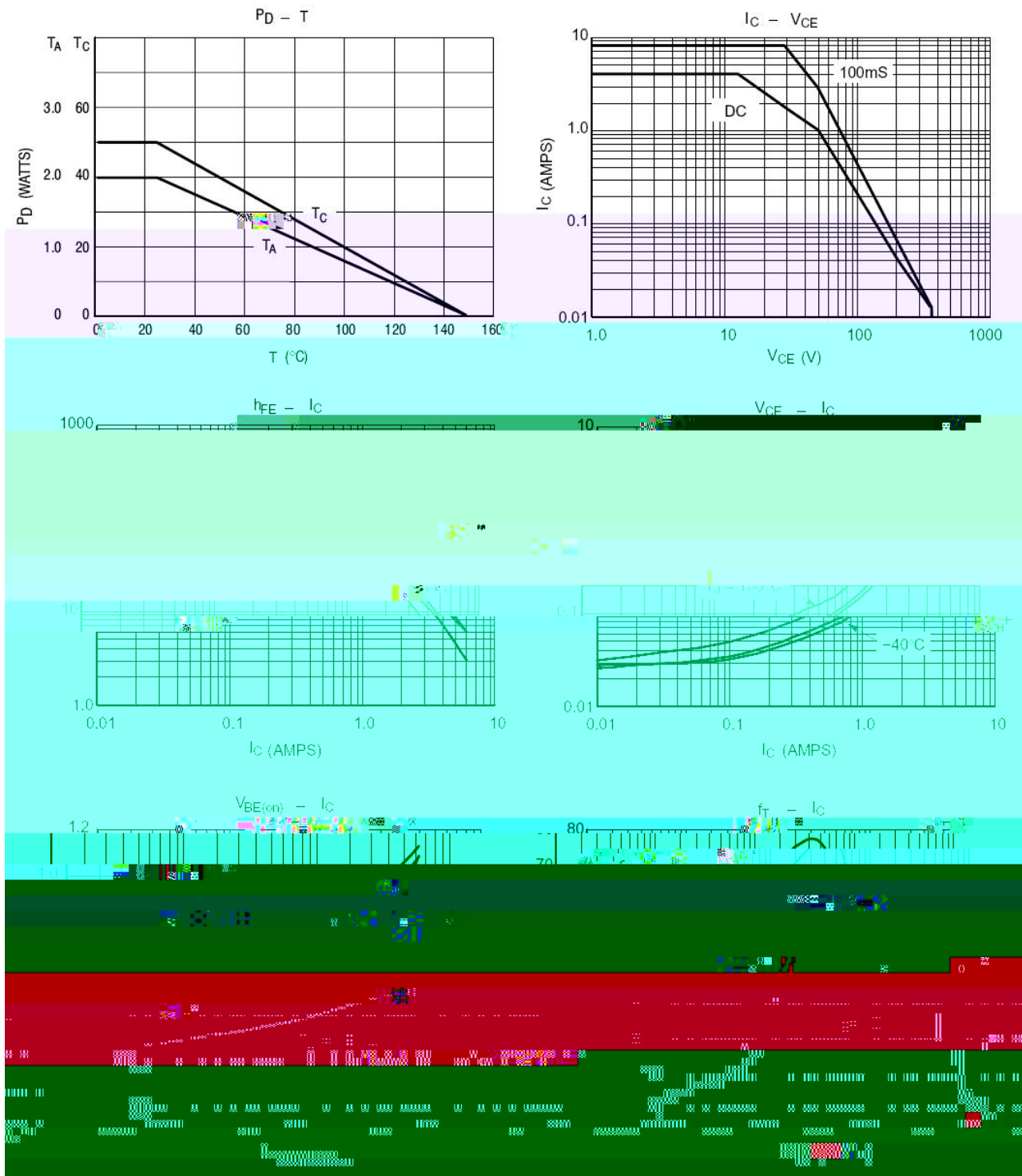

/ Package Dimensions

mm TO-220 单位:

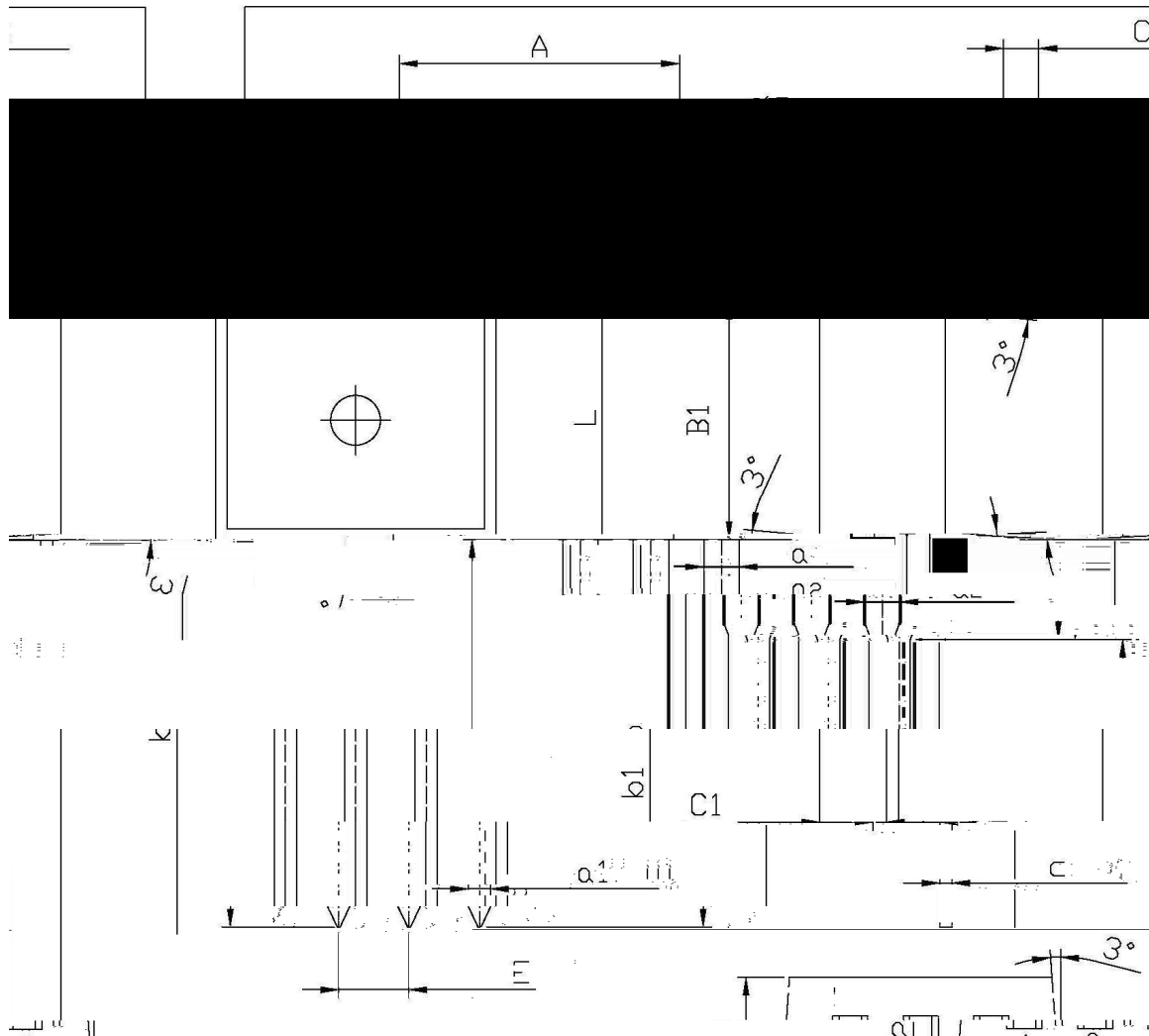

Symbol	Dimensions in milimeters		Symbol	Dimensions in millimeters	
	Min	Max		Min	Max
A	9.8	16.2	C	1.2	1.4
R	3.56	3.64	B	6.3	6.7
B1	9.0	9.4			15.7
	12.6	13.6			2.6
	0.96	1.06			0.9
	2	1.32	C	0.4	0.6
	1.25	1.45			0.2

/ Marking Instructions

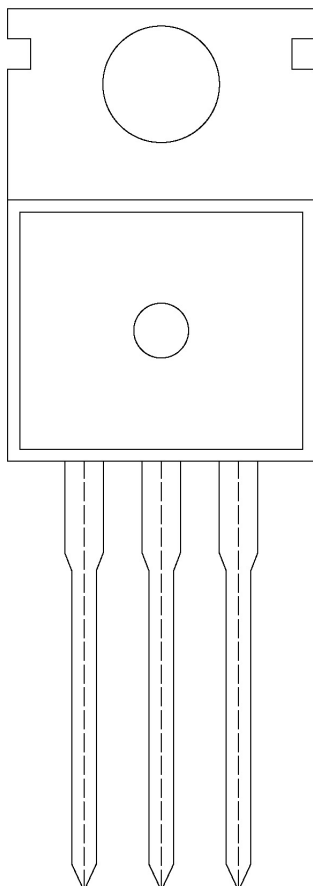

() / Temperature Profile for Dip Soldering(Pb-Free)

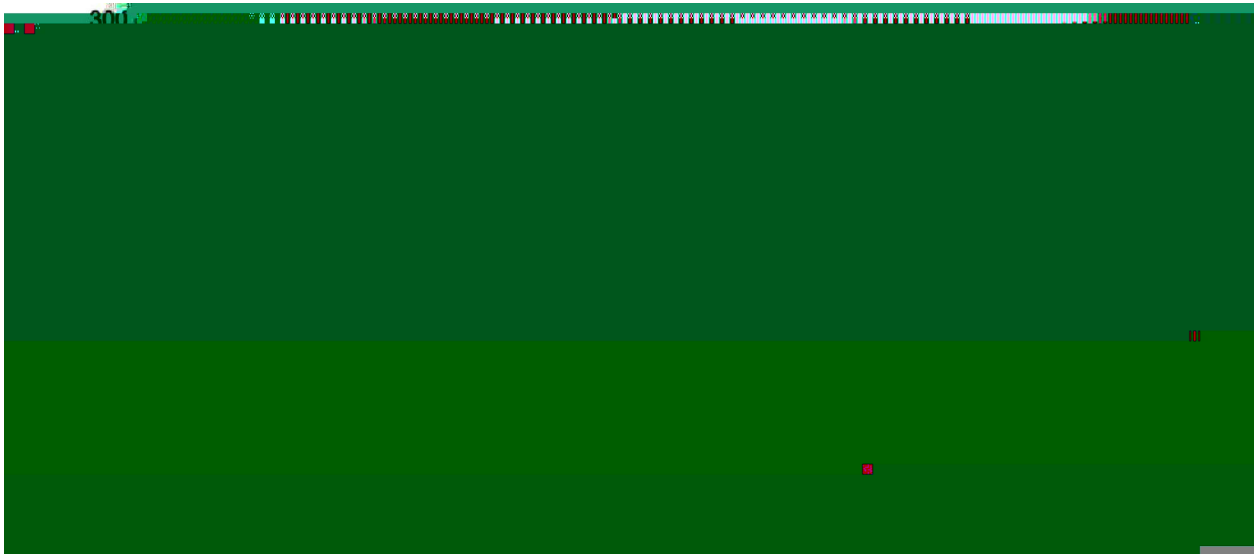

/ Resistance to Soldering Heat Test Conditions

°C

/ Packaging SPEC.

封装形式	包装数量					包装尺寸 :		
	只袋	袋盒	只盒	盒箱	只箱	袋	盒	箱

封装形式	包装数量					包装尺寸 :		
	只套管	套管盒	只盒	盒箱	只箱	套管	盒	箱

/ Notices